

# Marking Pins

## Straight, Stepped, Hollow Edge

Feature: Suitable when confirming dimensions by scribing on work pieces.  
Applicable Bushings: (2) Stepped Type P:1828-1830

### Marking Pins – Straight, Stepped, Hollow Edge



RoHS10

Shape	Material $\text{\textcircled{1}}$	Hardness	(1) Straight		(2) Stepped		(3) Hollow Edge
			Type	Material Code	Type	Material Code	Type
Standard	O1 Tool Steel or Equivalent	58 HRC min.	P $_{0.02}$ KJP Pg6 KJPG	KH	S $_{0.02}$ KJP Sg6 KJPG	KS	—
Acute-Angled Edge	O1 Tool Steel or Equivalent	58 HRC min.	P $_{0.02}$ KJP Pg6 KJPG	KHE	S $_{0.02}$ KJP Sg6 KJPG	KSE	Pg6 KJPGKSC

$\text{\textcircled{1}}$  1. When L dimension is 51 or more, the material for the handle part is 1045 Carbon Steel or Equivalent.

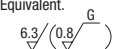

### (1) Straight (Standard) Small Head: D=12-30

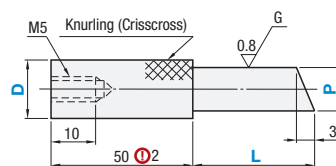

### Large Head: D=12L-20L $\text{\textcircled{3}}$

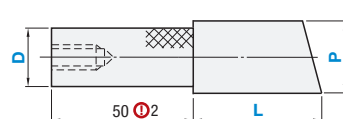

### (1) Straight (Acute-Angled Edge) Small Head: D=12-30

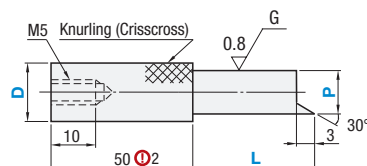

### Large Head: D=12L-20L $\text{\textcircled{3}}$

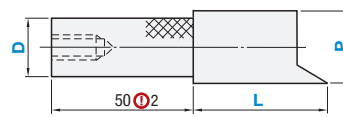

### (2) Stepped (Standard) Small Head: D=12-30

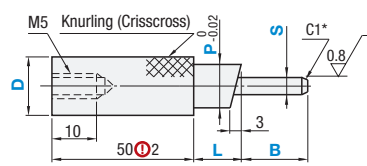

### Large Head: D=12L-20L $\text{\textcircled{3}}$

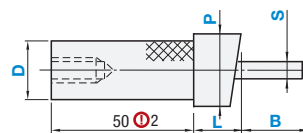

\*When S=2, C is 0.5.

### (2) Stepped (Acute-angled edge) Small Head: D=12-30

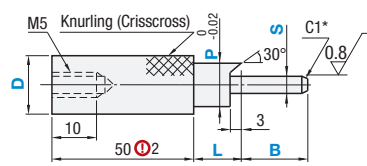

### Large Head: D=12L-20L $\text{\textcircled{3}}$

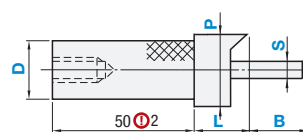

$\text{\textcircled{1}}$  Handles and pins may be joined with an adhesive. Heat or strong force may cause separation.

### (3) Hollow Edge

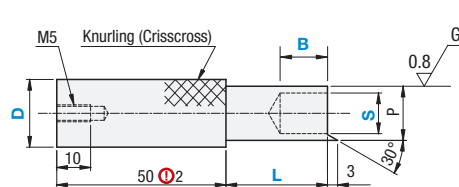

### Application Example

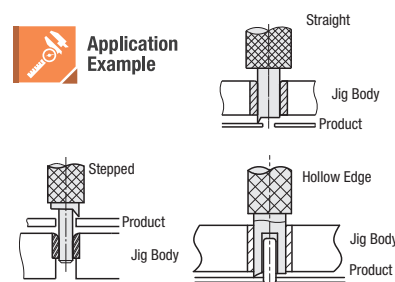

$\text{\textcircled{2}}$  2. For shorter handle length, please refer to the alteration ZC on the right page.  
 $\text{\textcircled{3}}$  3. Dimensions not specified are same as Small Head Type.

# Marking Pins

## Straight, Stepped, Hollow Edge, *continued*

### 1. Straight: Select Type, Material Code & D Dimension

Part Number			P 0.01mm Increment	L 1mm Increment	Available Types					
Type	Material Code	D			Standard		Sharp Pointed Tip			
					KJPKH		KJPGKH		KJPKHE	
P $_{0.02}$ KJP	KH	12	6.00-10.00	10-100	L10-50	L51-100	L10-50	L51-100	L10-50	L51-100
		16	10.01-14.00		•	•	•	•		
		20	14.01-18.00		•	•	•	•		
		25	18.01-20.00		•	•	•	•		
		30	20.01-25.00		•	•	•	•		
		20L	16.00-25.00		•	•	•	•		
Pg6 KJPG	KHE	12L	12.00-20.00	10-50	•	•	•	•	•	•
		16L	16.00-25.00		•	•	•	•		
		20L	20.00-30.00		•	•	•	•		
		20L	20.00-30.00		•	•	•	•		

### 2. Stepped: Select Type, Material Code & D Dimension

Part Number		D	P 0.01 mm Increment	S(P-4~S) 0.1 mm Increment	L 1 mm Increment	B 1 mm Increment
Type	Material Code					
S $_{0.02}$ KJP	KS	12	6.00-10.00	2.0-6.0	5-20	10-20
		16	8.00-14.00	3.0-10.0		
		20	10.00-18.00	3.0-14.0		
		25	15.00-23.00	6.0-19.0		
		30	20.00-28.00	10.0-24.0		
		12L	12.00-20.00	3.0-16.0		
Sg6 KJPG	KSE	16L	16.00-25.00	6.0-21.0	10-40	10-40
		20L	20.00-30.00	10.0-26.0		

### 3. Hollow Edge

Part Number		D	S 0.1 mm Increment	L*1 1 mm Increment	B 1 mm Increment	P*2
Type	D					
KJPGKSC	12	2.0-4.0	5-40	3-15	10	
	16	3.0-6.0				
	20	6.0-10.0				
	25	8.0-14.0				
	30	12.0-19.0				

\*1. When L dimension of Hollow Edge Type is short, it may interfere with M5 screw pilot hole.

\*2. When Hollow Edge Type needs P dimension specified, please use alteration PC.



### Part Number Example

Type	Shape	Material Code	D	P	S	L	B
(1) Straight Standard	KJP	KH	20	- P16.00	- L100		
(1) Straight Acute-Angled Edge	KJP	KHE	16	- P10.10	- L12		
(2) Stepped Standard Large Head	KJP	KS	16L	- P20.20	- S6.8	- L10	- B10
(3) Hollow Edge, Acute-Angled Edge	KJPGKSC		16	- S6.0	- L10	- B10	



### Part Number Alterations

Part Number	P	S	L	B	(CH / KH / PKC...etc.)
KJPKH16	- P10.1	- L12	-	-	CH
KJPGKSC20	- S8.0	- L25	- B20	-	PC14
KJPKHE12	- P7.02	- L80	-	-	ZC30
KJPKSE16L	- P20.00	- S12.1	- L15	- B20	PKC

Alterations	Code	Spec.
Chain Attachment	CH	Retaining chain (length 600 mm) is attached to the gauge body. $\text{\textcircled{1}}$ For chains only, refer to P:1845
Engraving of P Dimension	KH	Machines flats on knurled head and engraves P dimension. $\text{\textcircled{1}}$ Engraved on the reverse side when combined with KF.
Additional Surface Treatment (Black Oxide)	STC	Adds Black Oxide Surface Treatment.
P Dimension	PC	Changes the P Dimension. $\text{\textcircled{1}}$ Applicable to Hollow Edge Type only. $\text{\textcircled{2}}$ Specify the tap size so that 3mm or more wall thickness remains (PC $\geq$ S+6). Ordering Code: PC13

Alterations	Code	Spec.
P Dimension Tolerance	PKC	Changes P dimension tolerance to g6. $\text{\textcircled{1}}$ Available for Stepped Type only.
Tip	SST	Makes acute-angle edge of Scribing Pin triangular to make it sharper. $\text{\textcircled{1}}$ Available for Acute-Angle Type only.
Engraving of the Specified Characters	KF	Engraves alphabet or number. Ordering Code: KF-MISUMI0034 Printable Characters: alphabet, number, . (period) $\text{\textcircled{1}}$ Engraves on the reverse side when combined with KH.
Handle Length	ZC	Changes handle length from 50 to 30 or 40.