



Belt Tensioners - Screw Type

■Features: This is the tensioner for the roller and idler. It can be easily installed and adjusted by spanner or wrench.



RoHS10

Components	Bearing Block	Spacer Block	Chassis	Adjusting Bolt	Stopper Bolt
Material	1018 Carbon Steel	1018 Carbon Steel	SPH	1045 Carbon Steel	304 Stainless Steel
Surface Treatment	Electroless Nickel Plating				

Components	T-Nut	Dowel Pin	Hex Socket Flat Head Cap Screw	Metal Washer	Hexagon Socket Set Screw
Material	1018 Carbon Steel	52100 Bearing Steel	304 Stainless Steel	1045 Carbon Steel	304 Stainless Steel
Surface Treatment	Trivalent Bright Chromate Plating	-	-	Electroless Nickel Plating	-

•RONAJ10, 12, 15

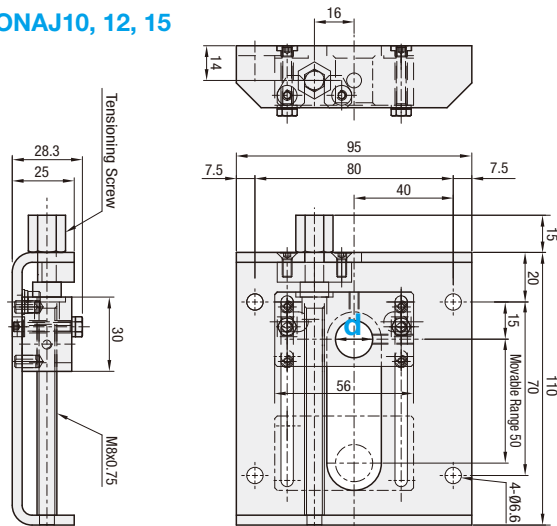
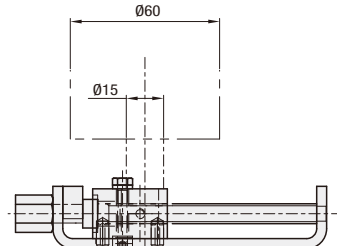

Diagram of mounting state of Ø60 Roller



Recommended Rollers

▶ P1-1142 RORSPA60-15

Part Number	Unit Price
TYPE	d
RONAJ	10
	12
	15

For orders larger than indicated quantity, please check with WOS.

•RONAJ20, 25, 30

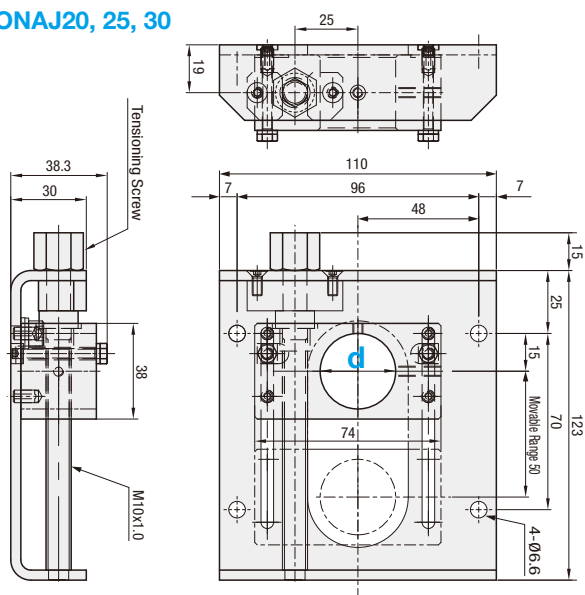
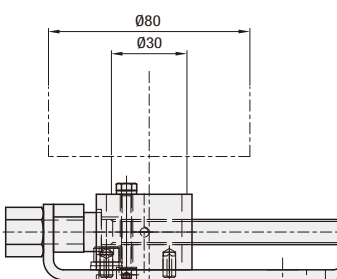

Diagram of mounting state of Ø80 Roller



Recommended Rollers

▶ P1-1142 ROSPA80-30

Part Number	Unit Price
TYPE	d
RONAJ	20
	25
	30

For orders larger than indicated quantity, please check with WOS.

How to Mount

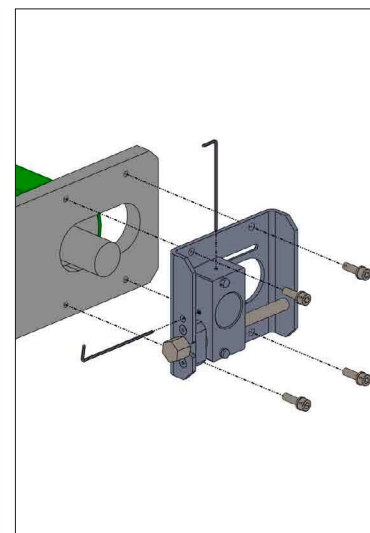

1. Mount the main body on the chassis. Mount the Roller (Idler).

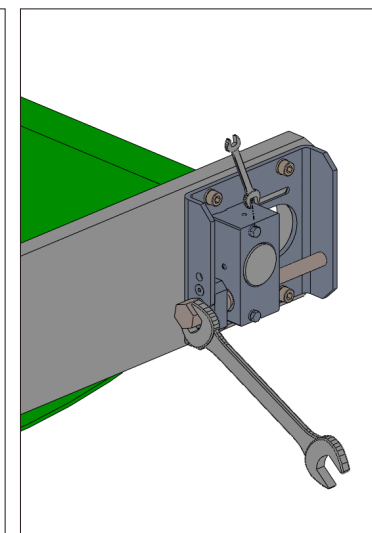

2. Loosen the fixing nut, and adjust the tensioner with Hex Head Stud.

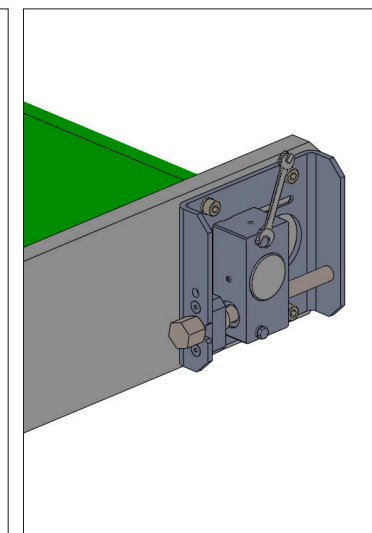

3. Tighten the fixing nut at the desired position, thereby fixing the position.



Example

• Thin Sheet Tensioner

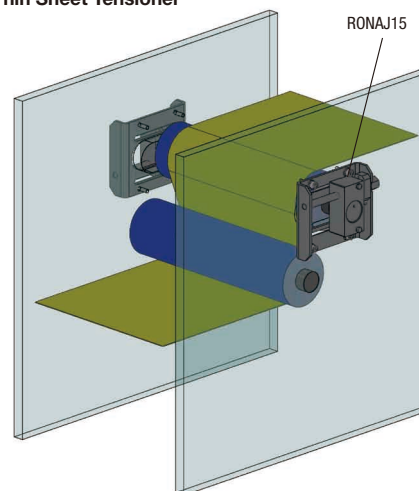

• Flat Belt Tensioner

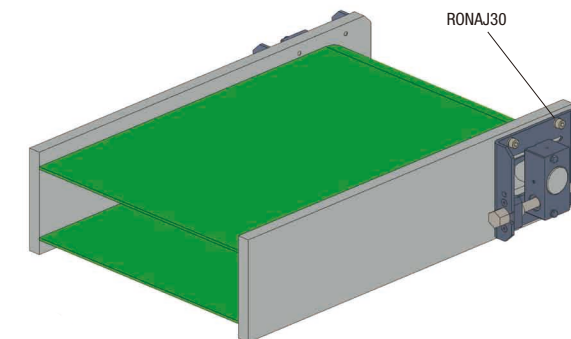

Ordering Example
Part Number
RONAJ 30



Days to Ship

Configure Online