

Dowel Pins / Dowel Removal Jigs

Undersized - Selectable Length

Dowel Pin One End Tapped (h7)



RoHS10

Type	Material	Hardness
MSTH	S2100 Bearing Steel	45~50HRC
MSTHS	440C Stainless Steel	45~50HRC
MSTSS	304 Stainless Steel	-

MSTH MSTHS MSTSS

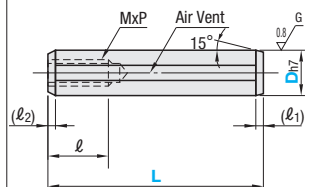

- When D=5 or 6 and L=10, the pilot hole for tapping may go through.
- *l=6 only when D=6 and L=10
- With an air vent.

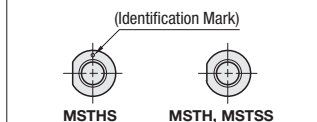

All air vents are identical in depth.
Applicable Products: MSTH, MSTHS, MSTSS

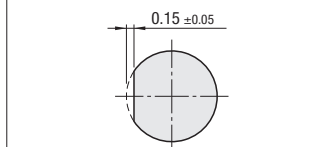

Ordering Example: Part Number - L
MSTHS6 - 10

l1 / l2 dimension may become larger than the value shown in the catalog due to polishing process.

l1	l2	MxP	l	Dh7	Part Number Type	D	L	Unit Price	Volume Discount Rate	
1.5	0.3	3x0.5	6	0	MSTH	5	10 15 20 25 30	1-19 pc(s)	20~49	
		4x0.7	8	-0.012			6			10 15 20 25 30 35 40
2.0	0.5	5x0.8	8	0	MSTH	8	15 20 25 30 35 40 45	1-19 pc(s)	50~299	
		6x1.0	10	-0.015			10			15 20 25 30 35 40 45 50 60 70 80 100 120
		8x1.25	15	0			12			20 30 40 50 60 70 80 100 120
3.0	1.5	8x1.25	15	0	MSTH	16	40 50 60 70 80 100 120 150	1-19 pc(s)	300~500	
				-0.018						

l1	l2	MxP	l	Dh7	Part Number Type	D	L	Unit Price	Volume Discount Rate
1.5	0.3	3x0.5	6	0	MSTHS	5	10 15 20	1-19 pc(s)	20~29
		4x0.7	8	-0.012			6		
2.0	0.5	5x0.8	8	0	MSTHS	8	15 20 25 30 35 40	1-19 pc(s)	30~49
		6x1.0	10	-0.015			10		

l1	l2	MxP	l	Dh7	Part Number Type	D	L	Unit Price	Volume Discount Rate
1.5	0.3	3x0.5	6	0	MSTSS	5	10 15 20	1-19 pc(s)	20~29
		4x0.7	8	-0.012			6		
2.0	0.5	5x0.8	8	0	MSTSS	8	15 20 25 30 35 40	1-19 pc(s)	30~49
		6x1.0	10	-0.015			10		

Dowel Removal Jigs



KNHN ((1) Main Body + (2) Holder Cap 1 pc.)
KNHN-M ((2) only)

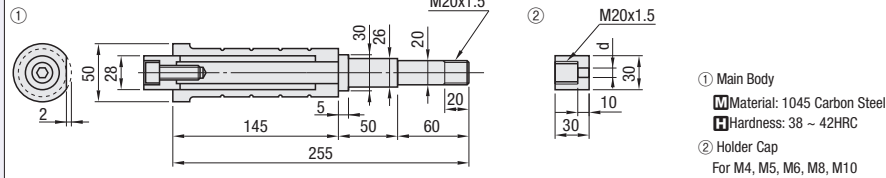

Part Number	Unit Price	Volume Discount Rate
KNHN (1)+(2)	1-9 pc(s)	10~20

d	Part Number	Unit Price	Volume Discount Rate
4.2	KNHN-M (2) only	1-9 pc(s)	10~20
5.2		4	
6.3		5	
8.5		6	
10.5		10	

How to Use

- Insert the hex socket head cap screw (CB) into the holder cap.
- Attach (2) holder cap to the tip of main body.
- Attach screw tip onto the dowel pin by turning the knurled portion of shaft.
- Slide the hammer to remove dowel pin.

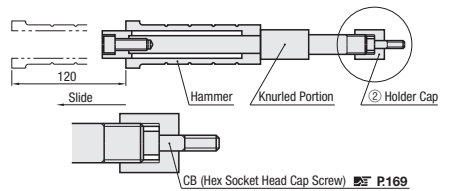

Dual-Fit Dowel Pins

p6-h7, p6-g6 / Hollow, Tapped

Dual-Fit Dowel Pins



RoHS10

l1 dimension may become larger than the value shown in the catalog due to polishing process.

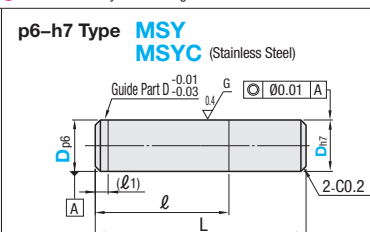

l1 dimension may become larger than the value shown in the catalog due to polishing process.

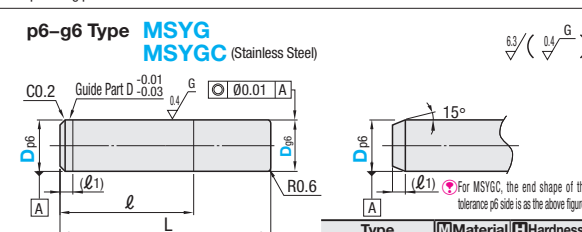

Part Number Type	D	D Tolerance	No.	L	l	l1	MSY Unit Price	MSYGC Unit Price
3	3	+0.012 / +0.006	0 / -0.010	8	3	1	803	
							805	
							1003	
							1005	
							10	
							12	
							15	
							20	
							25	
							30	
							35	
							4	4
805								
1005								
10								
12								
15								
20								
25								
30								
35								
40								
5	5	+0.020 / +0.012	0 / -0.012	8	5	1.5		
							805	
							1005	
							10	
							12	
							15	
							20	
							25	
							30	
							35	
							40	
							6	6
805								
1005								
10								
12								
15								
20								
25								
30								
35								
40								
8	8	+0.024 / +0.015	0 / -0.015	8	8	2		
							805	
							1005	
							10	
							12	
							15	
							20	
							25	
							30	
							35	
							40	
							10	10
805								
1005								
10								
12								
15								
20								
25								
30								
35								
40								

Part Number Type	D	D Tolerance	No.	L	l	l1	MSY Unit Price	MSYGC Unit Price
3	3	+0.012 / +0.006	-0.002 / -0.008	8	3	1	803	
							805	
							1003	
							1005	
							10	
							12	
							15	
							20	
							25	
							30	
							35	
							4	4
805								
1005								
10								
12								
15								
20								
25								
30								
35								
40								
5	5	+0.020 / +0.012	-0.004 / -0.012	8	5	1.5		
							805	
							1005	
							10	
							12	
							15	
							20	
							25	
							30	
							35	
							40	
							6	6
805								
1005								
10								
12								
15								
20								
25								
30								
35								
40								
8	8	+0.024 / +0.015	-0.005 / -0.014	8	8	2		
							805	
							1005	
							10	
							12	
							15	
							20	
							25	
							30	
							35	
							40	
							10	10
805								
1005								
10								
12								
15								
20								
25								
30								
35								
40								

Dual-Fit Dowel Pins Hollow, Tapped



RoHS10

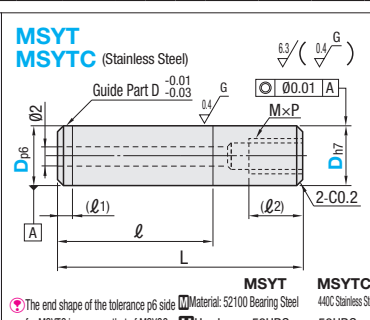

l1 / l2 dimension may become larger than the value shown in the catalog due to polishing process.

Part Number Type	D	D Tolerance	No.	MxP	L	l	l1	l2	MSYT Unit Price	MSYTC Unit Price
6	6	+0.020 / +0.012	0 / -0.012	4x0.7	15	1.5	5	5	1205	
									12	
									1208	
									1508	
									15	
									1512	
									18	
									20	
									25	
									30	
									35	
									8	8
12										
1208										
1508										
15										
1512										
18										
20										
25										
30										
35										
10	10	+0.028 / +0.018	0 / -0.018	6x1.0	30	2	10	10		
									12	
									1208	
									1508	
									15	
									1512	
									18	
									20	
									25	
									30	
									35	

Part Number Type	D	D Tolerance	No.	MxP	L	l	l1	l2	MSYT Unit Price	MSYTC Unit Price
6	6	+0.020 / +0.012	0 / -0.012	4x0.7	15	1.5	5	5	1205	
									12	
									1208	
									1508	
									15	
									1512	
									18	
									20	
									25	
									30	
									35	
									8	8
12										
1208										
1508										
15										
1512										
18										
20										
25										
30										
35										
10	10	+0.028 / +0.018	0 / -0.018	6x1.0	30	2	10	10		
									12	
									1208	
									1508	
									15	
									1512	
									18	
									20	
									25	
									30	
									35	

