

Lead Screw

One End Stepped / One End Double Stepped

Lead screws that are easy to combine with MISUMI Support Units.



Type				Material	Surface Treatment
Right-Hand Screw	Left-Hand Screw	Right and Left-Hand Screw	Precision Right and Left-Hand Screw		
MTSRK	MTSLK	MTSWKA/B	MTSYKA/B	1045 Carbon Steel	Black Oxide
MTSBRK	MTSBLK	MTSBWKA/B	MTSBYKA/B		
RMTSRK	RMTSLK	RMTSWKA/B	-	303 Stainless Steel	Low Temperature Black Chrome Plating
MTSTRK	MTSTLK	-	-		

Single Pitch Error... ±0.02mm · Accumulated Pitch Error... ±0.15/300mm
 Type A or B are available for Right and Left-hand Screw and Precision Right and Left Hand Screw.

Right-Hand Screw / Left-Hand Screw

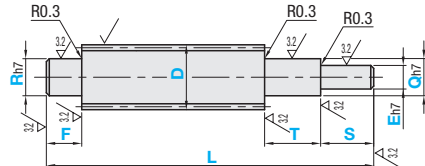

Right and Left-Hand Screw

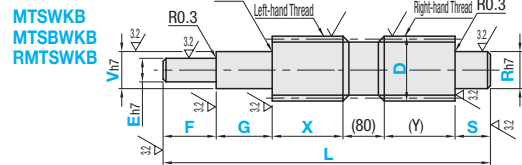
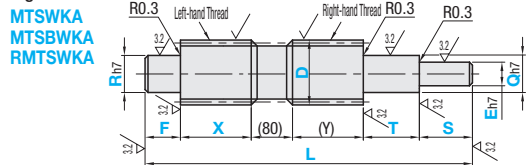

Incomplete threaded portion near the center (80mm) is not useable.

Precision Right and Left-Hand Screw

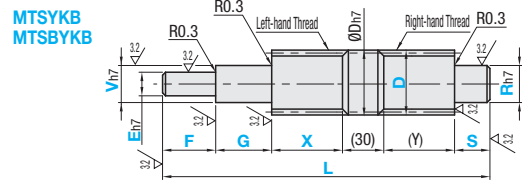
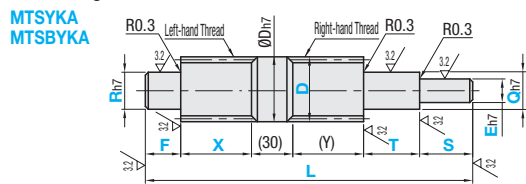

ØDh7-30mm part includes incomplete thread portion by about 1.5 pitches at both ends (in total about 3 pitches).

Part Number	D	1mm Increment		V, Q, R	E	Right and Left-Hand Screw, Precision Right and Left-Hand Screw		D	Pitch P
		L	F, G, T, S			1mm Increment	X 1mm Increment		
(Right-Hand Screw) MTSRK MTSBRK RMTSRK MTSTRK	12 14 16 18	80-1000 100-1200		7 8 9 8 9 10 9 10 12	Q/2≤E<Q-1 V/2≤E<V-1	When D=12, 14 50≤X<460<485>-F-G (Y)=L-80<30>-F-G-S-T-X (Y)≤500-S-T-40<15> When D=16 ~ 50 50≤X<560<585>-F-G (Y)=L-80<30>-F-G-S-T-X (Y)≤600-S-T-40<15> Dimensions in <> are for Precision Right and Left-Hand Screw.	12	2	
(Left-Hand Screw) MTSLK MTSBLK RMTSLK MTSTLK	20 22 25 28	150-1200	2≤F≤E, R×7 2≤G≤V×7 2≤S≤E, R×7 2≤T≤Q×7	10 12 14 15 10 12 14 15 12 14 15 16 17 14 15 16 17 20			20 22 25 28	3 4 5	
(Right and Left-Hand Screw) MTSWKA/B MTSBWKA/B RMTSWKA/B	32 36	200-1200	When Q, V, R, and E≤9 F, G, T, S will be 5x or less of Q, V, R, E.	14 15 16 17 20 25 17 20 25			32 36	6	
(Precision Right and Left-Hand Screw) MTSYKA/B MTSBYKA/B	40 50			20 25 30 25 30 35 40			40 50	8	

For Precision Right and Left-Hand Screw, D dimension 14, 16, 20, 25, 28 and 32 are available. When combined with the position indicators, Q and V standard dimensions will be 8-20. P:701, 702
 D dimension 22, 36, 40 and 50 are not applicable to Stainless Steel. D dimension. D dimension 25, 28 and 32 are applicable to Right-Hand Screw only.

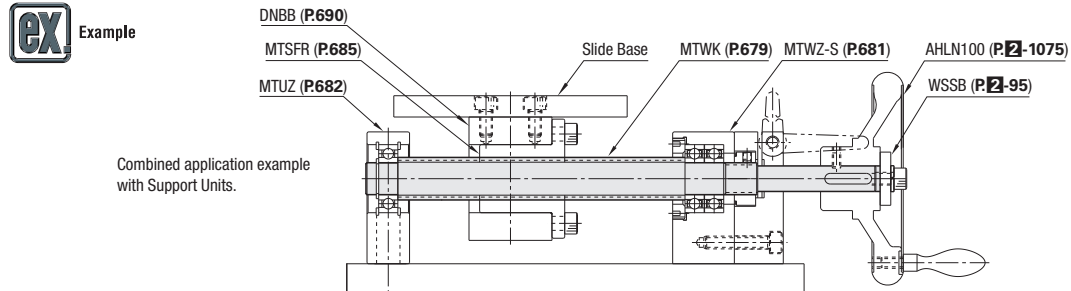

Combined application example with Support Units.

Ordering Example: Part Number - L - F - R - T - Q - S - E - X
 MTSRK16 - 456 - F37 - R10 - T20 - Q12 - S10 - E9 - X150
 MTSWKA16 - 456 - F37 - R10 - T20 - Q12 - S10 - E9 - X150
 Part Number - L - F - E - G - V - S - R - X
 MTSBWK20 - 582 - F10 - E10 - G15 - V12 - S25 - R15 - X200

Days to Ship [Configure Online](#)

Price [Configure Online](#)

Right-Hand Screw, Left-Hand Screw

Part Number	Type	Unit Price					
		D	Min. L-200	L201-400	L401-600	L601-800	L801-1000
MTSRK MTSBRK MTSLK MTSBLK	12						
	14						
	16						
	18						
	20						
	22						
	25						
	28						
	32						
	50						

Right and Left-Hand Screw

Part Number	Type	Unit Price					
		D	Min. L-200	L201-400	L401-600	L601-800	L801-1000
MTSWKA/B MTSBWKA/B	12						
	14						
	16						
	18						
	20						
	22						
	25						
	28						
	32						
	50						

Right-Hand Screw, Left-Hand Screw, Stainless Steel

Part Number	Type	Unit Price					
		D	Min. L-200	L201-400	L401-600	L601-800	L801-1000
MTSTRK MTSTLK	14						
	16						
	18						
	20						
	25						
	32						

Precision Right and Left-Hand Screw

Part Number	Type	Unit Price					
		D	Min. L-200	L201-400	L401-600	L601-800	L801-1000
MTSYKA/B MTSBYKA/B	14						
	16						
	20						
	25						
	28						
	32						

Low Temperature Black Chrome Plated Products

Part Number	Type	Unit Price				
		D	Min. L-200	L201-400	L401-600	L601-800
RMTSRK RMTSLK RMTSWKA/B	12					
	14					
	16					
	18					
	20					
	22					
	25					
	28					
	32					

Alterations: Part Number - L - F - R - T - Q - S - E - (AR, SE, MR, etc.)
 MTSRK16 - 456 - F37 - R10 - T20 - Q12 - S10 - E9 - MR4

Alterations	Code	Flat Machining	Retaining Ring Groove	Wrench Flats	Coarse Tapping	Threaded	Square Chamfering	Keyway
		FE (E part) FR (R part) AR (R part) AE (E part) SE (E part) SR (R part) MR (R part) ME (E part) BQ (Q part) BV (V part) BR (R part) ZE (E part) ZR (R part) KQ (Q part) KV (V part) KE (E part) KR (R part)	FE, FR, FW, FY=0.5mm Increment FE=Applied on E part FR=Applied on R part Ordering Code: FRS-FW10-FY1 Applicable to either E or R When E (R)≤25, FY=1.0 When E (R)≥26, FY=2.0 3≤FW≤20	AR, AE=0.1mm Increment AR(AE)=S(F)+T(G)-m-n Machining Limit Ordering Code: AE13.3 AR=Applied on R part AE=Applied on E part R, E Tolerance m ±0.14 n ±0.14 p ±0.14 q ±0.14 r ±0.14 s ±0.14 t ±0.14 u ±0.14 v ±0.14 w ±0.14 x ±0.14 y ±0.14 z ±0.14	SE, SW, SY=1mm Increment SE=Applied on E part SR=Applied on R part Ordering Code: SE3-SW10-SY7 When E(R)<15, then SW≥E(R)-2 When E(R)≥15, then SW≥E(R)-3 When 30≤E(R), then SW≥E(R)-5 3≤SY≤20	MR=Applied on R part ME=Applied on E part Ordering Code: MR24 R, E ME / MR (Selection Range) 5, 6 3 7, 8 3, 4 9, 10 3, 4, 5 11, 12 3, 4, 5, 6 13-15 3, 4, 5, 6, 8 16-24 3, 4, 5, 6, 8, 10 25-30 3, 4, 5, 6, 8, 10, 12, 16 31-39 3, 4, 5, 6, 8, 10, 12, 16, 20 40 3, 4, 5, 6, 8, 10, 12, 16, 20, 24, 30 Not applicable when R, E=4.	BQ, BV, BR≤Mx3 BQ, BV, BR≤Pitchx3 BQ, BV, BR≤F,S,T,G-Pitchx3 Ordering Code: BR20 BQ=Applied on Q part BV=Applied on V part BR=Applied on R part Q, V, R MxPitch 8 M8x1.0 10 M10x1.0 12 M12x1.0 14 M14x1.0 15 M15x1.0 17 M17x1.0 20 M20x1.0 25 M25x1.5 30 M30x1.5 35 M35x1.5 40 M40x1.5 Cannot be applied when Q, V, R = 7, 9, 16.	ZE=Applied on E part ZR=Applied on R part ZE=Applied on E part ZR=Applied on R part ZE=Specified, ZR=W ZE=ZE, ZR=R W 1mm Increment Q, V, R MxPitch 6-10 5-8 11-14 8-10 15-19 10-14 20-25 14-20 26-30 19-24 31-35 22-28 36-40 26-30 When Q(KV), KE, KR=0, keyway R will be eliminated on the shaft end side.

When wrench flats, square chamfering and keyway alterations are combined each other, their orientations will be random.