

Connector Type	Shape Specification Type	Outline Image Drawing (Unit: mm)	Cable Type	Number of Cores	Specified Length (m)	Standard Unit Price		
						Basic Unit Price	A Cable	D Cable
PRC0332 TAJIMI ELECTRICS CO., LTD. Connector OP.893	JSY (Female for Relay / Y Terminal) With Pin No. Insertion Mark Tube		A D E	2	0.2			
				3				
				4				
				5				
				7				
	JPT (Male for Relay / Loose Wires) With Pin No. Insertion Mark Tube			2	50			
				3				
				4				
				5				
				7				
	JST (Female for Relay / Loose Wires) With Pin No. Insertion Mark Tube			2	(Can be specified by 0.1m increments)			
				3				
				4				
				5				
				7				

Cable Specification

A Cable		D Cable		E Cable	
	OP.1171		OP.1177		OP.1469
Section Area	Number of Cores	Section Area	Number of Cores	Section Area	Number of Cores
0.5 mm ² (AWG20)	2, 3, 4, 5, 7	0.5 mm ² (AWG20)	2, 3, 4, 5, 7	0.5 mm ² (AWG20)	2, 3, 4, 5, 7

Properties Radar Chart	Properties Radar Chart	Properties Radar Chart
<ul style="list-style-type: none"> Compliant to Environmental Resistant Material Carrier-tested Cable Flexible Heat-resistant Oil Resistance Noise Resistance Twisting Resistance Vibration-resistant 	<ul style="list-style-type: none"> Compliant to Environmental Resistant Material Carrier-tested Cable Flexible Heat-resistant Oil Resistance Noise Resistance Twisting Resistance Vibration-resistant 	<ul style="list-style-type: none"> Compliant to Environmental Resistant Material Carrier-tested Cable Flexible Heat-resistant Oil Resistance Noise Resistance Twisting Resistance Vibration-resistant

Main Specifications	Main Specifications	Main Specifications
Sheath Color: Gray Standard Acquired: PSE Law (With Exceptions) Rated Voltage: 300 V Operating Temperature Range: -10 ~ 60 °C Flame Retardance: -- Bending Radius: Fixed Parts 6 (mm), Moving Parts -- * This is a recommended value, not a guaranteed value [* Please note] Rated voltage when using with 0.3 or 0.5 mm ² will be less than 100 V.	Sheath Color: Navy Standard Acquired: PSE Law Rated Voltage: 300 V Operating Temperature Range: 0 ~ 75 °C Flame Retardance: -- Bending Radius: Fixed Parts 6 (mm), Moving Parts -- * This is a recommended value, not a guaranteed value	Sheath Color: Navy Standard Acquired: ULAWM2517 / c-UL / CE Compliant Rated Voltage: 300 / CE: 300 / 500 V Operating Temperature Range: -20 ~ 105 °C Flame Retardance: WW-1 Bending Radius: Fixed Parts 6 (mm), Moving Parts 6 (mm) * This is a recommended value, not a guaranteed value

Electrical Properties

Number of Cores	Connector		A Cable			D Cable			E Cable		
	Rated Current (A or less)	Rated Voltage (V or less)	Section Area	Rated Voltage	Allowable Current A (30°C)	Section Area	Rated Voltage	Allowable Current A (30°C)	Section Area	Rated Voltage	Allowable Current A (30°C)
2	10	600	0.5mm ² (AWG20)	300V	6	0.5mm ² (AWG20)	300V	4	AWG20 (0.5mm ²)	300V	9
3											840
4	360	4									6
5	400	3									5
7	350	2									4

* The values are reference values, not guaranteed values.

Combination Method

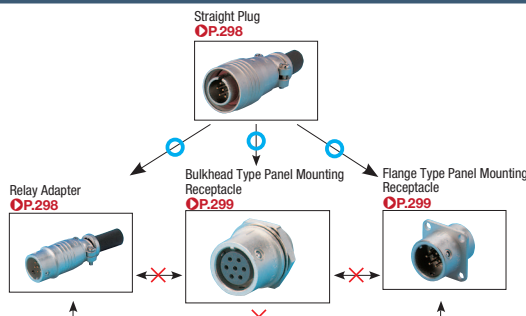

* When coupling, combine the male and female parts according to the ○ relationship.

- MS Connector Included Cable
- MS Connector Included Cable (Drip-proof)
- JL04 Connector Included Cable
- JL05 Connector Included Cable
- NGS Connector Included Cable
- NJC Connector Included Cable
- NJW Connector Included Cable
- NR Connector Included Cable
- NRW Connector Included Cable
- NET Connector Included Cable
- PRC04 Connector Included Cable
- PRC03 Connector Included Cable
- PRC05 Connector Included Cable
- R03 Connector Included Cable
- R04 Connector Included Cable
- PLT Connector Included Cable
- HR10A Connector Included Cable
- XS2 Connector Included Cable
- DIN / Mini DIN Connector Included Cable