

COMPACT FLYING CAM UNITS FOR HEAVY LOAD PIERCE

— MGFVA · MEVAN —

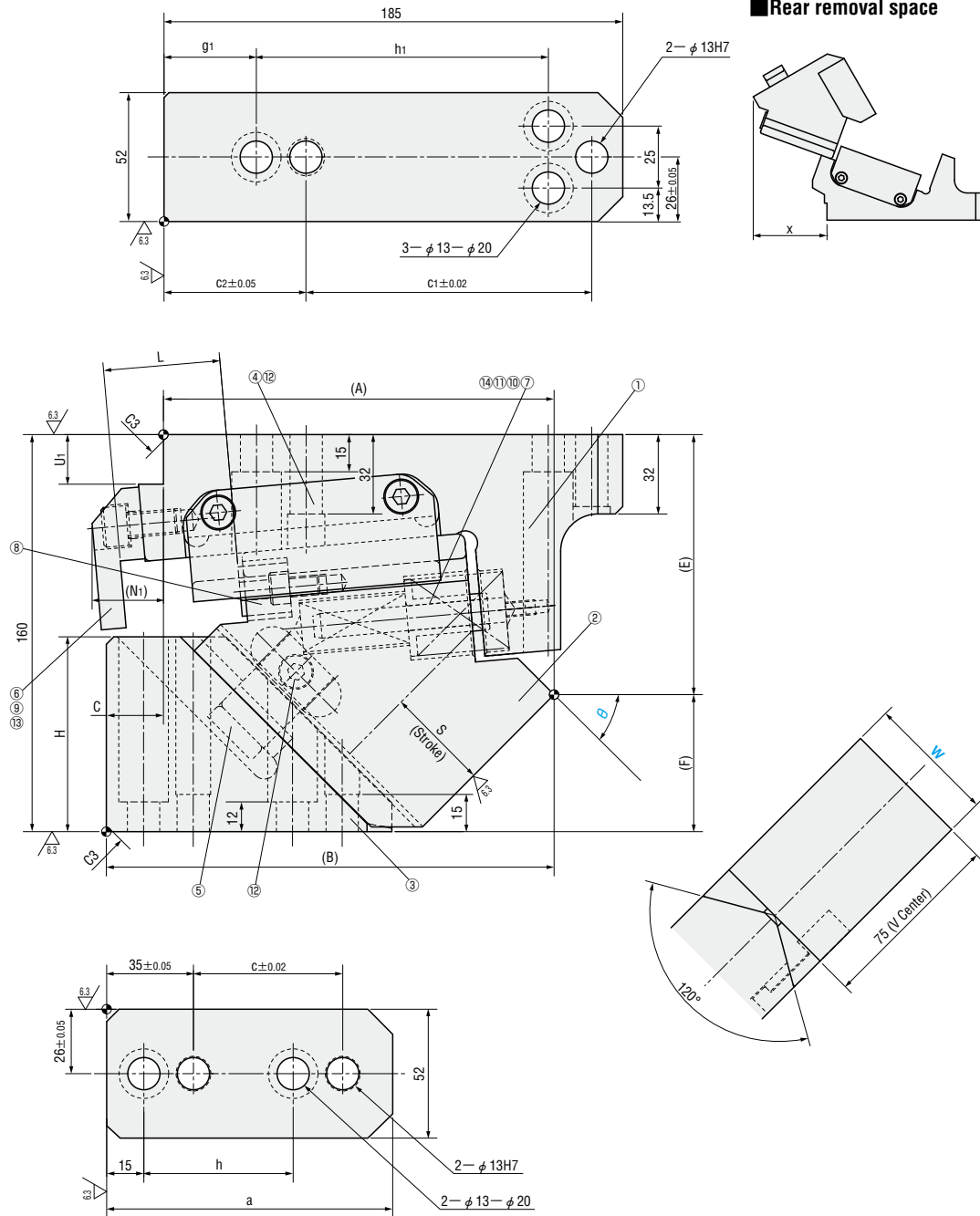

— With automatic alignment — **MGFVA52 ($\theta=25-60$)**
 — Without automatic alignment — **MEVAN52 ($\theta=25-60$)**
 (Economy type)



■ Rear removal space

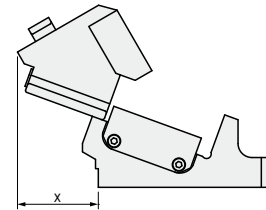

■ Components table P.1226

W	θ	A	B	C	E	F	H	L	N ₁	U ₁	a	c	c ₁	c ₂	g ₁	h	h ₁	x
52	25	168.92	181.92	13	81.63	78.37	55	47	28.68	20	140	75	120	52.5	32.5	75	122.5	78
	30	166.59	184.09	17.5	85.55	74.45	63		30.31									87
	35	163.72	193.72	30	92.52	67.48	68		30.99									94
	40	163.80	173.80	10	98.47	61.53	70		27.24		115	60	115	57.5	37.5	60	117.5	96
	45	157.35	180.35	23	104.78	55.22	78.5		28.57									103
	50	159.37	174.37	15	103.89	56.11			20									99
55	152.53	182.53	30	111.09	48.91	93	37	15	10	90	40	67.5	47.5	40	107.5	100		
60	142.95	157.95	15	113.10	46.90		27	15								105	67.5	47.5

Slide Stroke S	Working force KN (tonf)		Spring load N (kgf)			Total weight kg	Catalog No.	W	θ	
	Standard working force	Max. working force	Preload	5mm before bottom dead center	Max. load					
47.0	29.4 (3.0)	58.8 (6.0)	30 (3.1)	2000(203.9)	3111 (317.2)	8.8	—With automatic alignment— MGFVA	52	25	
51.0				2089(213.0)		8.6			30	
55.4				2178(222.0)		8.8			40	
60.4				2244(228.8)		8.9			45	
66.2				2333(237.9)		9.1			50	
73.1				2400(244.7)		8.8			55	
64.5				61(6.2)		2466(251.5)			8.9	60
54.0				92(9.3)		2555(260.6)			8.5	—Without automatic alignment— MEVAN (Economy type)

Order

Days to Ship **Quotation**

Price **Quotation**

Alterations (N12 · SC · WC)

Alterations	Code	Spec.
2-φ12H7	N12	Change dowel hole diameter φ13H7 ⇒ φ12H7
SC	SC	Move forward mounting surface 1 ≤ SC ≤ 50 1mm increment
WC	WC	Change the width of mounting surface W=52 ⇒ W=80 or 120 Only 80 or 120 can be specified.