



BRACKETS FOR SENSORS

MISFEED SENSOR UNITS

— CONTACT TYPE —



RoHS



RoHS

Catalog No.

SNB	①	②
SNB-D	○	○

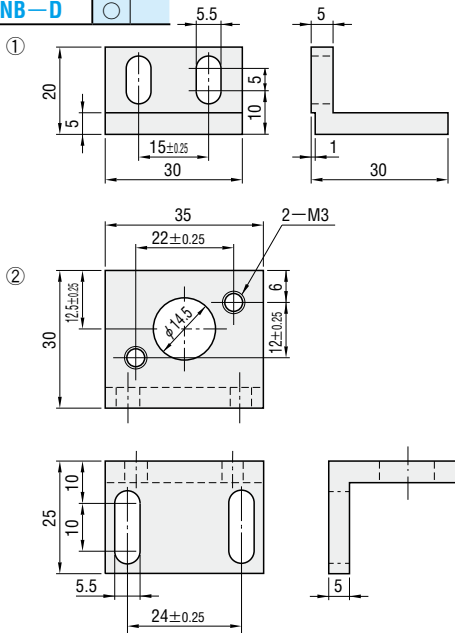

M SS400
 A 4 pcs. of CB5-20
 For SNB-D, 2 pcs. of CB5-20 are attached.

Catalog No.

SNBA	①	②
SNBA-D	○	○

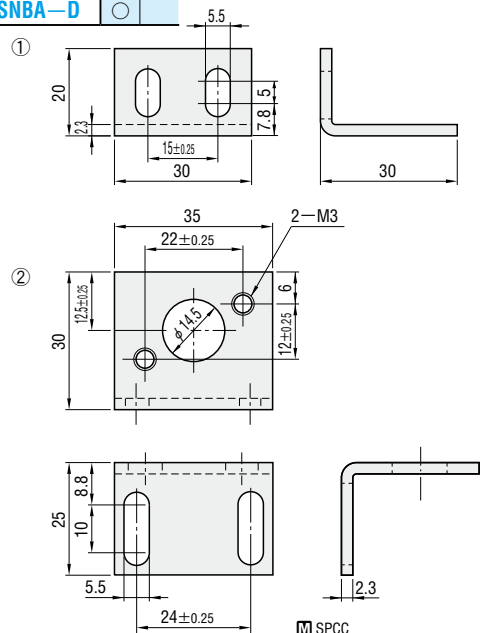

M SPCC
 S Bright chromate
 A 4 pcs. of CB5-20
 For SNBA-D, 2 pcs. of CB5-20 are attached.

Order Catalog No. **SNB**

Days to Ship **Quotation**

Price

Catalog No.	Volume discount unit price			
	1~4 sets	5~9	10~19	20~50
SNB				
SNB-D				
SNBA				
SNBA-D				

Quotation

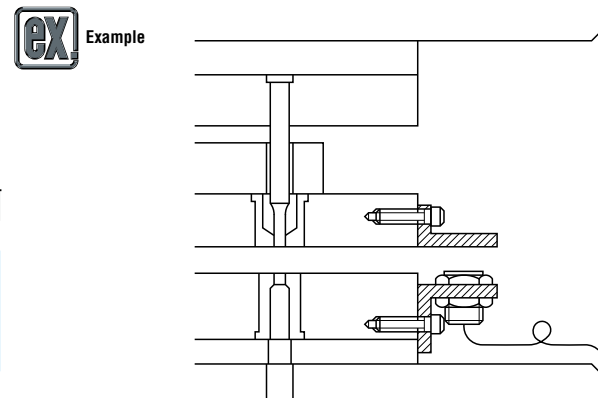

Use these brackets for mounting sensors RS833H (made by RIKEN KEIKI Co.,LTD.) or PH114 (made by KEYENCE Co.).

RoHS

OKJS

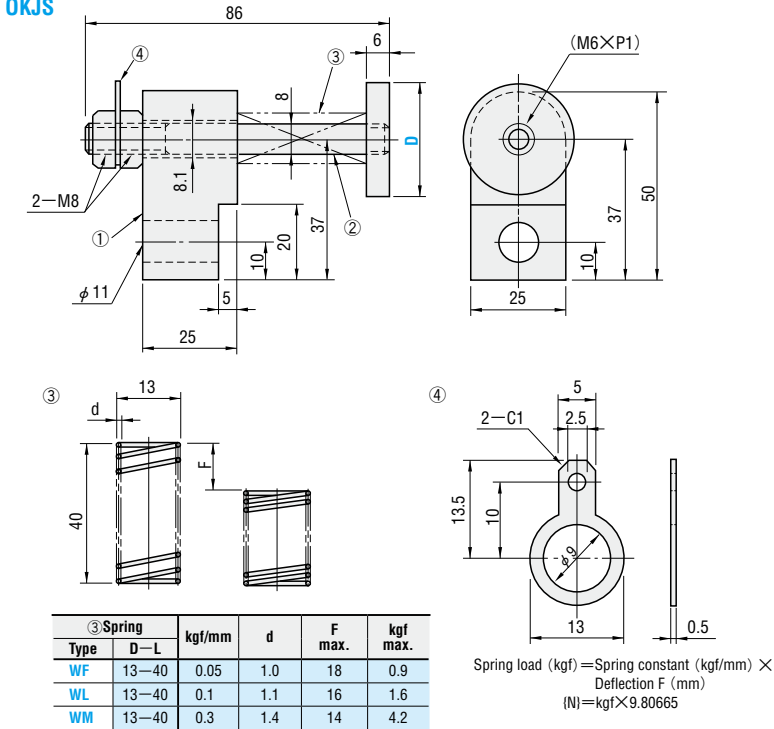

Catalog No.	Type	D	③ Spring	Base unit price				Volume discount unit price			
				1~4 pieces	5~9	10~19	20~50	1~4 pieces	5~9	10~19	20~50
OKJS		16	WF WL WM	Quotation							
		20									
		30									

Order Catalog No. **OKJS 16** — **③ Spring** **WL**
Days to Ship **Quotation**

EX Example

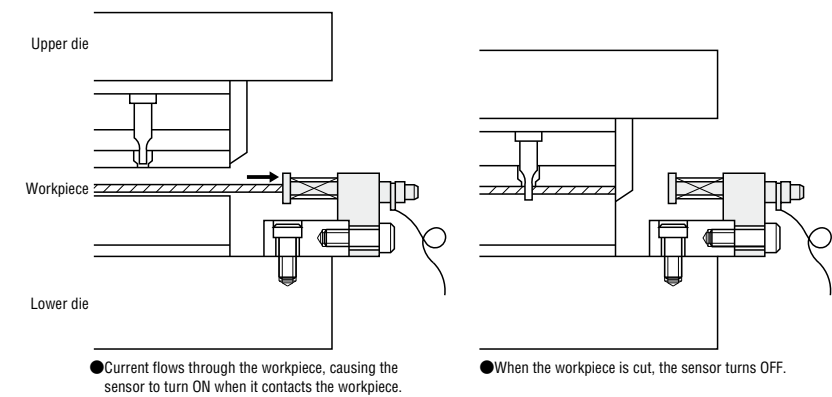

COMPONENTS FOR MISFEED SENSORS