

High Speed Steel
SKH51 equivalent

For Large Size
Caulking type
P · W_{-0.02}

RECTANGULAR EJECTOR PINS FOR LARGE MOLD

— CAULKING · FREE DESIGNATION TYPE —

RoHS

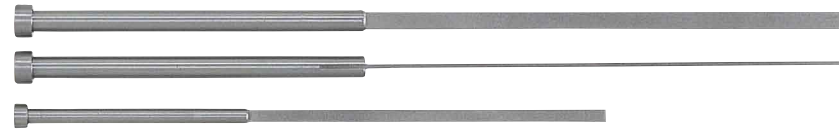

Part Number	Head Thickness	L	P · W
ERHK-F (Free designation type)	6 · 8mm (JIS)	+0.1 0 (L ≥ 630.1 → L + 0.5)	0 -0.02

(*)ℓmax.		
P	W	ℓmax.
4.0~8.0	1.0~2.5	280
8.1~15.0	1.0~2.5	380
	4.0~6.0	380

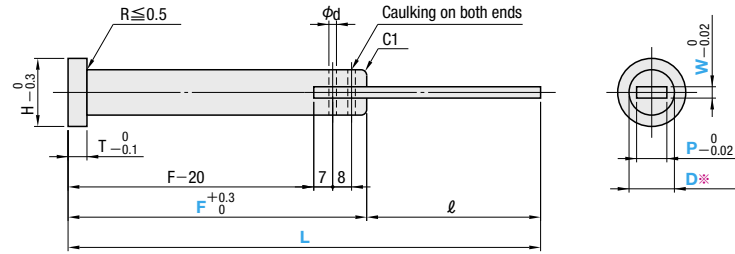

D	Tolerance
6~12	-0.01 -0.02
16	-0.01 -0.03

Range of guaranteed shaft diameter precision (D) (Details P.1301)

- SKH51 equivalent (Flat bar)
- SK4 (Shaft)
- 58~60HRC (Flat bar)
- SK4 is not annealed.

The flat bar is inserted into the shank and caulked; though grinding is performed to eliminate any trace of caulking.

H	T	d	Part Number Type	D	0.1mm increments L	P	W Selection	F 10 mm increments
10	6	*2	ERHK-F	6	80.0~680.0	4.0~6.0	1.0	*60~400
11				7			1.2	
13				8			1.5	
15	8	*4		10		6.0~10.0	2.0	
17				12		8.0~12.0	3.0	
21				16		10.0~15.0	4.0	

ℓmax. before designating. *When 4 ≤ P < 6, d=2, when 6 ≤ P < 8, d=3, and when P ≥ 8, d=4.

Order Part Number - L - P - W - F
ERHK-F12 - 300.0 - P11.5 - W1.2 - F160

Days to Ship Quotation

Price Quotation

Alterations Part Number - L - P - W - F(FC) - (AKC · AWC...etc.)
ERHK-F12 - 300.0 - P11.5 - W1.2 - FC165 - AKC80

Alteration details P.195

Alterations	Code	Spec.	1Code
	AKC	AKC=1° increments 0 ≤ AKC < 360	Quotation
	AWC	AWC=1° increments 0 ≤ AWC < 360	
	ARC	ARC=1° increments 0 ≤ ARC < 360	
	ADC	ADC=1° increments 0 ≤ ADC < 360	
	KGA	KGA=1° increments 0 < KGA < 360	

Alterations	Code	Spec.	1Code
	KGD	KGD=1° increments 0 < KGD < 360	Quotation
	HC	HC=0.1mm increments D+1 ≤ HC < H	
	TC	TC=0.1mm increments T/2 ≤ TC < T T-TC ≤ Lmax. - L Dimension L remains unchanged. Dimensions F become shorter by (T-TC). (Dimension F remains unchanged when FC code is combined.)	
	FC	FC=1mm increments 40 < FC < Fmax.	

High Speed Steel
SKH51 equivalent

RECTANGULAR EJECTOR BLANKS FOR LARGE MOLD

Non JIS material definition is listed on P.1351 - 1352

RoHS



Part Number	P · W
ERKB	0 -0.02

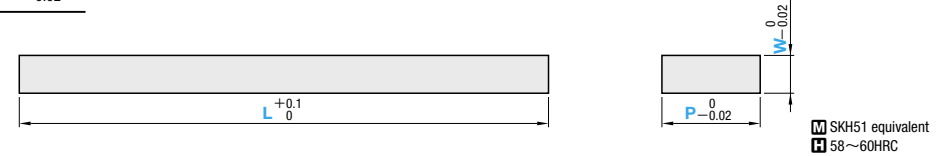

- SKH51 equivalent
- 58~60HRC

Part Number	L 10mm increments	P	W			
			1.0	1.2	1.5	2.0
ERKB	30~300	6 8	1.0	1.2	1.5	2.0
	30~400	10 12 15	1.0	1.2	1.5	2.0

Order Part Number - L - P - W
ERKB - 300 - P10 - W1.2

Days to Ship Quotation

Price Quotation

Alterations Part Number - L(LC) - P - W
ERKB - LC293.4 - P10 - W1.2

Alteration	Code	Spec.	1Code
	LC	LC=0.1mm increments 30 < LC < Lmax.	Quotation

Rectangular Ejector Pins

High Speed Steel SKH51 equivalent

For Large Size Caulking type P · W_{-0.02}