

Support Pins with Pilot

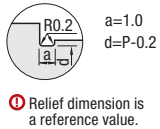

Type	Shape Code	Material Code	Material	Surface Treatment	Hardness
SHP (Round)	C (Threaded)	B	(1) 1045 Carbon Steel or Equivalent	Black Oxide	—
		R	(2) 1045 Carbon Steel or Equivalent	Hard Chrome Plating	Plating Hardness: 750 HV min.
SDP (Diamond)	A (Tapped)	HB	(3) 1045 Carbon Steel or Equivalent	Black Oxide	Treated Hardness: 45–50 HRC min.
	B (Pilot)	HR	(4) 1045 Carbon Steel or Equivalent	Hard Chrome Plating	Treated Hardness: 45–50 HRC min. Plating Hardness: 750 HV min.
		SU	(5) 304 Stainless Steel	—	—
	C	(6) 440C or 420 Stainless Steel	—	Treated Hardness: 50–55 HRC min.	

Ⓢ Some combinations are not available. Refer to the price list to select the available combination.

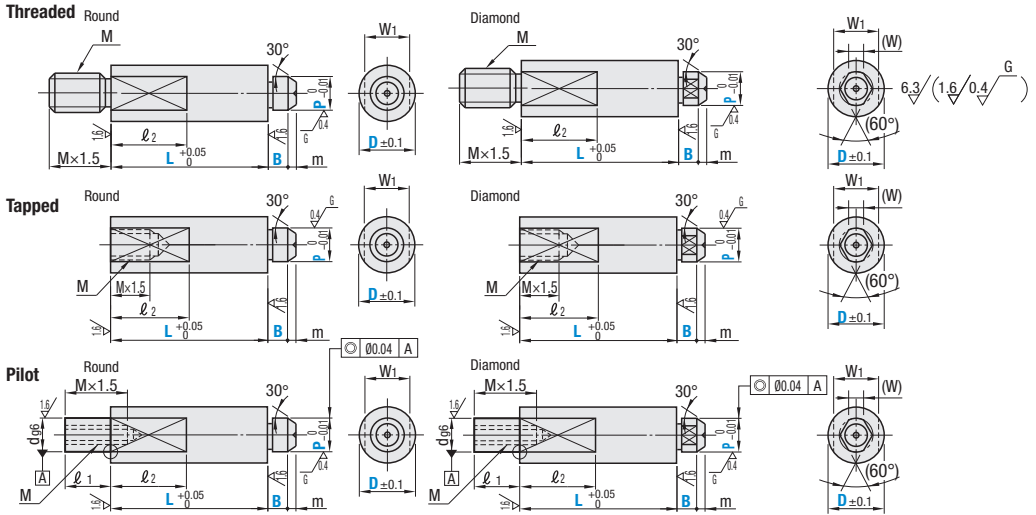

Type	Part Number		D	L 0.01mm Increment	P 0.01mm Increment	B Selection	m	d	M (Coarse)	L ₁	W ₁	(W)	L ₂
	Shape Code	Material Code											
SHP (Round)	C (Threaded)	B	6	10.00–50.00	3.00–4.00	2	1	—	M3	—	5	1.0	8
		R	8										
SDP (Diamond)	B (Pilot)	HB	10	20.00–80.00	3.00–6.00	3	2	6	M5	6	8	1.5	10
		HR	12										
		SU	15										
		C	20										
			25										
			25										

Ⓢ Pilot Type is not available for D6, 8.

Ⓢ Note the strength of under-head part. P.1542

* The tightening torque (ref. value) for hardened products is strength class 8.8. (See technical data on MISUMI 2019 catalog P.4015). Not applicable when using locking agents or spring washers.



Part Number Example

Part Number	-	L	-	P	-	B
SDPBSU20	-	L50.00	-	P8.00	-	B3
SHPBB10	-	L20.01	-	P4.05	-	B5



Application Example

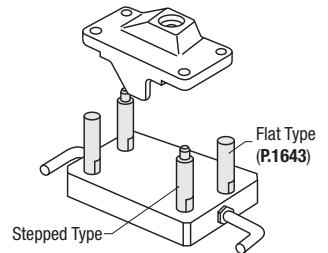

Round Shape

D	Available Types Threaded Type						Available Types Tapped Type						Available Types Pilot Type					
	(1) SHPCB	(2) SHPCR	(3) SHPCHB	(4) SHPCHR	(5) SHPCSU	(6) SHPCC	(1) SHPAB	(2) SHPAR	(3) SHPAHB	(4) SHPAHR	(5) SHPASU	(6) SHPAC	(1) SHPBB	(2) SHPBR	(3) SHPBHB	(4) SHPBHR	(5) SHPBSU	(6) SHPBC
6	•	•	—	—	•	•	•	•	•	•	•	•	•	•	•	•	•	•
8	•	•	—	—	•	•	•	•	•	•	•	•	•	•	•	•	•	•
10	•	•	—	—	•	•	•	•	•	•	•	•	•	•	•	•	•	•
12	•	•	—	—	•	•	•	•	•	•	•	•	•	•	•	•	•	•
15	•	•	—	—	•	•	•	•	•	•	•	•	•	•	•	•	•	•
20	•	•	—	—	•	•	•	•	•	•	•	•	•	•	•	•	•	•
25	•	•	—	—	•	•	•	•	•	•	•	•	•	•	•	•	•	•

Diamond Shape

D	Available Types Threaded Type						Available Types Tapped Type						Available Types Pilot Type					
	(1) SDPCB	(2) SDPCR	(3) SDPCHB	(4) SDPCHR	(5) SDPCSU	(6) SDPCC	(1) SDPAB	(2) SDPAR	(3) SDPAHB	(4) SDPAHR	(5) SDPASU	(6) SDPAC	(1) SDPBB	(2) SDPBR	(3) SDPBHB	(4) SDPBHR	(5) SDPBSU	(6) SDPBC
6	—	—	•	—	•	•	•	•	•	•	•	•	•	•	•	•	•	•
8	—	—	•	—	•	•	•	•	•	•	•	•	•	•	•	•	•	•
10	—	—	•	—	•	•	•	•	•	•	•	•	•	•	•	•	•	•
12	—	—	•	—	•	•	•	•	•	•	•	•	•	•	•	•	•	•
15	—	—	•	—	•	•	•	•	•	•	•	•	•	•	•	•	•	•
20	—	—	•	—	•	•	•	•	•	•	•	•	•	•	•	•	•	•
25	—	—	•	—	•	•	•	•	•	•	•	•	•	•	•	•	•	•

Check out misumiusa.com for the most current pricing and lead time.

Support Pins

Configurable / with Pilot

Support Pins – Configurable / wth Pilot



RoHS 10

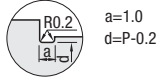

Relief dimension is a reference value.

D	H	M (Coarse)	M ₁ (Coarse)	m
3	6	M3	—	1
4	6	M4	—	1
5	8	M5	—	1
6	8	M6	M3	2
8	11	M8	M4	2
10	13	M10	M5	3
12	15	M12	M5	3

Type						Material	Surface Treatment	Hardness
Straight			Shouldered					
Standard	Tapped	Threaded	Standard	Tapped	Threaded			
SHFJ	SHFU	SHFN	—	SHXU	SHXN	01 Tool Steel or Equivalent	—	Treated Hardness: 60–63 HRC min.
GSHFJ	GSHFU	GSHFN	GSHXJ	—	—		Hard Chrome Plating	Hardness: 50–55 HRC min. Plating Hardness 750 HV min.
SSHFJ	SSHFU	SSHFN	—	—	SSHXN	304 Stainless Steel	—	—
CSHFJ	CSHFU	CSHFN	CSHXJ	CSHXU	CSHXN	440C or 420 Stainless Steel	—	Treated Hardness: 50–55 HRC min.

Straight Type Standard

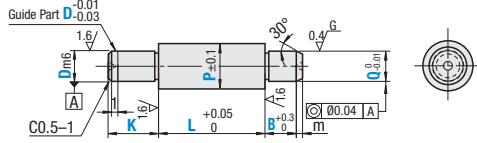

Tapped

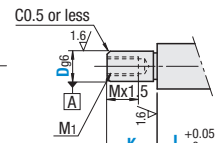

Threaded

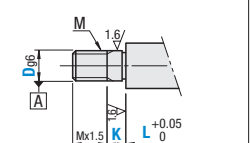

Shouldered Type Standard

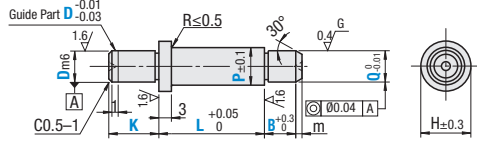

Tapped

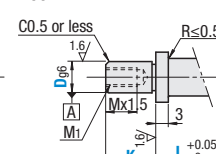

Threaded

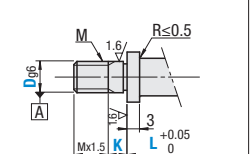

Q ≤ P-1. When K < Pitch x 2, the incomplete threaded portion is included in Mx1.5. 440C or 420 Stainless Steel has an identification groove on D mounting section.

Standard

Part Number	Type	D	P 0.1 mm Increment		Q 0.01 mm Increment	K 1 mm Increment	L 0.01 mm Increment	B 0.1 mm Increment
			Straight	Shouldered				
3	Straight Shouldered	3	3.5–6.0	3.0–5.0	2.00–5.00	3–6	10.00–60.00	2.0–5.0
4		4	4.5–7.0	3.0–5.0	2.00–6.00	4–8	10.00–60.00	2.0–10.0
5	SHFJ GSHFJ	5	5.5–8.0	3.0–7.0	2.00–7.00	5–10	10.00–60.00	2.0–10.0
6		6	6.5–10.0	5.0–7.0	4.00–9.00	6–12	10.00–80.00	2.0–12.0
8	SSHFJ CSHFJ	8	9.0–13.0	5.0–8.0	4.00–12.00	8–16	10.00–80.00	2.0–15.0
10		10	11.0–15.0	6.0–11.0	5.00–14.00	10–20	10.00–100.00	2.0–20.0
12	SSHXJ CSHXJ	12	13.0–16.0	6.0–13.0	5.00–15.00	12–24	10.00–100.00	2.0–20.0

Tapped & Threaded Recommended Tightening Torque (Reference)

M (Coarse)	Tightening Torque N-cm
M3	98
M4	225
M5	461
M6	784
M8	1911
M10	3783
M12	6605

*The tightening torque (ref. value) for hardened products is strength class 8.8. (See technical data on MISUMI 2019 catalog P.4015). Not applicable when using locking agents or spring washers.

Tapped

Part Number	Type	D	P 0.1 mm Increment		Q 0.01 mm Increment	K 1 mm Increment	L 0.01 mm Increment	B 0.1 mm Increment
			Straight	Shouldered				
6	Straight Shouldered	6	6.5–10.0	5.0–7.0	4.00–9.00	6–12	10.00–80.00	2.0–12.0
8		8	9.0–13.0	5.0–9.0	4.00–12.00	8–16	10.00–80.00	2.0–15.0
10	SHFU GSHFU	10	11.0–15.0	6.0–11.0	5.00–14.00	10–20	10.00–100.00	2.0–20.0
12		12	13.0–16.0	6.0–13.0	5.00–15.00	12–24	10.00–100.00	2.0–20.0

Note the strength of under-head part. P.1542

Threaded

Part Number	Type	D	P 0.1 mm Increment		Q 0.01 mm Increment	K 1 mm Increment	L 0.01 mm Increment	B 0.1 mm Increment
			Straight	Shouldered				
3	Straight Shouldered	3	3.5–6.0	3.0–5.0	2.00–5.00	0–6	10.00–60.00	2.0–5.0
4		4	4.5–7.0	3.0–5.0	2.00–6.00	0–8	10.00–60.00	2.0–10.0
5	SHFN GSHFN	5	5.5–8.0	3.0–7.0	2.00–7.00	0–10	10.00–60.00	2.0–10.0
6		6	6.5–10.0	5.0–7.0	4.00–9.00	0–12	10.00–80.00	2.0–12.0
8	SSHFN CSHFN	8	9.0–13.0	5.0–9.0	4.00–12.00	0–16	10.00–80.00	2.0–15.0
10		10	11.0–15.0	6.0–11.0	5.00–14.00	0–20	10.00–100.00	2.0–20.0
12	SSHXN CSHXN	12	13.0–16.0	6.0–13.0	5.00–15.00	0–24	10.00–100.00	2.0–20.0

The dispersion of dimension L should be within 0.02 for same orders. For full thread, specify a K dimension of 0 and NNC alteration.

Part Number Alterations Part Number - P - Q - K - L - B - (SC, HC, DRC, NNC)
 SHXU10 - P8.5 - Q5.00 - K10 - L80.00 - B3.2 - HC12

Part Number Example Part Number - P - Q - K - L - B
 SHFJ5 - P6.0 - Q4.50 - K5 - L30.55 - B3.2

Alterations	Wrench Flats	Wrench Flats	Screwdriver Slot	Relief
Code	SC	HC	DRC	NNC
Spec.	SC = 1 mm Increment SC>D Ordering Code: SC8 Applicable to Straight Type only.	HC = 1 mm Increment HC>P HC>D Ordering Code: HC10 Applicable to Shouldered Type only.	Width 0.8mm Depth 1 mm Ordering Code: DRC Applicable to Threaded Type only.	Adds a relief at the thread end. Ordering Code: NNC Applicable when K=0. Applicable to Threaded Type only.

Support Pins

Flat / Tip Set Screw

Locating Pins/Bushings for Locating Pins



RoHS 10

Type	Shape Code	Material Code	Material	Surface Treatment	Hardness
STP (Flat) SPF (Tip Set Screw)	A (Threaded) B (Tapped) D (Threaded with Pilot)	B	1045 Carbon Steel or Equivalent	Black Oxide	—
		R		Hard Chrome Plating	Plating Hardness :750 HV min.
		HB		Black Oxide	Treated Hardness: 45~50 HRC min.
		HR		Hard Chrome Plating	Treated Hardness: 45~50 HRC min. Plating Hardness :750 HV min.
		SU	304 Stainless Steel	—	—
		C	440C or 420 Stainless Steel	—	Treated Hardness: 50~55 HRC min.

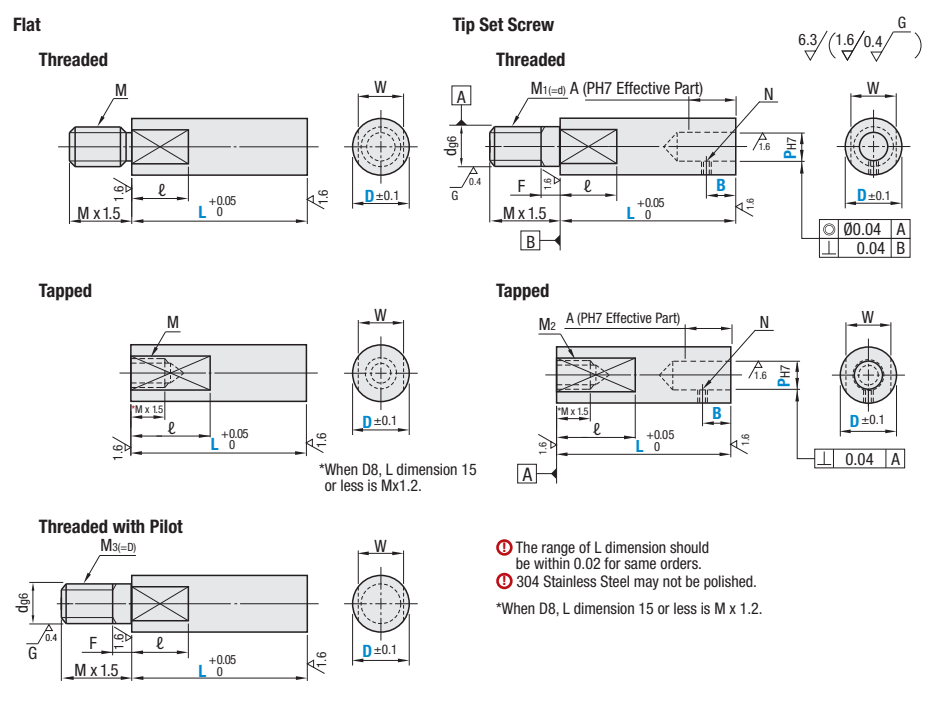

Flat

Type	Part Number		D	L 0.01mm Increment	M (Coarse)	d	M ₃ (Coarse)	F	W	L
	Shape Code	Material Code								
STP (Flat)	A (Threaded) B (Tapped) D (Threaded with Pilot)	B R HB HR SU C	6	10.00~50.00	M3	3	M3	1.5	5	8
			8							
			10							
			12	20.00~80.00	M5	5	M5	2	7	
			15							
			20							
				M8	8	M8	3	8		
				M8	10	M10	4	10		
				M8	12	M12	5	13		
								17		

Tip Set Screw

Type	Part Number	Shape Code	Material Code	D	L 0.01 mm Increment	P Selection	B 0.5 mm Increment	d	F	M ₁ (Coarse)	W	L	A	M ₂ (Coarse)	N (Coarse)	
SPF (Tip Set Screw)	A (Threaded) B (Tapped)	B SU		12	20.00(30.00)~80.00	6	4.0~6.0	8	4	M8	10	10	10	M5	M3	
				15	20.00(40.00)~80.00	8	5.0~10.0	10	5	M10	13	10	15	M8	M4	
				20	25.00(45.00)~80.00	10	12	5.0~15.0	12	5	M12	17	10	20	M8	M4
				25	30.00(50.00)~80.00	12	16	5.0~19.0	16	5	M16	20	12	24	M10	M4
				30	35.00(65.00)~80.00	16	20	5.0~23.0	20	6	M20	24	18	28	M16	M4

① L dimension in () is applicable to Tapped Type only. ② Threaded type not available for Stainless Steel material. Tapped type not available for Carbon Steel material.

Part Number Example

Part Number - L - P - B

STPAB10 - L20.03
 SPFB SU12 - L20.01 - P6 - B5 Flat Type
 SPFAB12 - L20.01 - P6 - B5 Tip Set Screw

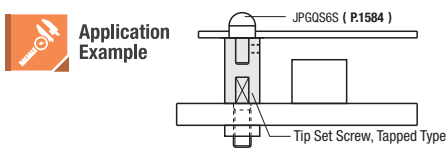

Tapped & Threaded Recommended Tightening Torque (Reference)

M (Coarse)	Tightening Torque N-cm
M3	98
M4	225
M5	461
M6	784
M8	1911
M10	3783
M12	6605
M16	16366
M20	32928

*The tightening torque (ref. value) for hardened products is strength class 8.8. (See technical data on MISUMI 2019 catalog P.4015). Not applicable when using locking agents or spring washers.

Support Pins

Selectable Pilot (Tip) Shape

Support Pins – Selectable Pilot (Tip) Shape



RoHS10

Threaded	Tapped	Pilot	Material	Surface Treatment	Hardness
LSPC	LSPA	LSPB	1045 Carbon Steel or Equivalent	Black Oxide	—
LSPRC	LSPAR	LSPBR		Hard Chrome Plating	Plating Hardness :750 HV min.
LSPHBC	LSPAHB	LSPBHB		Black Oxide	Treated Hardness: 45~50 HRC min.
LSPHRC	LSPAHR	LSPBHR		Hard Chrome Plating	Treated Hardness: 45~50 HRC min. Plating Hardness :750 HV min.
LSPSUC	LSPASU	LSPBSU	304 Stainless Steel	—	—
LSPSCC	LSPASC	LSPBSC	440C or 420 Stainless Steel	—	Treated Hardness: 50~55 HRC min.

$$6.3 / (\sqrt{1.6} / \sqrt{0.4})^G$$

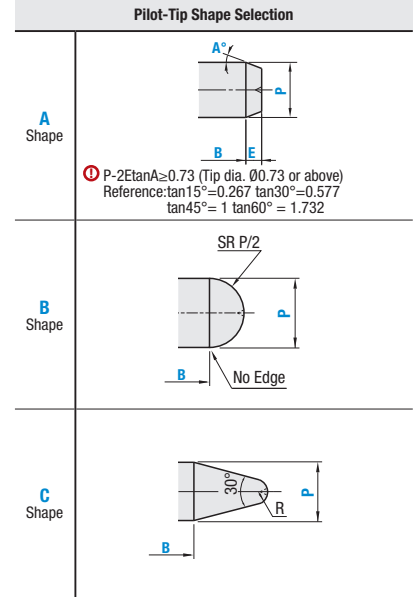
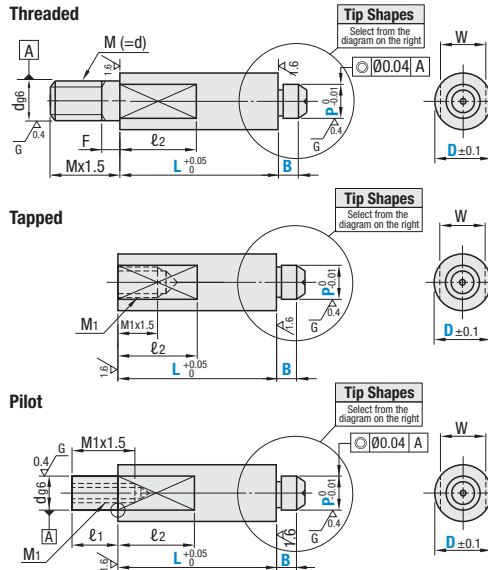

Ⓢ For Stepped Pilot Type, D Dimension 10 or more is available. Ⓢ Note the strength of undercut part for Tapped. P:1542

Part Number			L 0.01 mm Increment	P 0.01 mm Increment	B 0.1 mm Increment	E 0.1 mm Increment (Shape A Only)	A Selection (Shape A Only)	R (Shape C)	d	M (Coarse)	F	M ₁ (Coarse)	ℓ ₁	W	ℓ ₂
Type	Tip Shape	D													
Threaded LSPC LSPRC LSPHBC LSPHRC LSPSUC LSPSCC	A	6	10.00~50.00	3.00~4.00	2.0~12.0	0.5~10.0	15	1	3	3	1.5	M3	—	5	8
		8							5	2	7				
		10							6	3	8				
		12							8	4	10				
		15							10	5	13				
		20							12	5	17				
Tapped LSPAR LSPRC LSPAHR LSPASU LSPASC	B	10	20.00~80.00	4.00~8.00	2.0~20.0	0.5~10.0	30	1.5	6	6	3	M5	6	8	10
		12							8	4	10				
		15							10	5	13				
		20							12	5	17				
		25							16	5	20				
		Pilot LSPB LSPBR LSPBHB LSPBHR LSPBSU LSPBSC							C	10	20.00~80.00			5.00~10.00	
12	12		5	17											
15	12		5	17											
20	16		5	20											
25	16		5	20											
25	16		5	20											

Ⓢ D values 6, 8 unavailable for Pilot type parts.

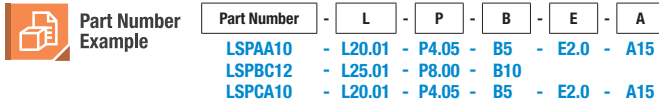

Tapped, Threaded

Recommended Tightening Torque (Reference)

M (Coarse)	Tightening Torque N•cm
M3	98
M4	225
M5	461
M6	784
M8	1911
M10	3783
M12	6605
M16	16366
M20	32928

*The tightening torque (ref. value) for hardened products is strength class 8.8. (See technical data on MISUMI 2019 catalog P.4015). Not applicable when using locking agents or spring washers.

Hex Support Pins

Stepped

Hex Support Pins – Stepped



Type			Material	Surface Treatment	Hardness
Threaded	Tapped	Pilot			
SRPCB	SRPAB	SRPBB	1045 Carbon Steel or Equivalent	Black Oxide	—
SRPCR	SRPAR	—		Hard Chrome Plating	Plating Hardness: 750 HV min.
SRPCHB	SRPAHB	SRPBHB		Black Oxide	Treated Hardness: 45~50 HRC min.
SRPCHR	SRPAHR	SRPBHR		Hard Chrome Plating	Treated Hardness: 45~50 HRC min. Plating Hardness: 750 HV min.
SRPCC	SRPAC	SRPBC		440C or 420 Stainless Steel	—

Threaded

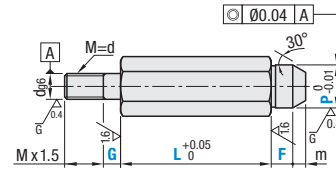

Tapped

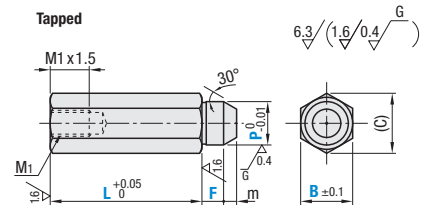

Pilot

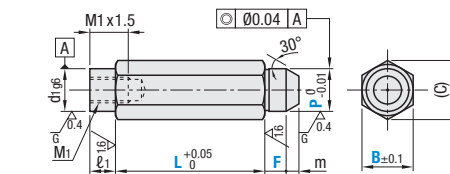

a=1.0
d=P-0.2

Ⓢ Relief dimension is a reference value.

Ⓢ When G < Pitch x 2, the incomplete threaded section (Pitch x 2) is included in M x 1.5. Pitch Diameter P.4010

Part Number			L 0.01 mm Increment	P 0.01 mm Increment	F 0.1 mm Increment	G 1 mm Increment Threaded Only	m	(C)	d	M (Coarse)	M ₁ (Coarse)	ℓ ₁	d ₁						
Type	B	Type																	
Pilot SRPBB SRPBHB SRPBHR SRPBC	Tapped SRPAB SRPAR SRPAHB SRPAHR SRPAC	6	10.00–50.00	3.00–4.00	2.0–12.0	0 or 2 ≤ G ≤ dx2	1	6.9	4	M4	M3	—	—						
		7		8.1															
	8	15.00–50.00		3.00–6.00	2.0–15.0			2						9.2	5	M5	M4	6	8
	10	4.00–8.00		2.0–20.0	11.5														
	12	4.00–10.00		5.00–10.00	2.0–25.0			3						13.9	6	M6	M5	8	10
	13	20.00–80.00			15														
	14	5.00–10.00		2.0–30.0	16.2			8						M8	M6	9	12		
	17	8.00–15.00		19.6															
	19	2.0–30.0		21.9	10			M10						M8	10	16			
	24	10.00–15.00		27.7															

Ⓢ Pilot type available for B ≥ 10. Ⓢ 440C or 420 Stainless Steel is B ≥ 8.

Ⓢ D6, D7 unavailable for SRPAC, SRPCC part types Ⓢ For full thread, specify a G dimension of 0 and NNC alteration.



Part Number Example

Part Number	L	P	F
Type	B		
SRPBHB	14	L70.02	P6.00 - F5.0
SRPAHB	14	L70.02	P6.00 - F5.0



Part Number Alterations

Part Number	L	P	F	G	(DRC, NNC)
SRPCB12	L30.00	P4.98	F3.0	G0	NNC

Alterations	Screwdriver Slot	Relief
Code	DRC	NNC
Spec.	Machines a screwdriver slot of width 0.8mm and depth 1 mm.	Adds a relief at the thread end. Ⓢ Applicable when G=0.

Tapped and Threaded

Recommended Tightening Torque (Reference)

M (Coarse)	Tightening Torque N-cm
M3	98
M4	225
M5	461
M6	784
M8	1911
M10	3783
M12	6605
M16	16366
M20	32928

Ⓢ *The tightening torque (ref. value) for hardened products is strength class 8.8. (See technical data on MISUMI 2019 catalog P.4015). Not applicable when using locking agents or spring washers.

Hex Support Pins

Flat

Hex Support Pins – Flat



RoHS10

Type		Material	Surface Treatment	Hardness
Threaded	Tapped			
SRTAB	SRTBB	1045 Carbon Steel or Equivalent	Black Oxide	Plating Hardness 750 min
SRTAR	SRTBR		Hard Chrome Plating Plating Thickness: 3 μm or More	
SRTAHB	SRTBHB		Black Oxide	Treated Hardness: 45–50 HRC
SRTAHR	SRTBHR		Hard Chrome Plating Plating Thickness: 3 μm or More	Plating Hardness 750 min Treated Hardness: 45–50 HRC
SRTASU	SRTBSU		304 Stainless Steel	—
SRTAC	SRTBC	440C or 420 Stainless Steel	—	Treated Hardness: 50–55 HRC

Threaded

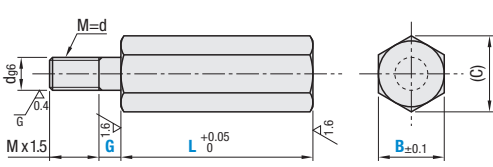

$$6.3\sqrt[3]{(1.6/0.4)\sqrt{G}}$$

Tapped

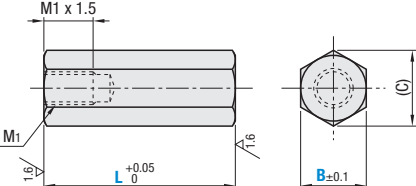

ⓘ When G < Pitch x 2, the incomplete threaded section (Pitch x 2) is included in M x 1.5. Pitch Diameter **P.4010**

Type	Part Number		B	L 0.01 mm Increment	G 1 mm Increment Threaded Type only	C	d	M (Coarse)	M ₁ (Coarse)		
	Shape Code	Material Code									
Threaded	A (Threaded)	B R HB	6	10.00–50.00	0 or 2 ≤ G ≤ dx2	6.9	4	M4	M3		
			7			8.1					
8	9.2										
Tapped	B (Tapped)	HR SU C	10	20.0–80.00		11.5	5	M5	M4		
			12			13.9					
			13			15	6	M6	M5		
			14			16.2					
			17			19.6					
								19	8	M8	M6
								21.9			
							24	10	M10	M8	

ⓘ 440C or 420 Stainless Steel is B≥8. ⓘ For full thread, specify a G dimension of 0 and NNC alteration.

Part Number Example

Part Number					
Type	Shape	Materials	B	L	G
SRT	A	B	8	- L20.00	- G6
SRT	B	SU	12	- L50.00	

Part Number Alterations

Part Number	L	G	(DRC, NNC)
SRTAB10	- L30.00	- G3	- DRC

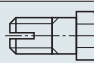
Alterations	Screwdriver Slot	Undercut
		
Code	DRC	NNC
Spec.	Machines a screwdriver slot of width 0.8 mm and depth 1 mm.	Adds a relief at the thread end. ⓘ Applicable when G=0.

Application Example

Features: Due to the hex shape, adjusting height with a wrench is easy.

