

# Pipe Manifolds

## 90° Multi-Directional Manifolds / 90° Manifold Sockets

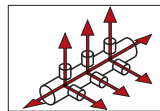

### Pipe Manifolds – 90° Multi-Directional

Type	Material	Surface Treatment
Both Ends Threaded <b>SGMLF</b> <b>SUMLF</b>	SGP 304 Stainless Steel	Trivalent Chromate —
Both Ends Tapped <b>SGMMLF</b> <b>SUMMLF</b>	SGP 304 Stainless Steel	Trivalent Chromate —

Thread JIS B0203 R (PT)  
(Max. Operating Pressure: 0.7 MPa = 7 kgf/cm<sup>2</sup> or Less)



RoHS 10

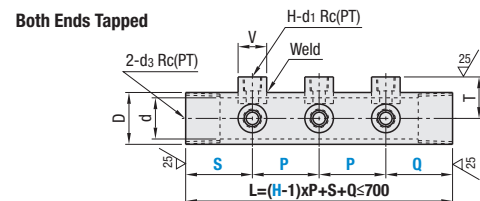
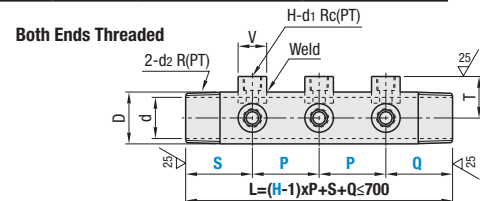

Application Fluid:  
Water, Air

#### V and T Dimension

d <sub>1</sub> Rc (PT)	V	T
1 (1/8)	15	21.7
2 (1/4)	20	28.4
3 (3/8)	25	33.4
4 (1/2)	30	39.9

### Both Ends Threaded / Both Ends Tapped

Part Number		H Circuits	P, S & Q	d <sub>1</sub>	d <sub>2</sub>	d <sub>3</sub>	D	d	
Type	No.							Material: SGP	Material: Stainless Steel
Both Ends Threaded	Both Ends Tapped		1 mm Increment	Rc (PT)	R (PT)	Rc (PT)			
SGMLF SUMLF	SGMMLF SUMMLF	20A	35 (45)–150	1/8	3/4	3/4	27.2	21.6	21.4
		25A	40 (50)–150	1/4	1	1	34	27.6	27.2
		32A	50 (60)–150	3/8	1-1/4	1-1/4	42.7	35.7	35.5
		40A	60 (70)–150	1/2	1-1/2	1-1/2	48.6	41.6	41.2

⊙ For Both Ends Tapped Type, minimum configurable values for S and Q are in ( ).  
⊙ Specify P, S and Q within the range of L = (H-1) x P + S + Q ≤ 700.

### Pipe Manifolds – 90° Manifold Sockets



Type	Material	Surface Treatment
<b>SGSKK</b>	1020 Carbon Steel	Zinc Galvanizing
<b>SUSKK</b>	304 Stainless Steel	—

\*1020 Carbon Steel for M5 only

⊙ SGSK has a groove (Depth 0.2) at H position for identification.

Thread JIS B0203 R (PT)

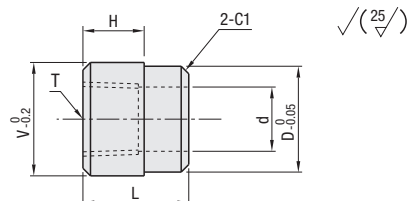

Feature: Welded Sockets used for Pipe Manifolds. Installation is made easy with a step provided on the outer circumference.

Part Number		T Rc (PT)	V	L	D	d	H
Type	No.						
SGSKK SUSKK	1	1/8	15	14	14	8.5	8.1
	2	1/4	20	18	19	11.5	11.4
	3	3/8	25	20.5	24	14.5	12
	4	1/2	30	24.5	29	16.5	15.6

Part Number Example  
SGSK2  
SUMLF32A - 3 - P50 - S50 - Q50  
SGSKK1

# Pipe Manifolds

## 180° Multi-Directional Manifold

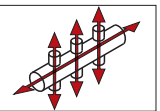

### Pipe Manifolds – 180° Multi-Directional

Type		Material	Surface Treatment
Standard Type	Configurable Type		
<b>SGMMD</b>	—	SGP	Trivalent Chromate
<b>SUMMD</b>	<b>SUMMDF</b>	304 Stainless Steel	—

Thread JIS B0203 R (PT)  
(Max. Operating Pressure: 0.7 MPa = 7 kgf/cm<sup>2</sup> or Less)



RoHS 10

#### Both Ends Tapped

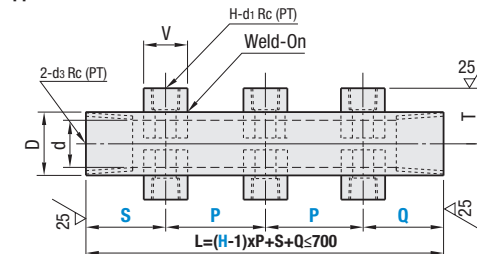

Application Fluid:  
Water, Air

#### V & T Dimension

d <sub>1</sub> Rc (PT)	V	T
1 (1/8)	15	21.7
2 (1/4)	20	28.4
3 (3/8)	25	33.4
4 (1/2)	30	39.9

\*Drawing is for when 3-Circuit type is selected.

### Both Ends Tapped

Part Number		H Circuits	P, S & Q		d <sub>1</sub>	d <sub>3</sub>	D	d
Type	No.		Standard Type	Configurable Type 1 mm Increment				
SGMMD SUMMD	SUMMDF	20A	45	35 (45)–150	1/8	3/4	27.2	21.4
		25A	50	40 (50)–150	1/4	1	34	27.2
		32A	60	50 (60)–150	3/8	1 1/4	42.7	35.5
		40A	70	60 (70)–150	1/2	1 1/2	48.6	41.2

⊙ Specify P, S and Q within the range of L = (H-1)xP + S + Q ≤ 700. ⊙ For P, S, Q Configurable Type, minimum required value for S and Q dimensions are in ( ).

Part Number Example  
SUMMDF32A - 3 - P50 - S60 - Q60  
SGSKK1