

Handles

Folding / with Cap / Cap Nuts / Aluminum Hollow Type

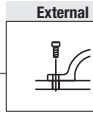

Type	Material	Surface Treatment
UWFASN	1045 Carbon Steel	Chrome Plating
UWFASNS	304 Stainless Steel	Buffed Surface

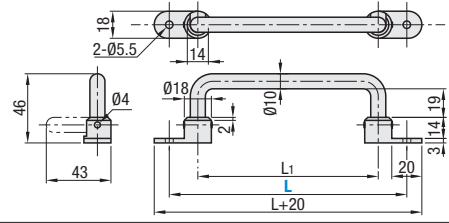

RoHS10

Part Number	L	L ₁	Allowable Load (N)	Mass (g)
UWFASN Steel	138	100	650	150
UWFASNS Stainless Steel	158	120	550	160
	180	142	520	180
	218	180	500	200

Part Number Example: UWFASN138



Type	Material	Surface Treatment	Material	Color
HHDG	ADC12 Aluminum Alloy Cast	Baked Finish	ABS Resin	White
HHDGS	304 Stainless Steel Equivalent	Buffed Surface	ABS Resin	White

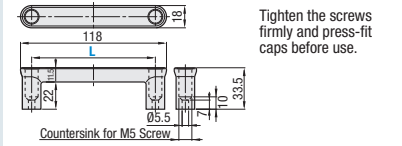

RoHS10

Part Number	L	Mass (g)	Applicable Screws
HHDG	100	62	Flathead Screw M5
HHDGS	100	62	Flathead Screw M5

Part Number Example: HHDG100

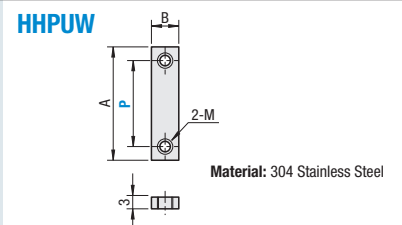

RoHS10

Part Number	P	B	A	M	Handle
HHPUW	90	10	100	6	UPCDG90
	100	12	110	5	HHDG100

Part Number Example: HHPUW100

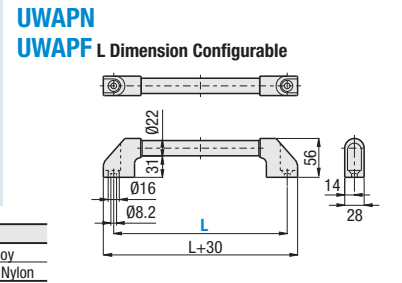
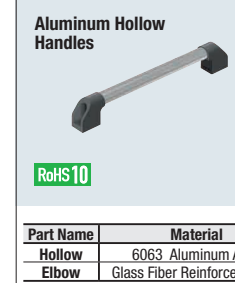

RoHS10

Part Number	L	Applicable Screws
UWAPN L Dimension Selectable	150	Countersunk Screws M8
	200	
	250	
	300	
	400	
	500	
	600	

Part Number	L 1mm Increment	Applicable Screws
UWAPF L Dimension Configurable	100-150	Countersunk Screws M8
	151-200	
	201-250	
	251-300	
	301-400	
	401-500	
	501-600	

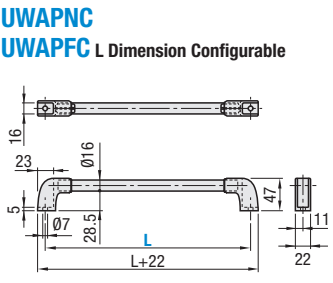

RoHS10

Part Number	L	Applicable Screws
UWAPNC L Dimension Selectable	100	Socket Head Cap Screws M6
	150	
	200	
	250	
	300	

Part Number	L 1mm Increment	Applicable Screws
UWAPFC L Dimension Configurable	100-150	Socket Head Cap Screws M6
	151-200	
	201-250	
	251-300	

Part Number Example: UWAPN150, UWAPFC-185. Note: - is not needed for L Dimension Selectable Type.

Angled Handles

Welded Round / With Mounting Tabs / With a Plate

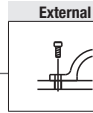

Type	Material	Surface Treatment
UHFSN	12L13 Carbon Steel or Equivalent	Chrome Plating
UHFSNB	12L13 Carbon Steel or Equivalent	Black Oxide
UHFNSS	304 Stainless Steel Equivalent	Buffed Surface

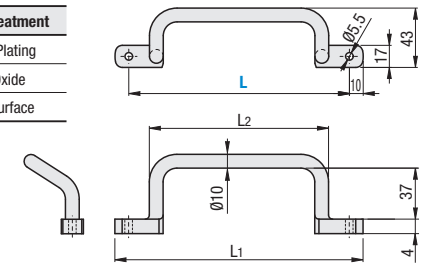

RoHS10

Part Number	L	L ₁	L ₂
UHFSN Steel	110	130	80
	120	140	90
UHFSNB Steel	125	145	95
	160	180	130
UHFNSS Stainless Steel	200	220	170
	250	270	220

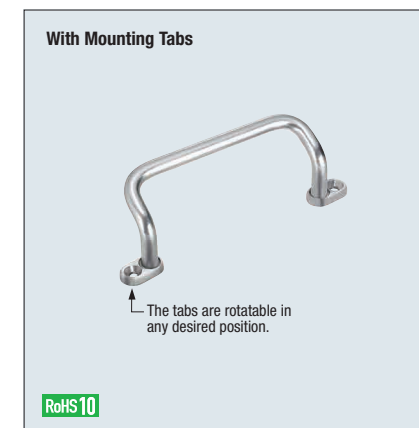
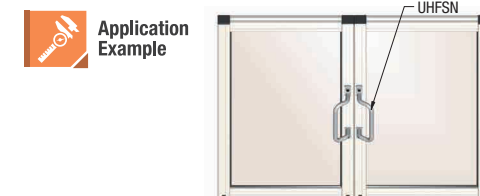

Type	Material	Surface Treatment	Tab G		Accessory Tab S		Thread
			Material	Surface Treatment	Material	Surface Treatment	
UHFNGG	12L13 Carbon Steel or Equivalent	Chrome Plating	Zinc Die Casting	Electrostatic Coating (Silver)	304 Stainless Steel	-	SHFBS5-12 Material: 304 Stainless Steel Equivalent ⊕ 2 screws are included.
UHFNSG	304 Stainless Steel	Buffed Surface	-	-	-	-	-
UHFNEAG	Aluminum Alloy	Clear Anodize	-	-	-	-	-

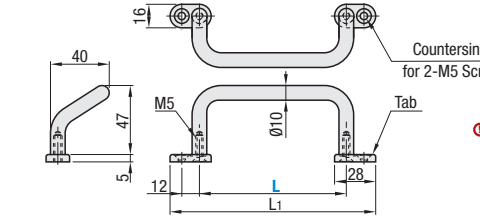

RoHS10

Part Number	L	Tab Selectable	L ₁	Allowable Load (N)	Reference Mass (g)
UHFNGG Steel	48	G (Zinc Diecast) S (304 Stainless Steel)	86	2000	90
	66		104		100
	88		126		114
UHFNSG Stainless Steel	100		138		122
	110		148		127
UHFNEAG Aluminum	120		158		134
	125		163		136
	160		198		158

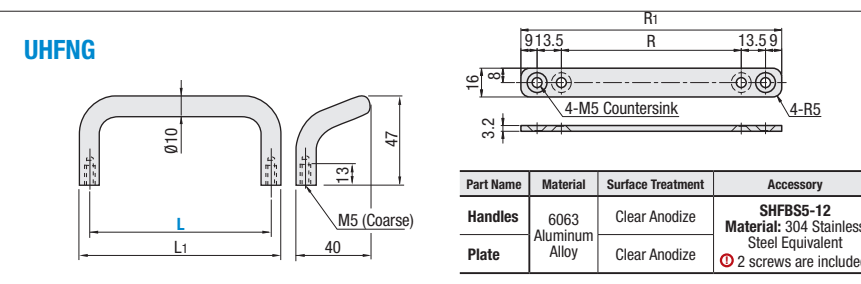

RoHS10

Part Number	L	L ₁	R	R ₁	Reference Mass (g)
UHFNG	100	110	100	145	50
	120	130	120	165	52.5
	125	135	125	170	54



Part Number Example: UHFSN160, UHFNGG100, UHFNG120. Note: - M, - G.