

Casters Integrated with Leveling Mounts

Configurable Mounting Hole



Casters Integrated with Leveling Mounts – Configurable Mounting Holes



RoHS10

Part Number	Wheel Material (Color)
HCFTF	Nylon (Gray)
HCFTFM	MC Nylon (Blue)
HCFTFD	Electrically Conductive MC Nylon (Black)

** HCFTF500 is phenol (black).
** HCFTFD250 and 350 is gray.

No.	Body		Jack Bolt		Pad
	Material	Surface Treatment	Material	Surface Treatment	Material
60 130	Aluminum Casting Alloy 383.0	Black Paint	1018 Carbon Steel or Equivalent	Trivalent Chromate	EPDM Synthetic Rubber
250 350	Low Carbon Steel	Trivalent Chromate (Black)	1018 Carbon Steel or Equivalent	Trivalent Chromate	EPDM Synthetic Rubber
500	FCD Cast Iron45	Black Paint	1018 Carbon Steel or Equivalent	Trivalent Chromate	EPDM Synthetic Rubber

*Pad is not included with No.500 type.

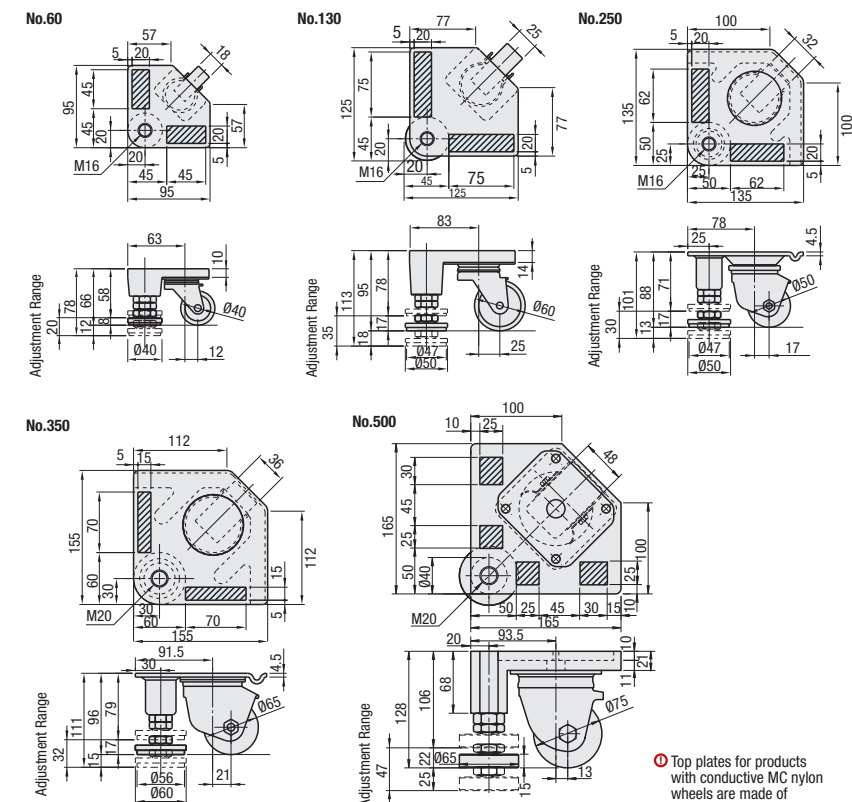

(1) Drilling Locations of 2 mounting holes
(Only No. 500 has one mounting hole)

(2) Drilling Specifying Method

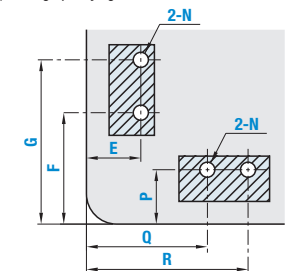

Specify within

Hole Type	Through Hole						
Code	N						
Shape							
Machining Specification	<table border="1"> <thead> <tr> <th>Dimension</th> <th>Nominal Diameter</th> </tr> </thead> <tbody> <tr> <td>N</td> <td>5 6 8 10</td> </tr> <tr> <td>d</td> <td>6 7 9 11</td> </tr> </tbody> </table>	Dimension	Nominal Diameter	N	5 6 8 10	d	6 7 9 11
Dimension	Nominal Diameter						
N	5 6 8 10						
d	6 7 9 11						

Top plates for products with conductive MC nylon wheels are made of aluminum alloy.

Part Number Type	No.	N (Nominal Diameter) Selection			Drilling Location 1 mm Increment		Allowable Load		Mass (g)
		E / P	F / G / Q / R	kgf	N				
HCFTF	60	5	6	(45+N/2) – (90-N/2)	60	588	600		
HCFTF HCFTFM HCFTFD	130	6	8	10	(5+N/2) – (25-N/2)	(45+N/2) – (120-N/2)	130	1275	1100
HCFTF HCFTFM HCFTFD	250	6	8	10	(5+N/2) – (20-N/2)	(50+N/2) – (112-N/2)	250	2451	1445
HCFTF HCFTFM HCFTFD	350	6	8	10	(5+N/2) – (20-N/2)	(60+N/2) – (130-N/2)	350	3432	2170
HCFTF HCFTFM HCFTFD	500	8	10	(10+N/2) – (35-N/2)	(50+N/1) – (75-N/1) (120+N/1) – (150-N/1)	500	4902	5600	

Part Number Example: HCFTF130 - 6 - E18 - F55 - G80 - P20 - Q55 - R70

Part Number Alterations: HCFTF130 - 6 - E18 - F55 - G80 - P20 - Q80 - R70 - BL150

Alterations Code	Adjustment Pad Height									
	BL100					BL150				
	Type	No.	Height from Floor		JPY/1Code	Type	No.	Height from Floor		JPY/1Code
Spec.	HCFTF HCFTFM HCFTFD	60	78	132		340	HCFTF HCFTFM HCFTFD	60	78	
		130	113	152	130			113	200	
		250	101	145	250			101	191	
		350	111	150	350			111	200	
		500	—	—	—			500	150	210

*The height from the floor can be increased by using a taller adjusting pad. However, the adjustment pad will protrude from the plate surface.

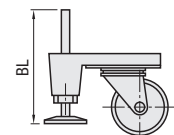

Casters Integrated with Leveling Mounts

Configurable Wheel Material / Configurable Wheel Type



Casters Integrated with Leveling Mounts – Configurable Wheel Material



Wheel material is selectable.

Casters Integrated with Leveling Mounts – Configurable Wheel Type



RoHS10

Type	Main Body Material	Wheel	Plate Material	Adjustment Pads Surface Treatment	Adjustment Pads Material
		Material			
CAZL	FCD Cast Iron	Rubber	FCD Cast Iron	Baked Finish (Black)	1018 Carbon Steel or Equivalent Rubber: Neoprene Rubber
		Urethane			
CAL75	FCD Cast Iron	MC Nylon	Coating (Green)		

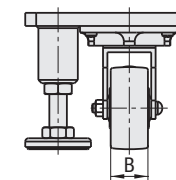
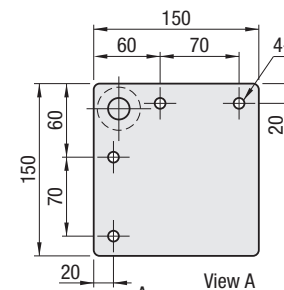

Wheel Material Selectable Type

Part Number Type	D	Wheel Material	B		E	d	Allowable Load N			
			R / M / Z	U			R Rubber	U Urethane	M MC Nylon	Z Casting
CAZL	75	R Rubber U Urethane M MC Nylon Z Casting	32	30	25	9	1500	2500	3000	3600

MC Nylon Wheel Type

Part Number	D	E	B	d	Allowable Load N
CAL75	75	26	20	9	3528

Part Number Example: CAZL75 - R

Application Example

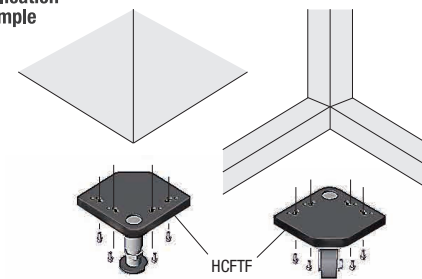

Specify mounting hole positions in accordance with frame sizes. For Aluminum Extrusion Type, please see P.2918.