

Latch Magnets

For Aluminum Extrusions

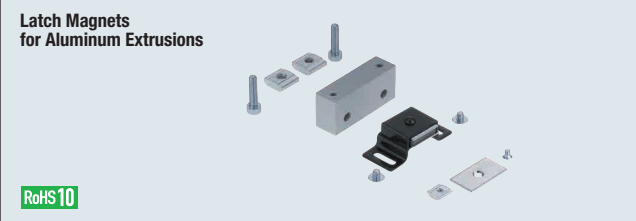

RoHS10

Part Name	Material	Surface Treatment
Housing	304 Stainless Steel	Dark Brown Paint
Magnet	Ferrite	—
Plate	Low Carbon Steel	Chrome Plating

HMEN-T Latch Magnets

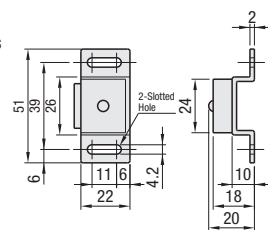

Catch Plate

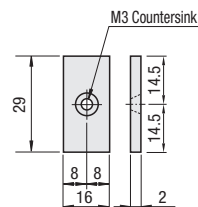

MG5-5 Plate

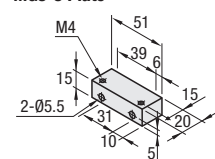

MG6-5 Plate

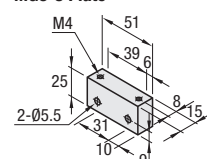

MG8-5 Plate

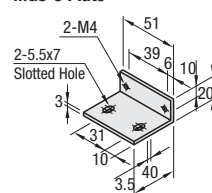

MG6-6 Plate

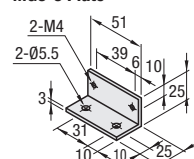

MG8-6 Plate

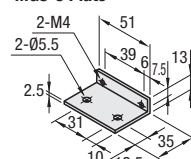

Application Example

- 5-5 Mounting Example
- 6-5 Mounting Example
- 8-5 Mounting Example
- 6-6 Mounting Example
- 8-6 Mounting Example
- 8-8 Mounting Example

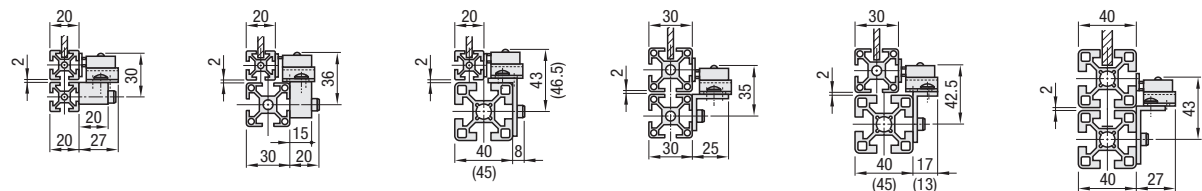

Dimensions in () are for 45 square extrusions.

Part Number	Components																
	Type	No.	Magnet	Retaining Force N (kgf)	Installation Plate	Magnet Side						Door Side (Extrusion)					
						Mounting Screws	Quantity	Screws	Quantity	Nuts	Quantity	Flathead Screw	Quantity	Nuts	Quantity		
HMEN	5-5	HMEN-T	29.4 (3)	MG5-5	Truss Screw M4-5	2	SCB5-25	2	HNTT5-5	2	M3-6	1	HNTT5-3	1			
	6-5						SCB5-22		HNTT6-5				HNTT5-3				
	8-5						SCB5-15		HNTT8-5				HNTT6-3				
	6-6						SCB5-10		HNTT6-5				HNTT6-3				
	8-6						SCB5-12		HNTT8-5				HNTT6-3				
	8-8						SCB5-15		HNTT8-5				HNTM8-3				

Part Number Example

Part Number
HMEN6-6

Door Side Plate	Selection Standard		
	Body Side Extrusion		
	20 Square	30 Square	40/45 Square
20 Square	HMEN5-5	HMEN6-5	HMEN8-5
30 Square	—	HMEN6-6	HMEN8-6
40 Square	—	—	HMEN8-8

Latch Magnets / Thin Latch Magnets

For Aluminum Extrusions

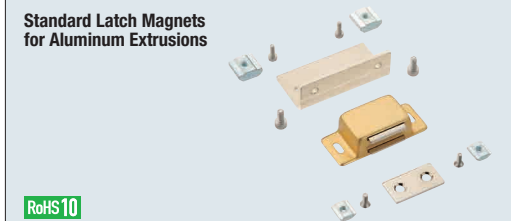

RoHS10

* When requesting magnets only, refer to MGCE on P.3267

Magnets Catch	Parts	Material	Surface Treatment
	Housing	Aluminum Alloy	Anodize
	Magnet	Ferrite	—
Absorption Board	Low Carbon Steel	Nickel Plating	

ME5-5 Plate

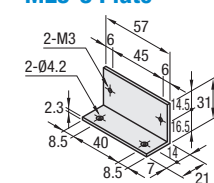

ME6-5 Plate

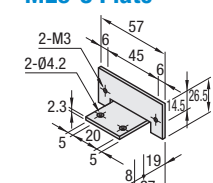

ME6-6 Plate

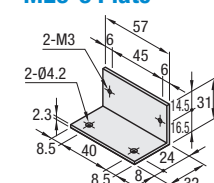

MGCE1

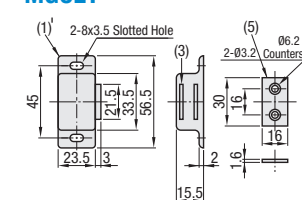

Application Example

5-5 Mounting Example

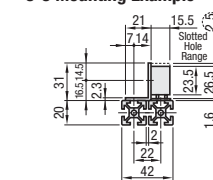

6-5 Mounting Example

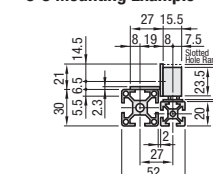

6-6 Mounting Example

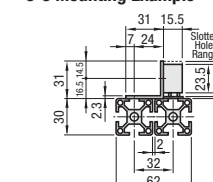

Part Number	Type	No.	Components									
			Extrusion Side					Door Side				
HMGCE	5-5	MGCE1	ME5-5	SCB4-6	2	HNTT5-4	2	SCB3-6	2	HFBCM3-6	2	HNTT5-3
	6-5		ME6-5	SCB4-8		HNTT6-4		HFBCM3-6		HNTT6-3		
	6-6		ME6-6	HFBCM3-8		HNTT6-3						

Thin Latch Magnets for Aluminum Extrusions

RoHS10

* When requesting magnets only, refer to MGCBU on P.3269

Latch Magnets	Parts	Material	Surface Treatment
	Housing	ABS Resin	—
	Magnet	Ferrite	—
Absorption Board	Low Carbon Steel	Chrome Plating	

MB5-5

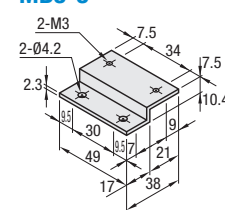

MB6-6

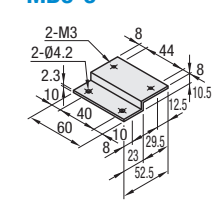

MGCBU

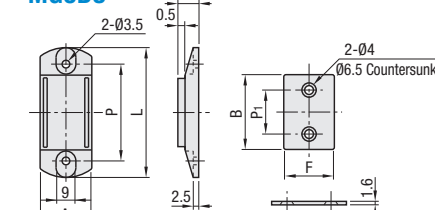

Part Number	Type	No.	Components																
			Extrusion Side								Door Side								
HMBCE	5-5	MGCBU49	49	34	17	6.5	16.5	24	13	MB5-5	SCB4-6	2	HNTT5-4	2	SCB3-6	4	HFBCM3-6	2	HNTT5-3
	6-6	MGCBU59	59	44	23.5	6.7	23	34	20	MB6-6	SCB4-8	2	HNTT6-4	2	SCB3-6	4	HFBCM3-8	2	HNTT6-3

Part Number Example

Part Number
HMGCE5-5
HMBCE6-6

Application Example

6-6 Mounting Example

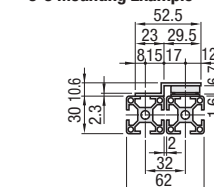

5-5 Mounting Example

