

Sheet Metal Plates / Brackets

HFS8 Series

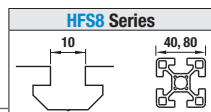

Sheet Metal / Brackets

HPTSS8
SHPTSS8

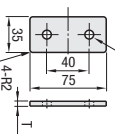

HPTSSL8
SHPTSSL8

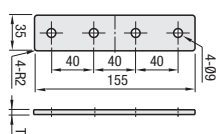

HPTSD8
SHPTSD8

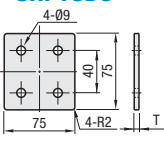

Type	Material	Surface Treatment
HPTSS	Low Carbon Steel	Bright Chromate Plating
HPTSSL		
HPTSD		
SHPTSS	304 Stainless Steel	—
SHPTSSL		
SHPTSD		

Part Number	Mass (g)	T	Applicable Screw / Nut			
			Screw	Qty.	Nuts	Qty.
HPTSS8	61	3.2	M8-15	2	M8	2
SHPTSS8		3				
HPTSSL8	3.2					
SHPTSSL8	3					
HPTSD8	3.2					
SHPTSD8	3					

Sheet Metal / Brackets

HPTLN8
SHPTLN8

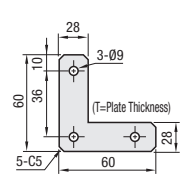

HPTLS8
SHPTLS8

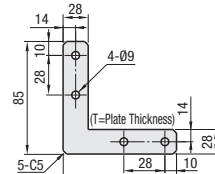

HPTLD8

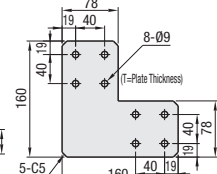

Type	Material	Surface Treatment
HPTLN	Low Carbon Steel	Trivalent Chromate
HPTLS	Low Carbon Steel	Bright Chromate Plating
SHPTLN	304 Stainless Steel	—
SHPTLS		

Part Number	Mass (g)	T	Applicable Screw / Nut			
			Screw	Qty.	Nuts	Qty.
HPTLN8	50	3.2	M8-15	3	M8	3
SHPTLN8		3				
HPTLS8	3.2					
SHPTLS8	3					
HPTLD8	3.2					
SHPTLD8	3					

Sheet Metal / Brackets

HPTCUL8
Trivalent Chromate
SHPTCUL8

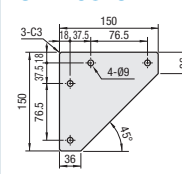

HPTUL8
Trivalent Chromate

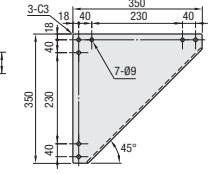

HPTWUL8
Trivalent Chromate

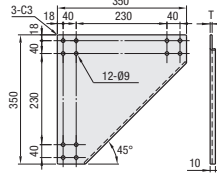

Type	Material	Surface Treatment
HPTCUL	Low Carbon Steel	Trivalent Chromate
HPTUL		
HPTWUL		
SHPTCUL	304 Stainless Steel	—

Part Number	Mass (g)	T	Applicable Screw / Nut			
			Screw	Qty.	Nuts	Qty.
HPTCUL8	360	3.2	M8-15	4	M8	4
SHPTCUL8		3				
HPTUL8	3.2					
SHPTUL8	3					
HPTWUL8	3.2					
SHPTWUL8	3					

Part Number Example: **HPTSS8**

Part Number Alterations: **HPTSS8 - SET** (Not RoHS compliant when -SET is specified.)

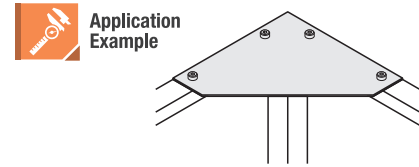

Alteration	Code	Spec.	Plates, Brackets
Applicable Screws & Nuts Set	SET	Materials	HPTSS8 SHPTSS8 HPTSSL8 SHPTSSL8 HPTSD8 SHPTSD8 SHTSS8 SHPTSS8 HPTLN8 SHPTLN8 HPTLS8 SHPTLS8 HPTLD8 SHPTLD8 HPTCUL8 SHPTCUL8 HPTUL8 SHPTUL8 HPTWUL8 SHPTWUL8
		Set	Applicable screws and nuts for mounting each plate on extrusions come in a set.
		Low Carbon Steel	Screws: CBM Nuts: HNTT
		304 Stainless Steel	Screws: SCB Nuts: HNTTSN

Sheet Metal Plates / Brackets

HFS8 Series

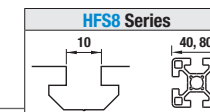

Sheet Metal / Brackets

HPTTS8
SHPTTS8

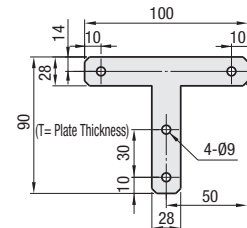

HPTTD8

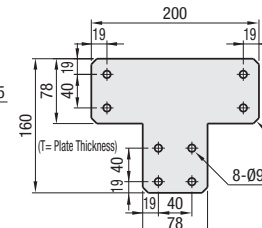

HPTPS8

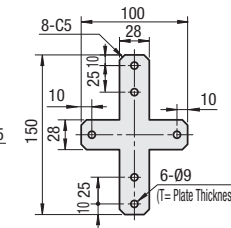

Type	Material	Surface Treatment
HPTTS	Low Carbon Steel	Bright Chromate Plating
HPTTD		
HPTPS		
SHPTTS	304 Stainless Steel	—

Part Number	Mass (g)	T	Applicable Screw & Nut			
			Screw	Qty.	Nuts	Qty.
HPTTS8	103	3.2	M8-15	4	M8	4
SHPTTS8		3				
HPTTD8	3.2					
SHPTTD8	3					
HPTPS8	3.2					
SHPTPS8	3					

Not RoHS compliant when -SET is specified.

Sheet Metal / Brackets

HPTBS8
SHPTBS8

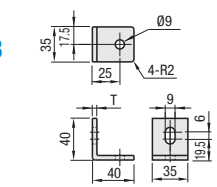

HPTBD8
SHPTBD8

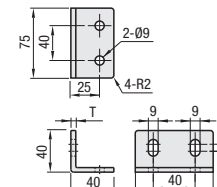

HPTBDW8

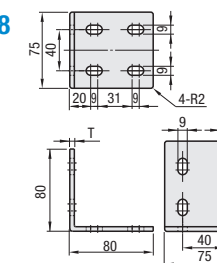

HPTGS8

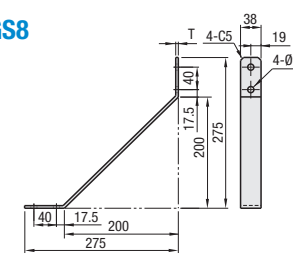

Type	Material	Surface Treatment
HPTBS	Low Carbon Steel	Bright Chromate Plating
HPTBD		
HPTBDW		
SHPTBS	304 Stainless Steel	—
SHPTBD		
SHPTBDW		

Part Number	Mass (g)	T	Applicable Screw & Nut			
			Screw	Qty.	Nuts	Qty.
HPTBS8	83	4.5	M8-15	2	M8	2
SHPTBS8		4				
HPTBD8	4.5					
SHPTBD8	4					
HPTBDW8	6					
HPTGS8	4.5					

Not RoHS compliant when -SET is specified.

Part Number Example: **HPTBS8**

Application Example: **HPTGS8**

Part Number Alterations: **HPTBS8 - SET**

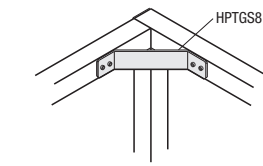

Alteration	Code	Spec.	Plates, Brackets
Applicable Screws & Nuts Set	SET	Materials	HPTTS8 SHPTTS8 HPTTD8 HPTPS8
		Set	Applicable screws and nuts for mounting each plate on extrusions come in a set.
		Low Carbon Steel	Screws: CBM Nuts: HNTT
		304 Stainless Steel	Screws: SCB Nuts: HNTTSN