

Thin Brackets

Slot Type: HFS8 Series (Aluminum Extrusions 40, 80 Square)

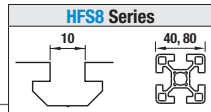

Thin Brackets



HBLSSB8
Black Anodize

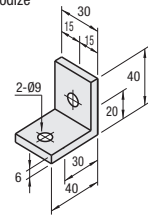

HBLSD8

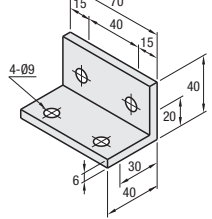

Type	Material	Surface Treatment
HBLSS8	A6N01SS-T5 Aluminum Alloy	Anodize
HBLSSB8	A6N01SS-T5 Aluminum Alloy	Black Anodize

Part Number	Mass (g)	Applicable Anodize / T Nut				Allowable Load (N)
		Screw	Qty.	T Nut	Qty.	
HBLSS8	34	CBM8-15	2	HNTT8-8	2	1666
HBLSSB8* (Black Anodize)						
HBLSD8	80		4		4	2352

* For repairing black anodizing, refer to P.2965.

Part Number Example
Part Number: **HBLSS8**

Application Example

Part Number Alterations
Part Number - (SET / SST / SEU / SSU / SEP / SSP / SEC)
HBLSD8 - P
HBLSS8 - SET
HBLSD8 - P-SET

Alterations	Code	Spec.	Applicable Brackets
Changing the Hole Location	P	Thin bracket HBLSD8 - Change the position of mounting holes 	HBLSD8

Alterations	Code	Spec.	Applicable Brackets																								
Applicable Screws & Nuts Set	SET SST (Stainless Steel) SEU (Pre-Assy. Insertion Spring Nuts) SSU (Pre-Assy. Insertion Spring Nuts Stainless Steel) SEP (Post-Assy. Insertion Spring Nuts) SSP (Post-Assy. Insertion Spring Nuts Stainless Steel) SEC (Captured Washer Screws Nuts)	Supplies a set of applicable screws and nuts for fixing the bracket to a extrusion. (Ex.) When HBLSS8 is specified, <table border="1"> <thead> <tr> <th>Code</th> <th>Screws</th> <th>Nuts</th> </tr> </thead> <tbody> <tr> <td>SET</td> <td>CBM8-15</td> <td>HNTT8-8</td> </tr> <tr> <td>SST</td> <td>SCB8-15</td> <td>HNTTSN8-8</td> </tr> <tr> <td>SEU</td> <td>CBM8-15</td> <td>HNTU8-8</td> </tr> <tr> <td>SSU</td> <td>SCB8-15</td> <td>SHNTU8-8</td> </tr> <tr> <td>SEP</td> <td>CBM8-15</td> <td>HNTP8-8</td> </tr> <tr> <td>SSP</td> <td>SCB8-15</td> <td>SHNTP8-8</td> </tr> <tr> <td>SEC</td> <td>HCBS8-20</td> <td>HNTT8-8</td> </tr> </tbody> </table> <p>⚠ When specifying other than HBLSS8, check for the applicable screws and nuts.</p>	Code	Screws	Nuts	SET	CBM8-15	HNTT8-8	SST	SCB8-15	HNTTSN8-8	SEU	CBM8-15	HNTU8-8	SSU	SCB8-15	SHNTU8-8	SEP	CBM8-15	HNTP8-8	SSP	SCB8-15	SHNTP8-8	SEC	HCBS8-20	HNTT8-8	HBLSS8 HBLSSB8 HBLSD8
	Code	Screws	Nuts																								
	SET	CBM8-15	HNTT8-8																								
	SST	SCB8-15	HNTTSN8-8																								
	SEU	CBM8-15	HNTU8-8																								
SSU	SCB8-15	SHNTU8-8																									
SEP	CBM8-15	HNTP8-8																									
SSP	SCB8-15	SHNTP8-8																									
SEC	HCBS8-20	HNTT8-8																									

⚠ Screws for black anodized parts are HCBMTB (Trivalent Chromate Black) P.2858.
 ⚠ Not RoHS compliant when -SET, -SEU or -SEP are specified.

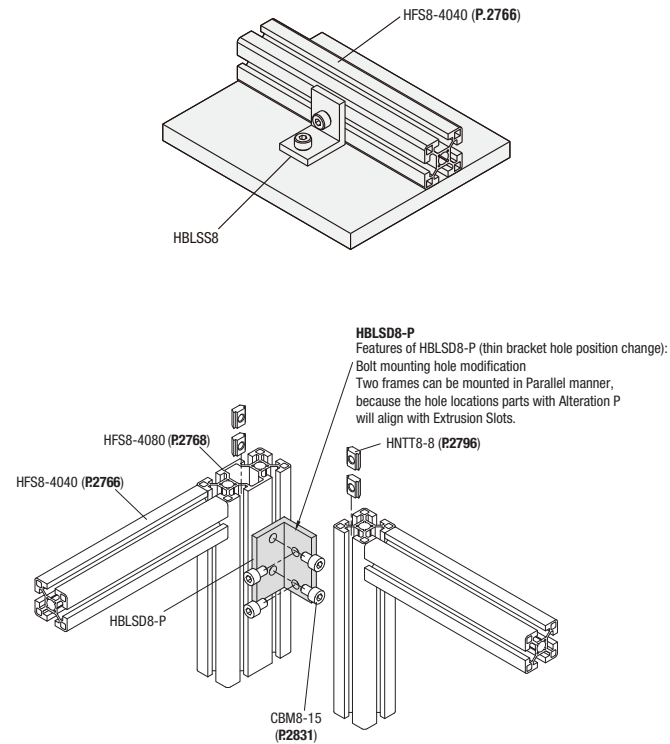

Block Brackets / Brackets for Reinforcement

Slot Type: HFS8 Series (Aluminum Extrusions 40, 80 Square)

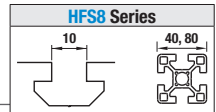

Block Brackets



HBLBL8

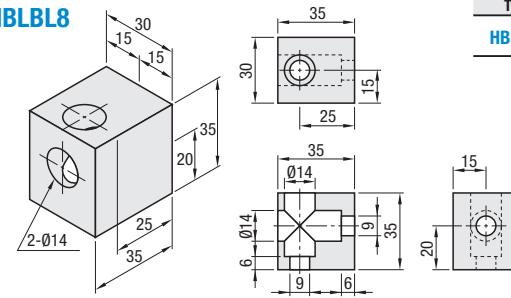

Type	Material	Surface Treatment
HBLBL8	A6N01SS-T5 Aluminum Alloy	Anodize

Part Number	Mass (g)	Applicable Screws & Nuts Set		Allowable Load (N)
		Screw	Qty.	
HBLBL8	79	CBM8-15	2	1666

Part Number Alterations
Part Number: **HBLBL8** - (SET / SST / SEU / SSU / SEP / SSP)
HBLBL8 - SET

Part Number Example
Part Number: **HBLBL8**

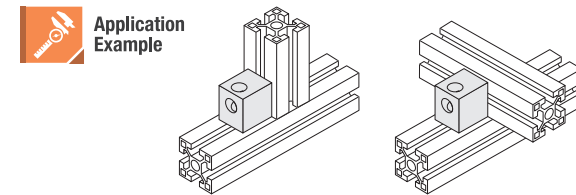

Alterations	Code	Spec.	Applicable Brackets																					
Applicable Screws & Nuts Set	SET SST (Stainless Steel) SEU (Pre-assy. Insertion Spring Nuts) SSU (Pre-assy. Insertion Spring Nuts Stainless Steel) SEP (Post-Assy. Insertion Spring Nuts) SSP (Post-Assy. Insertion Spring Nuts Stainless Steel)	Applicable screws and nuts for fixing the brackets on extrusions come in a set. <table border="1"> <thead> <tr> <th>CODE</th> <th>Screws</th> <th>Nuts</th> </tr> </thead> <tbody> <tr> <td>SET</td> <td>CBM8-15</td> <td>HNTT8-8</td> </tr> <tr> <td>SST</td> <td>SCB8-15</td> <td>HNTTSN8-8</td> </tr> <tr> <td>SEU</td> <td>CBM8-15</td> <td>HNTU8-8</td> </tr> <tr> <td>SSU</td> <td>SCB8-15</td> <td>SHNTU8-8</td> </tr> <tr> <td>SEP</td> <td>CBM8-15</td> <td>HNTP8-8</td> </tr> <tr> <td>SSP</td> <td>SCB8-15</td> <td>SHNTP8-8</td> </tr> </tbody> </table>	CODE	Screws	Nuts	SET	CBM8-15	HNTT8-8	SST	SCB8-15	HNTTSN8-8	SEU	CBM8-15	HNTU8-8	SSU	SCB8-15	SHNTU8-8	SEP	CBM8-15	HNTP8-8	SSP	SCB8-15	SHNTP8-8	HBLBL8
	CODE	Screws	Nuts																					
	SET	CBM8-15	HNTT8-8																					
	SST	SCB8-15	HNTTSN8-8																					
	SEU	CBM8-15	HNTU8-8																					
SSU	SCB8-15	SHNTU8-8																						
SEP	CBM8-15	HNTP8-8																						
SSP	SCB8-15	SHNTP8-8																						

⚠ Not RoHS compliant when -SET, -SEU or -SEP are specified.

Brackets for Reinforcement

GFBL8-4040
GFBL8-4080

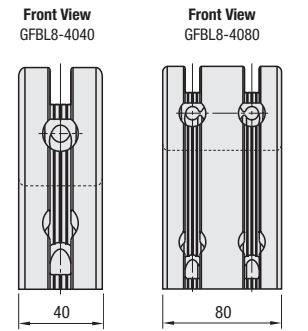
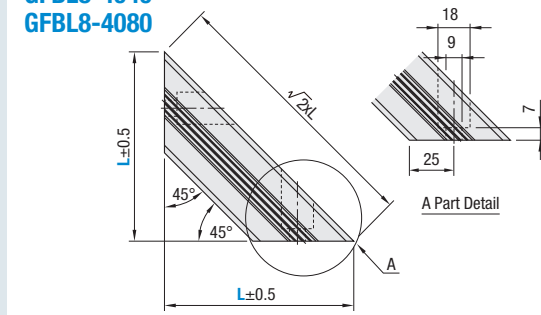

Type	Material	Surface Treatment
GFBL8	A6061SS-T6 Equivalent	Anodize

⚠ Use Washer Screw (SCBS8-20) for connecting to extrusions.
 (No surface treatment on 45° cut ends and counterbores.)

Part Number	L 1 mm Increment	Applicable Screw / Nut			
		Screw	Qty.	Nuts	Qty.
GFBL8	4040	SCBS8-20	2	HNTT8-8	2
	4080		4		4

Part Number Example
Part Number: **GFBL8-4040** - L
GFBL8-4040 - 300

Part Number Alterations
Part Number: **GFBL8-4040** - L - (SET / SST / SEU / SSU / SEP / SSP)
GFBL8-4040 - 500 - SET

Alterations	Code	Spec.	Applicable Brackets																					
Applicable Screws & Nuts Set	SET SST (Stainless Steel) SEU (Pre-assy. Insertion Spring Nuts) SSU (Pre-assy. Insertion Spring Nuts Stainless Steel) SEP (Post-Assy. Insertion Spring Nuts) SSP (Post-Assy. Insertion Spring Nuts Stainless Steel)	Applicable screws and nuts for fixing the brackets on extrusions come in a set. <table border="1"> <thead> <tr> <th>Code</th> <th>Screws</th> <th>Nuts</th> </tr> </thead> <tbody> <tr> <td>SET</td> <td>CBM8-15</td> <td>HNTT8-8</td> </tr> <tr> <td>SST</td> <td>SCB8-15</td> <td>HNTTSN8-8</td> </tr> <tr> <td>SEU</td> <td>CBM8-15</td> <td>HNTU8-8</td> </tr> <tr> <td>SSU</td> <td>SCBS8-16</td> <td>SHNTU8-8</td> </tr> <tr> <td>SEP</td> <td>CBM8-15</td> <td>HNTP8-8</td> </tr> <tr> <td>SSP</td> <td>SCB8-15</td> <td>SHNTP8-8</td> </tr> </tbody> </table> <p>⚠ Screws of Brackets for Reinforcement are SCBS8-16. (Refer to P.2383)</p>	Code	Screws	Nuts	SET	CBM8-15	HNTT8-8	SST	SCB8-15	HNTTSN8-8	SEU	CBM8-15	HNTU8-8	SSU	SCBS8-16	SHNTU8-8	SEP	CBM8-15	HNTP8-8	SSP	SCB8-15	SHNTP8-8	GFBL8-4040 GFBL8-4080
	Code	Screws	Nuts																					
	SET	CBM8-15	HNTT8-8																					
	SST	SCB8-15	HNTTSN8-8																					
	SEU	CBM8-15	HNTU8-8																					
SSU	SCBS8-16	SHNTU8-8																						
SEP	CBM8-15	HNTP8-8																						
SSP	SCB8-15	SHNTP8-8																						

⚠ Not RoHS compliant when -SET, -SEU or -SEP are specified.