

Hexagonal Rods

1045 Carbon Steel or Equivalent, 303, 304 Stainless Steel, Brass, 2011 Aluminum Alloy

Hexagonal Rods –
2011 Aluminum Alloy,
1045 Carbon Steel or Equivalent,
303 Stainless Steel,
304 Stainless Steel,
Brass

Type	Material
RDRC	1045 Carbon Steel or Equivalent
RDRF	303 Stainless Steel
RDRS	304 Stainless Steel
RDRG	C 36000 Brass
RDRA	2011 Aluminum Alloy

L Dimension Tolerance

More Than	Or Less	Tolerance
15	30	±0.2
31	120	±0.3
121	400	±0.5
401	1000	±0.8

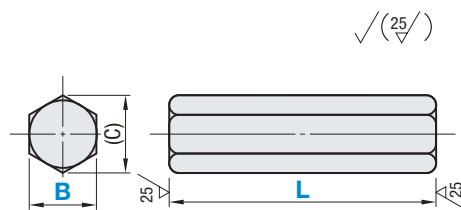

Part Numbers within are not RoHS compliant

RoHS 10

Part Number	Type	B	L Specify in 1 mm Increment	(C)
RDRC	1045 Carbon Steel or Equivalent	6	15-400	6.9
RDRF	303 Stainless Steel	7		8.1
RDRS	304 Stainless Steel	8		9.2
RDRG	C3604 Brass (JIS)	10	25-600	11.5
RDRA	2011 Aluminum Alloy	12		13.9
		13		15.0
		14	35-800	16.2
		17		19.6
		19		21.9
		24	65-1000	27.7
		27		31.2
		30		34.6
		32		36.9

Part Number Example: RDRC10 - L 300

Part Number Alterations: RDRC19 - L 535 - MC8

Alterations	One End Tapped	Both Ends Tapped																															
	MC	WMC																															
Code	MC	WMC																															
Spec.	Adds a tap on one end. Ordering Code: MC8 ① 6≤B≤32 ② When L≤Mx2, the tap goes through.	Adds taps on both ends. Ordering Code: WMC12 ① 6≤B≤32 ② When L≤Mx4, the tap goes through.																															
	<table border="1"> <thead> <tr> <th>B</th> <th>MC (Selection Range)</th> </tr> </thead> <tbody> <tr><td>6, 7</td><td>3</td></tr> <tr><td>8</td><td>3, 4</td></tr> <tr><td>10</td><td>3, 4, 5</td></tr> <tr><td>12-14</td><td>3, 4, 5, 6</td></tr> <tr><td>17, 19</td><td>3, 4, 5, 6, 8</td></tr> <tr><td>24</td><td>3, 4, 5, 6, 8, 10, 12</td></tr> <tr><td>27-32</td><td>3, 4, 5, 6, 8, 10, 12, 16</td></tr> </tbody> </table> ③ When L≤Mx4, the pilot hole for tapping may go through.	B	MC (Selection Range)	6, 7	3	8	3, 4	10	3, 4, 5	12-14	3, 4, 5, 6	17, 19	3, 4, 5, 6, 8	24	3, 4, 5, 6, 8, 10, 12	27-32	3, 4, 5, 6, 8, 10, 12, 16	<table border="1"> <thead> <tr> <th>B</th> <th>WMC (Selection Range)</th> </tr> </thead> <tbody> <tr><td>6, 7</td><td>3</td></tr> <tr><td>8</td><td>3, 4</td></tr> <tr><td>10</td><td>3, 4, 5</td></tr> <tr><td>12-14</td><td>3, 4, 5, 6</td></tr> <tr><td>17, 19</td><td>3, 4, 5, 6, 8</td></tr> <tr><td>24</td><td>3, 4, 5, 6, 8, 10, 12</td></tr> <tr><td>27-32</td><td>3, 4, 5, 6, 8, 10, 12, 16</td></tr> </tbody> </table>	B	WMC (Selection Range)	6, 7	3	8	3, 4	10	3, 4, 5	12-14	3, 4, 5, 6	17, 19	3, 4, 5, 6, 8	24	3, 4, 5, 6, 8, 10, 12	27-32
B	MC (Selection Range)																																
6, 7	3																																
8	3, 4																																
10	3, 4, 5																																
12-14	3, 4, 5, 6																																
17, 19	3, 4, 5, 6, 8																																
24	3, 4, 5, 6, 8, 10, 12																																
27-32	3, 4, 5, 6, 8, 10, 12, 16																																
B	WMC (Selection Range)																																
6, 7	3																																
8	3, 4																																
10	3, 4, 5																																
12-14	3, 4, 5, 6																																
17, 19	3, 4, 5, 6, 8																																
24	3, 4, 5, 6, 8, 10, 12																																
27-32	3, 4, 5, 6, 8, 10, 12, 16																																

Steel Pipes

Selectable Inner Diameter / Wall Thickness

Pipes –
Configurable Inner Diameter



RoHS 10

Type	Material	Surface Treatment
PISS	1050 Steel or Equivalent	—
PISK		Black Oxide
PISN		Electroless Nickel Plating

L Dimension Tolerance

More Than	Or Less	Tolerance
10	99	±0.1
100	120	±0.3
121	400	±0.5
401	1000	±0.8

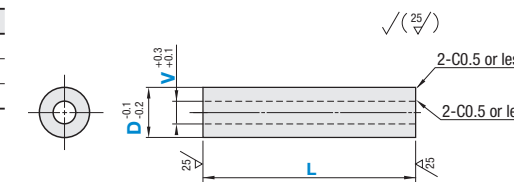

End faces of PISK and PISN are not surface-treated.

Part Number	Type	D	V	L Specify in 1 mm Increment
PISS No Treatment		6	3 4	10-1000
		8	3 4 5 6	
		10	3 4 5 6 8	
		12	3 4 5 6 8 10	
		13	5 6 8 10	
		14	4 5 6 8 10	
		15	4 5 6 8 10 12	
		16	4 5 6 8 10 12	
		20	5 6 8 10 12 15 16	
		25	6 8 10 12 15 16 20	
PISK Black Oxide		6	3 4	10-1000
		8	3 4 5 6	
		10	3 4 5 6 8	
		12	3 4 5 6 8 10	
		13	5 6 8 10	
		14	4 5 6 8 10	
		15	4 5 6 8 10 12	
		16	4 5 6 8 10 12	
		20	5 6 8 10 12 15 16	
		25	6 8 10 12 15 16 20	
PISN Electroless Nickel Plating		6	3 4	10-1000
		8	3 4 5 6	
		10	3 4 5 6 8	
		12	3 4 5 6 8 10	
		13	5 6 8 10	
		14	4 5 6 8 10	
		15	4 5 6 8 10 12	
		16	4 5 6 8 10 12	
		20	5 6 8 10 12 15 16	
		25	6 8 10 12 15 16 20	

Part Number Example: PISS20 - V 10 - L 400

Part Number Alterations: PISS20 - V 8 - L 400 - MC

Alterations	One End Tapped	Both Ends Tapped	L Dimension Tolerance																																																																																																																																																									
	MC	WMC																																																																																																																																																										
Code	MC	WMC	LKC																																																																																																																																																									
Spec.	Adds a tap on one end. Ordering Code: MC	Adds taps on both ends. Ordering Code: WMC	Changes L Dimension Tolerance Ordering Code: LKC																																																																																																																																																									
	<table border="1"> <thead> <tr> <th>D</th> <th>V</th> <th>3</th> <th>4</th> <th>5</th> <th>6</th> <th>8</th> <th>10</th> <th>12</th> <th>15</th> <th>16</th> <th>20</th> <th>25</th> </tr> </thead> <tbody> <tr><td>6</td><td>M4</td><td></td><td></td><td></td><td></td><td></td><td></td><td></td><td></td><td></td><td></td><td></td></tr> <tr><td>8</td><td>M4</td><td>M5</td><td></td><td></td><td></td><td></td><td></td><td></td><td></td><td></td><td></td><td></td></tr> <tr><td>10</td><td>M4</td><td>M5</td><td></td><td></td><td></td><td></td><td></td><td></td><td></td><td></td><td></td><td></td></tr> <tr><td>12</td><td>M4</td><td>M5</td><td>M8</td><td>M8</td><td></td><td></td><td></td><td></td><td></td><td></td><td></td><td></td></tr> <tr><td>13</td><td></td><td></td><td>M8</td><td>M8</td><td>M10</td><td></td><td></td><td></td><td></td><td></td><td></td><td></td></tr> <tr><td>14</td><td></td><td>M6</td><td>M8</td><td>M8</td><td>M10</td><td></td><td></td><td></td><td></td><td></td><td></td><td></td></tr> <tr><td>15</td><td></td><td>M6</td><td>M8</td><td>M8</td><td>M10</td><td></td><td></td><td></td><td></td><td></td><td></td><td></td></tr> <tr><td>16</td><td></td><td>M8</td><td>M8</td><td>M8</td><td>M10</td><td>M12</td><td></td><td></td><td></td><td></td><td></td><td></td></tr> <tr><td>20</td><td></td><td></td><td>M10</td><td>M10</td><td>M10</td><td>M12</td><td></td><td></td><td></td><td></td><td></td><td></td></tr> <tr><td>25</td><td></td><td></td><td></td><td>M10</td><td>M10</td><td>M12</td><td>M16</td><td>M18</td><td>M20</td><td></td><td></td><td></td></tr> <tr><td>30</td><td></td><td></td><td></td><td></td><td></td><td></td><td>M12</td><td></td><td></td><td></td><td></td><td></td></tr> </tbody> </table> L L Tolerance 100-300 ±0.05 301-500 ±0.10 ⊗ Not applicable to L>500	D	V	3	4	5	6	8	10	12	15	16	20	25	6	M4												8	M4	M5											10	M4	M5											12	M4	M5	M8	M8									13			M8	M8	M10								14		M6	M8	M8	M10								15		M6	M8	M8	M10								16		M8	M8	M8	M10	M12							20			M10	M10	M10	M12							25				M10	M10	M12	M16	M18	M20				30							M12				
D	V	3	4	5	6	8	10	12	15	16	20	25																																																																																																																																																
6	M4																																																																																																																																																											
8	M4	M5																																																																																																																																																										
10	M4	M5																																																																																																																																																										
12	M4	M5	M8	M8																																																																																																																																																								
13			M8	M8	M10																																																																																																																																																							
14		M6	M8	M8	M10																																																																																																																																																							
15		M6	M8	M8	M10																																																																																																																																																							
16		M8	M8	M8	M10	M12																																																																																																																																																						
20			M10	M10	M10	M12																																																																																																																																																						
25				M10	M10	M12	M16	M18	M20																																																																																																																																																			
30							M12																																																																																																																																																					
	⊗ Not applicable to "—"																																																																																																																																																											

Pipes –
Wall Thickness
Selectable Stainless
Steel Pipes



RoHS 10

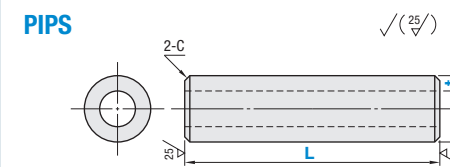

C Dimension

More Than	Or Less	C
D3	D16	0.5
D20	D30	1.0

L Dimension Tolerance

More Than	Or Less	Tolerance
10	30	±0.2
31	120	±0.3
121	400	±0.5
401	1000	±0.8

Material: 304 Stainless Steel (Drawn Pipe)

For maximum L dimension in each D dimension, refer to the specification table.

Part Number	Type	D	t	L Specify in 1 mm Increment
PIPS		3	0.5 1	10-250
		4	0.5 1	
		5	0.5 1 1.5	
		6	0.5 1 1.5 2	
		8	0.5 1 1.5 2	
		10	0.5 1 1.5 2 2.5 3	10-500
		13	0.5 1 1.5 2 2.5 3	
		15	1 1.5 2 2.5 3 4	
		16	1.5 2 2.5 3 4 5	
		20	2 2.5 3 4 5 6	
		25	2.5 3 4 5 6	10-1000
		30	3 4 5 6	

Part Number Example: PIPS4 - t 1 - L 125