

Cap Screws

Hexagon Socket Button Head (Box)

Cap Screws – Hexagon Socket Button Head (Box)



RoHS10

Type	Material	Hardness	Surface Treatment
BOX-BCB	4137 Alloy Steel	34~44 HRC min.	Black Oxide
BOX-SBCB	304 Stainless Steel or Equivalent	—	—

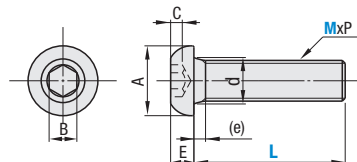

M x P (Coarse)	A	E	B	C (Min.)	d	(e)
3 x 0.5	5.7	1.65	2	1.04	3.6	1
4 x 0.7	7.6	2.2	2.5	1.3	4.7	1.4
5 x 0.8	9.5	2.75	3	1.56	5.7	1.6
6 x 1.0	10.5	3.3	4	2.08	6.8	2

ⓘ When you order, please specify the box quantity. Minimum order is 1 box.

Part Number Example
 Part Number
 BOX-BCB5-10
 BOX-SBCB5-10

Part Number		Pcs./Box
Type	M - L	
BOX-BCB	3 - 5	1,000
	6	
	8	
	10	
	12	
	15	
	20	
	25	
	30	
	4 - 6	500
	8	
	10	
	12	
	15	
	20	
25		
30		
5 - 8	200	
10		
12		
15		
20		
25		
30		
6 - 10	500	
12		
15		
20		
25		
30		

Part Number		Pcs./Box
Type	M - L	
BOX-SBCB Stainless Steel	3 - 5	1,000
	6	
	8	
	10	
	12	
	15	
	20	
	25	
	30	
	4 - 6	500
	8	
	10	
	12	
	15	
	20	
25		
30		
5 - 8	200	
10		
12		
15		
20		
25		
30		
6 - 10	500	
12		
15		
20		
25		
30		

Cap Screws

Hexagon Socket Flat Head (Box)

Cap Screws – Hexagon Socket Flat Head (Box)



RoHS10

Type	Material
BOX-SFB	304 Stainless Steel or Equivalent

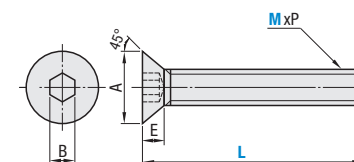

M x P (Coarse)	A		E (Max.)	B
	Min.	Max.		
2x0.4	3.7	4.0	1.2	1.3
2.5x0.45	4.7	5.0	1.5	1.5
3x0.5	5.54	6.72	1.86	2.0
4x0.7	7.53	8.96	2.48	2.5
5x0.8	9.43	11.2	3.1	3.0
6x1.0	11.34	13.44	3.72	4.0
8x1.25	15.24	17.92	4.96	5.0
10x1.5	19.22	22.4	6.2	6.0

ⓘ Available as a single item and in package.

ⓘ When you order, please specify the box quantity. Minimum order is 1 box.

Part Number Example
 Part Number
 BOX-SFB5-10

Part Number		Pcs./Box	
Type	M - L		
BOX-SFB Stainless Steel	2 - 4	500	
	5		
	6		
	3 - 5	2,000	
	6		
	8		
	10		
	12		
	15		
	20	500	
	25		
	30		
	4 - 8		1,000
	10		
	12		
15			
5 - 10	500		
12			
15			
20			
6 - 10		300	
12			
15			
20			
25			
30			
9 - 12	200		
15			
20			
25			
30			
10 - 15		100	
20			
25			
30			