

Cap Screws

Hexagon Socket Low Head / Extra Low Head (Box)

Cap Screws – Hexagon Socket Low Head (Box)



RoHS10

Hexagon Socket Low Head Cap Screws

Type	Material	Strength Class
BOX-CBSST	304 Stainless Steel or Equivalent	A2-50

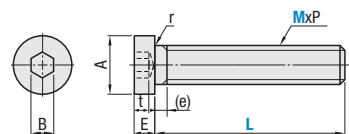

M x P	A	E	B	t max.	r
2x0.4	3.8	1.3	1.3	1	0.1 or More
2.5x0.45	4.5	1.6	1.5	1.3	0.1 or More
3x0.5	5.5	2	2	1.5	0.1 or More
4x0.7	7	2.8	2.5	2.3	0.2 or More
5x0.8	8.5	3.5	3	2.7	0.2 or More
6x1.0	10	4	4	3	0.25 or More
8x1.25	13	5	5	3.8	0.4 or More
10x1.5	16	6	6	4.5	0.4 or More
12x1.75	18	7	8	5	0.6 or More

Can be ordered as single item. P.2393

Cap Screws – Extra Low Head (Box)



RoHS10

Hexagon Socket Extra Low Head Cap Screws

Type	Material	Tensile Strength
BOX-CBSTS	304 Stainless Steel Equivalent	400 N/mm ²

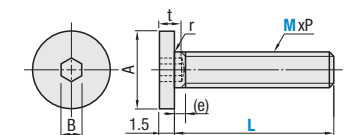

M x P	A	B	t max.	(e) max.	r
2x0.4	4	1.3	1.2	1.2	0.1 or More (0.2 or More)
2.5x0.45	5	1.3	1.5	1.5	
3x0.5	6	1.5	2	1.6	
4x0.7	8	2	2.5	1.6	0.2 or More
5x0.8	9	3	3	2	
6x1.0	10	3	4	2.5	0.25 or More (0.2 or More)
8x1.25	13	4	5	3	
10x1.5	16 (15)	5	6	3.5	0.4 or More (0.2 or More)

Can be ordered as single item. P.2394

When you order, please specify the box quantity. Minimum order is 1 box.

Part Number Example
 Part Number
 BOX-CBSST5-10
 BOX-CBSTS5-10

Part Number		ℓ	Pcs/Box
Type	M - L		
BOX-CBSST Stainless Steel	3 - 6	Fully Threaded Screws	1,000
	8		
	10		
	12		
	16		
	20		
	4 - 6	Fully Threaded Screws	500
	8		
	10		
	12		
	16		
	20		
5 - 8	Fully Threaded Screws	300	
10			
12			
16			
20			
25			
6 - 8	Fully Threaded Screws	250	
10			
12			
16			
20			
25			
8 - 10	Fully Threaded Screws	200	
12			
16			
20			
25			
30	Fully Threaded Screws	150	
10 - 16			
20			
25			

Part Number		ℓ	Pcs/Box
Type	M - L		
BOX-CBSTS Stainless Steel	3 - 5	Fully Threaded Screws	500
	6		
	8		
	10		
	12		
	16		
	4 - 5	Fully Threaded Screws	200
	6		
	8		
	10		
	12		
	16		
5 - 6	Fully Threaded Screws	150	
8			
10			
12			
16			
20			
6 - 8	Fully Threaded Screws	200	
10			
12			
16			
20			
25			
8 - 10	Fully Threaded Screws	150	
12			
16			
20			
25			
10 - 16	Fully Threaded Screws	150	
20			
25			

Cover Screws

Socket Head (Box)

Cover Screws – Socket Head Type (Box)



RoHS10

Type	Material	Strength Class
BOX-GUTB	304 Stainless Steel or Equivalent	A2-70 Equivalent

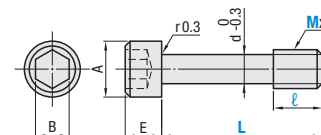

M x P (Coarse)	A	E	B	d
3 x 0.5	5.5	3	2.5	2.2
4 x 0.7	7	4	3	3
5 x 0.8	8.5	5	4	3.9
6 x 1.0	10	6	5	4.5
8 x 1.25	13	8	6	6.3

When you order, please specify the box quantity. Minimum order is 1 box.

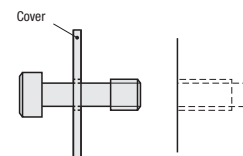

The screw will not drop off from the cover when the cover is removed from the frame.
 (The cover requires tap machining to prevent screw from falling off.)

Part Number Example
 Part Number
 BOX-GUTB5-6-20

* The strength class signifies the screw's tensile strength.
 (Ex.) A2 - 70
 This indicates that the minimum value of tensile strength is 700 N/mm².
 The steel class is A2 (Austenitic Stainless Steel)

Part Number				Pcs./Box
Type	M	ℓ	L	
BOX-GUTB Stainless Steel	3	4	10	200
			12	
			15	
			20	
			8	
	4	3	10	
			12	
			15	
			10	
			12	
	4	5	10	
			12	
15				
20				
12				
5	6	10		
		15		
		20		
		25		
		30		
6	8	20		
		25		
		30		
		25		
		40		
8	10	25		
		30		
		40		