

Angle Plates

Side A (Base Surface) Machining Specified Type

Angle Plates – Side A (Base Surface) Machining Specified Type

Hole Machining Selection FB No Hole Type



Hole Machining Selection D Through Hole Type



Hole Machining Selection K Through & Dowel Hole Type



RoHS10

Type	Hole Machining Selection	Material	Surface Treatment
IKC		Alloy Cast Iron Class No.35	Primer Coating (Gray)
BIKC	FB No Through Hole	Alloy Cast Iron Class No.35	Black Oxide
MIKC	D Through Hole		Electroless Nickel Plating
AIKC	K Through Holes and Dowel Holes		—
AIKC		Aluminum Casting Alloy 514.0	—

- ⓘ Cast Iron Class No.35: Surface treatment is not applied to the machined surfaces and holes.
- ⓘ A dimension is ground from the gusset side. Please note that, as shown in the photo, no surface treatment is applied on the gusset side.
- ⊗ BIKC is not selectable.

Hole Machining Selection FB Without Hole

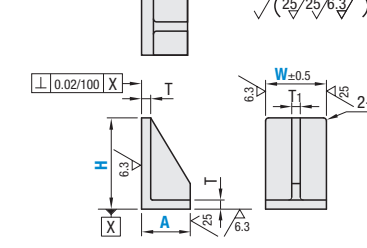

Part Number Type	H	Angle Plate Body			T	T ₁	
		A 5 mm Increment	W Selection				
IKCFB BIKCFB MIKCFB AIKCFB	100	50	75	80	100	14	
		80-100	75	80	100	14	
	150	65-75	60	75	100	14	
		80-100	75	80	100	14	
200	65-75	60	75	100	15	14	
	85-120	75	80	100	15	14	
	250	85-120	75	80	100	18	15
	300	90-150	75	80	100	18	15
350	90-150	75	80	100	18	15	
	400	90-150	75	80	100	18	15

⊗ For AIKCFB, W60 is not available.

Hole Machining Selection D Through Holes

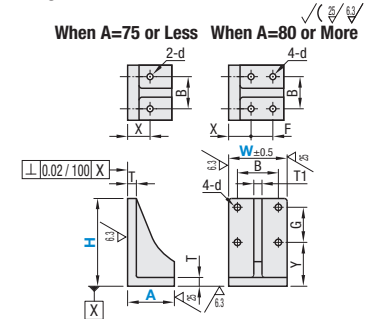

Part Number Type	H	Angle Plate Body			Through Hole											
		A 5 mm Inc.	W Selection		T	T ₁	d			X	F	Y	G			
IKCD BIKCD MIKCD AIKCD	100	50	75	80	100	15	14	W=60	W=75/80/100	W=60	W=75/80	W=100	X	F	Y	G
		80-100	60	75	100	15	14	9	11	40	50	70	35	A-50	45	40
	150	65-75	60	75	100	15	14	9	11	40	50	70	35	A-50	75	60
		80-100	75	80	100	15	14	9	11	40	50	70	40	A-50	110	70
	200	65-75	60	75	100	15	14	9	11	40	50	70	40	A-50	140	90
		85-120	75	80	100	15	14	9	11	40	50	70	40	A-55	190	90
		250	85-120	75	80	100	18	15	11	11	50	70	40	A-60	230	100
		300	90-150	75	80	100	18	15	11	11	50	70	40	A-60	260	120
	350	90-150	75	80	100	18	15	11	11	50	70	40	A-60	230	100	
		400	90-150	75	80	100	18	15	11	11	50	70	40	A-60	260	120

⊗ For AIKCD, W60 is not available.

ⓘ Portions without specific dimensions is same as FB (Without Hole Type).

Hole Machining Selection K Through & Dowel Holes

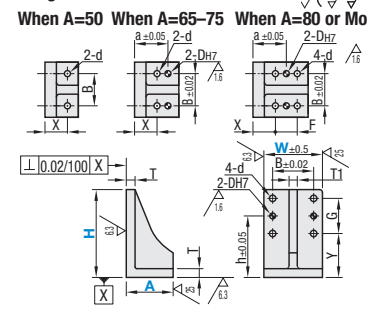

Part Number Type	H	Angle Plate Body			Through Hole							Dowel Hole								
		A 5 mm Inc.	W Selection		T	T ₁	d			X	F	Y	G	D _{H7}	a	h				
IKCK MIKCK AIKCK	100	50	75	80	100	15	14	W=60	W=75/80/100	W=60	W=75/80	W=100	X	F	Y	G	D _{H7}	a	h	
		80-100	60	75	100	15	14	9	11	40	50	70	35	A-50	45	40	10	X+(F/2)	65	
	150	65-75	60	75	100	15	14	9	11	40	50	70	35	A-50	75	60	6	10	A-15	105
		80-100	75	80	100	15	14	9	11	40	50	70	40	A-50	110	70	6	10	X+(F/2)	145
	200	65-75	60	75	100	15	14	9	11	40	50	70	40	A-50	140	90	6	10	X+(F/2)	185
		85-120	75	80	100	15	14	9	11	40	50	70	40	A-55	190	90	6	10	X+(F/2)	235
		250	85-120	75	80	100	18	15	11	11	50	70	40	A-60	230	100	10	10	X+(F/2)	280
		300	90-150	75	80	100	18	15	11	11	50	70	40	A-60	260	120	10	10	X+(F/2)	320
	350	90-150	75	80	100	18	15	11	11	50	70	40	A-60	230	100	10	10	X+(F/2)	280	
		400	90-150	75	80	100	18	15	11	11	50	70	40	A-60	260	120	10	10	X+(F/2)	320

⊗ For AIKCK, W60 is not available.

ⓘ Portions without specific dimensions is same as FB (Without Hole Type).

⊗ BIKCK is not selectable.

Part Number Example: IKCFB100 - A85 - W75

Part Number Alterations: IKCD100 - A85 - W75 - MC

Alteration	Code	Spec.
Side H Tapped Hole Size Change	MC	Changes the holes 4-d (Through Holes) on side H to tapped holes. d MC 9 M8 11 M10 Ordering Code: MC

H	A	Available Types								
		Without Hole				Through Hole			Through Holes & Dowel Holes	
		Cast Iron Class No.35	Alum. Casting Alloy 514.0	Cast Iron Class No.35	Alum. Casting Alloy 514.0	Cast Iron Class No.35	Alum. Casting Alloy 514.0	Cast Iron Class No.35	Alum. Casting Alloy 514.0	Cast Iron Class No.35
100	50	•	•	•	•	•	•	•	•	•
	80-100	•	•	•	•	•	•	•	•	•
150	65-75	•	•	•	•	•	•	•	•	•
	80-100	•	•	•	•	•	•	•	•	•
200	65-75	•	•	•	•	•	•	•	•	•
	85-120	•	•	•	•	•	•	•	•	•
250	85-120	•	•	•	•	•	•	•	•	•
	300	•	•	•	•	•	•	•	•	•
350	90-150	•	•	•	•	•	•	•	•	•
	400	•	•	•	•	•	•	•	•	•

Angle Plates

Opposite Angle Dowel Type / Wide Type

Angle Plates – Opposite Angle Dowel Type



RoHS10

Type	Material	Surface Treatment
IKKB	Cast Iron Class No.35	Primer Coating
AIKKB	Aluminum Casting Alloy 514.0	—

- ⓘ Cast Iron Class No.35 Surface treatment is not applied to the machined surfaces and holes.

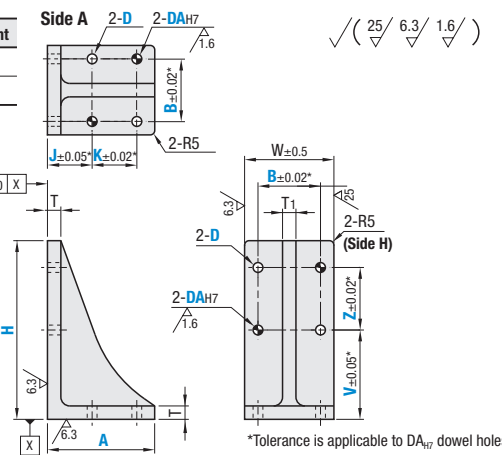

*Tolerance is applicable to DA_{H7} dowel holes.

Part Number Type	H	A	D Selection	DA Selection	Angle Plate Body			Side A & H		Side A		Side H		Available Types	
					W	T	T ₁	B	J	K	V	Z	IKKB	AIKKB	
IKKB AIKKB	100	*50S	4 5 6 3 4 5	3 4 5	50	8	30	25	10	45	40	•	•		
		100	7 9 11 6 8 10	6 8 10	100	15	14	70	45	40	45	40	•	•	
		50	4 5 6 3 4 5	3 4 5	50	8	30	25	10	45	40	45	40	•	•
		75	7 9 11 6 8 10	6 8 10	100	15	14	70	45	40	75	60	•	•	
		100	7 9 11 6 8 10	6 8 10	75	15	14	50	40	20	75	60	•	•	
		100	7 9 11 6 8 10	6 8 10	100	15	14	70	45	40	75	60	•	•	
	200	75	7 9 11 6 8 10	6 8 10	75	15	14	50	40	20	110	70	•	•	
		120	7 9 11 6 8 10	6 8 10	100	18	15	70	50	50	140	90	•	•	
		250	120	7 9 11 6 8 10	6 8 10	100	18	15	70	50	190	90	•	•	
		300	150	7 9 11 6 8 10	6 8 10	100	18	15	70	50	230	100	•	•	
		350	150	7 9 11 6 8 10	6 8 10	100	18	15	70	50	260	120	•	•	
		400	150	7 9 11 6 8 10	6 8 10	100	18	15	70	50	260	120	•	•	

Part Number Example: IKKB150 - A100 - D7 - DA10

Angle Plates – Wide Type



RoHS10

Type	Mounting Holes	Material	S
WIKFB	No Hole	Cast Iron Class No.35	Primer Coating
WIKD	With Mounting Holes		
WIKK	With Mounting Holes/ Dowel Holes		

- ⓘ Surface treatment is not applied to the machined surfaces and holes.

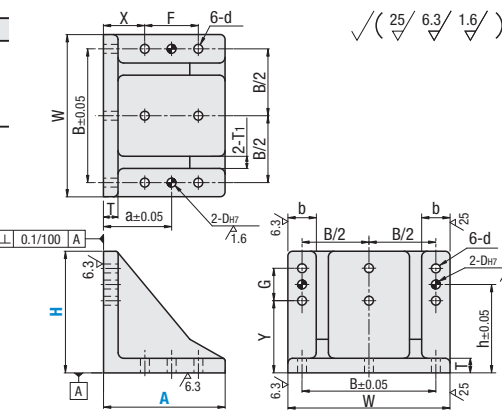

Part Number Type	H	A	W	T	T ₁	B	a	X	F	h	Y	G	D _{H7}	b	d
WIKD	150	100	200	18	15	165	84	51	66	109	89	40	10	35	11
WIKK	150	150	200	18	15	165	84	51	66	109	89	40	10	35	11

Part Number Example: WIKD100 - A

Application Example

