

# Indexing Plungers

Coarse Threaded / Fine Threaded Lever

## Coarse Threaded Plunger



RoHS10

Type	Screw	Lever		Main Body		Pin		Spring	Lock Nuts		
		Material	Surface Treatment	Material	Surface Treatment	Material	Hardness	Surface Treatment	Material	Material	Surface Treatment
PMXRB	Coarse Thread	1045 Carbon Steel or Equivalent	Black Oxide	1045 Carbon Steel or Equivalent	Black Oxide	1045 Carbon Steel or Equivalent	45 HRC min.	Black Oxide	304 Stainless Steel-WPB	JIS-SWCH Carbon Steel	Black Oxide
PMXRM		Electroless Nickel Plating	Electroless Nickel Plating	Electroless Nickel Plating	Electroless Nickel Plating						

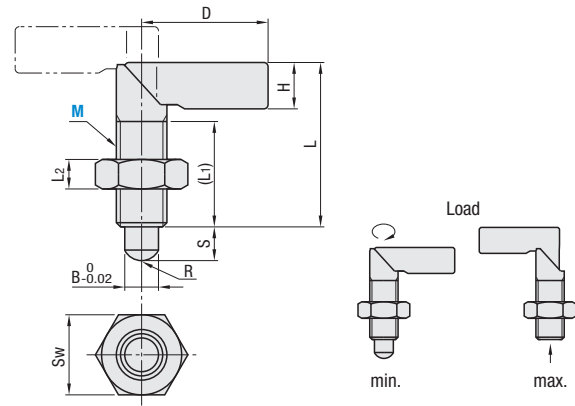

Part Number Type	M	Pitch (Coarse)	B	S	L	(L1)	D	H	L2	Sw	R	Load (N)		Mass (g)
												min.	max.	
PMXRB	10	1.5	5	5	34	20	24	8	6	17	3	5	9.5	22
PMXRM	12	1.75	6	6	39	25	30	11	7	19	3.5	8	13	33

kgf=Nx0.101972

Part Number Example: PMXRB10

## Fine Threaded Plunger



RoHS10

Type	Lever Cap Material	Main Body		Pin		Spring	(Lock Nut)		
		Material	Surface Treatment	Material	Hardness	Surface Treatment	Material	Material	Surface Treatment
PXVB	Nylon 6 (Mat Black)	12L13 Carbon Steel	Black Oxide	1045 Carbon Steel or Equivalent	50-60 HRC min.	Black Oxide	JIS SWP-B Spring Steel	1045 Carbon Steel or Equivalent	Black Oxide
PXVBK		303 Stainless Steel	—	303 Stainless Steel	—	Nickel Plating	301 Stainless Steel	303 Stainless Steel	—
SPXVB									
SPXVBK									

PXVB  
SPXVB

With Lock Nut  
PXVBK  
SPXVBK

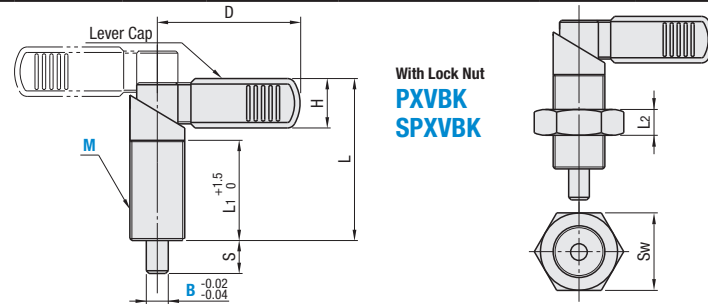

Part Number Type	M	Pitch (Fine Thread)	B	S	L	L1	D	H	L2	Sw			
											Steel	Stainless Steel	16
PXVB	SPXVB	20	1.5	8	10	12	12	59	36	52	19	10	30

Part Number Example: PXVB16 - 8, SPXVBK20 - 12

### Mass and Load

kgf=Nx0.101972

M	B	Mass (g)	Load (N)	
			min.	max.
16	6	79	12	32
	8	80		
	10	82		
20	8	112	21	58
	10	115		
	12	118		

# Indexing Plungers

Switch Lever / Push / Plate Mounted Plunger

## Indexing Plungers – Switch Lever Type



RoHS10

Type	Thread Type	Lever		Main Body		Pin		Spring	Lock Nut		
		Material	Surface Treatment	Material	Surface Treatment	Material	Hardness	Surface Treatment	Material	Material	Surface Treatment
PMXSR	Coarse Thread	1045 Carbon Steel or Equivalent	Black Oxide	1018 Carbon Steel or Equivalent	Black Oxide	1045 Carbon Steel or Equivalent	HV min. 500-600	Black Oxide	304 Stainless Steel	1018 Carbon Steel or Equivalent	Black Oxide
PXSR	Fine Thread										

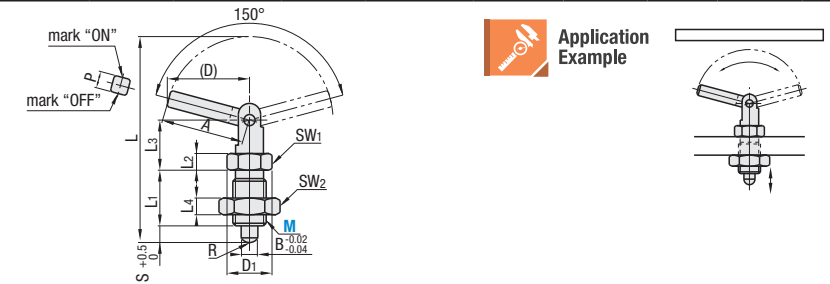

Part Number Type	M	Pitch		(d)	D1	S	B	L	L1	L2	L3	L4	Sw1	Sw2	A	P	R	Load (N)	
		(Coarse Thread)	(Fine Thread)															min.	max.
PMXSR Coarse	12	1.75	1.5	30	16.1	6	6	74	20	6	18	7	14	19	30	6	3.5	12.0	26.0
PXSR Fine	16	2	1.5	40.5	21.9	8	8	99.9	26	8	24.9	10	19	24	41	8	4.5	18.0	39.0
	20	2.5	1.5	49.5	27.7	10	10	123	33	10	30	12	24	30	50	10	6	27.0	58.5

Part Number Example: PXSR12

## Push Plunger



RoHS10

Type	Screw	Button	Shaft	Main Body 1		Main Body 2		Pin		Spring	Lock Nut	
		Material	Material	Material	Surface Treatment	Material	Material	Hardness	Surface Treatment	Material	Material	Surface Treatment
PMXPB	Coarse Thread	Nylon 6 (Black)	Polyacetal (White)	1045 Carbon Steel or Equivalent	Black Oxide	Nylon 6 (Black)	1045 Carbon Steel or Equivalent	HV min. 500-600	Black Oxide	304 Stainless Steel	JIS-SWCH Carbon Steel	Black Oxide
PMXPM					Electroless Nickel Plating				Electroless Nickel Plating		304 Stainless Steel	

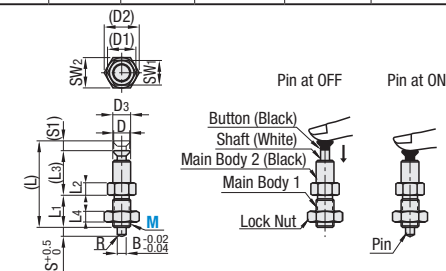

### Features

One finger operation is possible, which significantly reduces work area in the upper part of the button. Push the button to turn the status "ON" (button color is black); push it again to return the status to "OFF" (button color is black and white).

Part Number Type	M	Pitch (Coarse)	D	(D1)	(D2)	D3	S	B	(L)	L1	L2	(L3)	L4	(S1)	SW1	SW2	R	Load (N)	
																		min.	max.
PMXPB	10	1.5	9	16.1	19.6	10	5	5	47.5	18	7	24	6	5.5	14	17	3	2.2	3.0
PMXPM	12	1.75	11	19.6	21.9	12	6	6	53	20	7	26.5	7	6.5	17	19	3.5	2.0	3.9
	16	2	15	24.3	27.7	16	8	8	68	25	8	34.5	10	8.5	21	24	4.5	1.3	5.4

Part Number Example: PMXPB10

## Plate Mounted Plunger



RoHS10

Type	Knob	Main Body		Pin		Spring	
	Material	Material	Surface Treatment	Material	Hardness	Surface Treatment	Material
PXSP	Polyacetal	1045 Carbon Steel or Equivalent	Black Oxide	1045 Carbon Steel or Equivalent	50-60 HRC min. (Carburized)	Black Oxide	631 Stainless Steel
PXSPL							

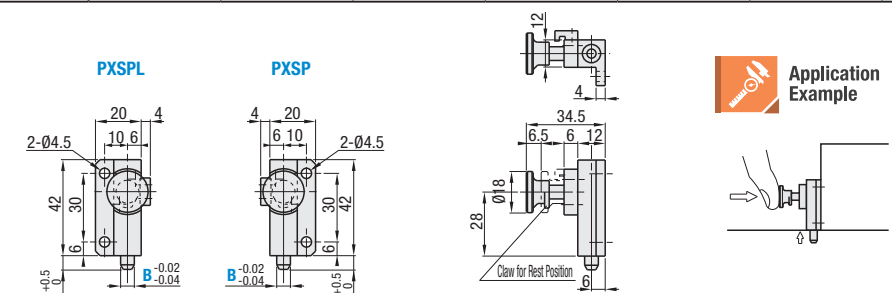

Part Number Type	B	Load (N)	
		min.	max.
PXSP	6	0.1	1.9
PXSPL			

Part Number Example: PXSP6