

Ball Roller Units



RoHS 10

Type	Ball Roller		Material				Frame
	Shape	Part Number P.1198	Bearing	Spacer	Main Ball	Sub Balls	
BUHL	Hex Head Stud Type	BCHL16	304 Stainless Steel	304 Stainless Steel	440C Stainless Steel 55 HRC min.	440C Stainless Steel 55 HRC min.	6063 Aluminum Alloy Clear Anodized
BUHA	Press-Fit Type	BCHA24	304 Stainless Steel	304 Stainless Steel	440C Stainless Steel 55 HRC min.	440C Stainless Steel 55 HRC min.	6063 Aluminum Alloy Clear Anodized

Ball Rollers Details, P.1198.

Hex Head Stud

BUHL
Stainless Steel Ball

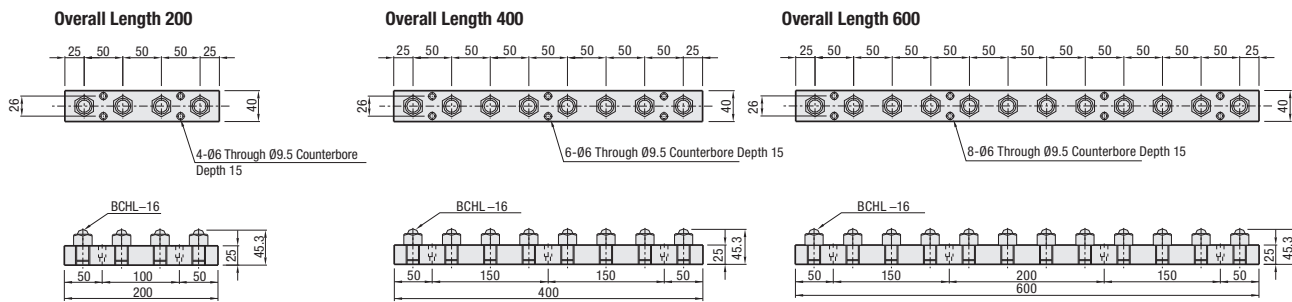

Press-Fit

BUHA
Stainless Steel Ball

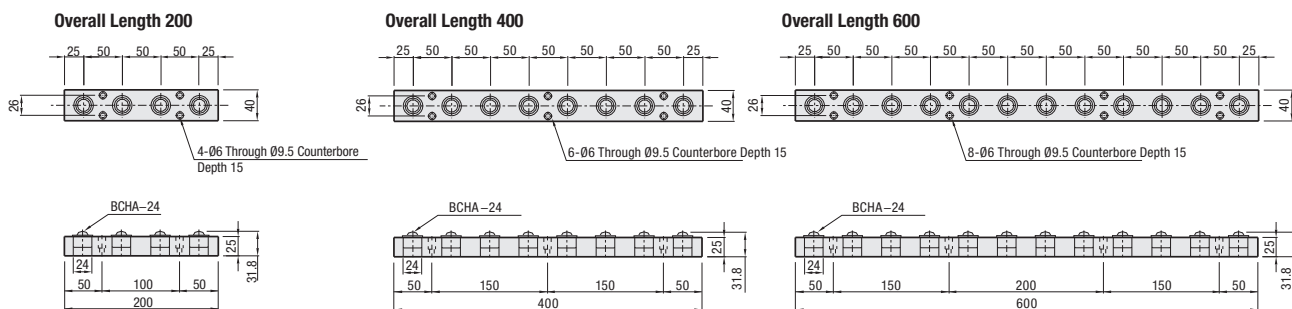

Part Number	Full Length	Number of Rollers
Hex Head Stud Type BUHL Stainless Steel Balls	200	4
Press-Fit Type BUHA Stainless Steel Balls	400	8
	600	12

Allowable Load per Ball Roller

Type	Allowable Load N (kgf)
BUHL BUHA	343 (35)



Application Example

*Ball Roller Units can allow 360 degree transfer of objects as shown below.

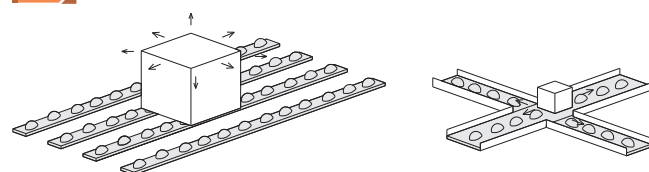

Part Number Example **BUHL200**

Ball Rollers / Press Formed Ball Rollers

Milled Threaded Stud / Steel Press Formed / Press Fit / Flange Mounting / Screw Mounted / Threaded Stud Type

Ball Rollers – Milled Threaded Stud Type



RoHS 10

BCHG

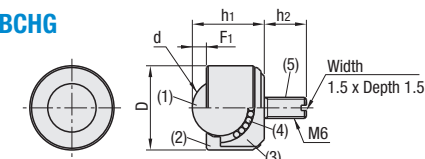

BCHO

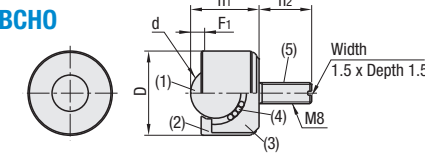

BCHT

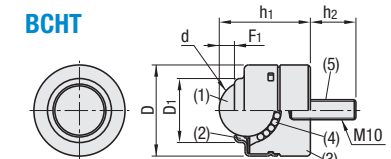

Type	Material				
	(1) Main Ball	(2) Spacer	(3) Ball Roller	(4) Sub Balls	(5) Threaded Section
BCHG	52100 Bearing Steel	1018 Carbon Steel	SCM415 Alloy Steel (JIS)	52100 Bearing Steel	SCM415 Alloy Steel (JIS)
BCHO	52100 Bearing Steel	Low Carbon Steel	SCM415 Alloy Steel (JIS)	52100 Bearing Steel	4137 Alloy Steel or Equivalent
BCHT	52100 Bearing Steel	Low Carbon Steel	SCM415 Alloy Steel (JIS)	52100 Bearing Steel	4137 Alloy Steel or Equivalent

Part Number		D	D ₁	d	h ₁	h ₂	F ₁	Allowable Load N (kgf)
Type	No.							
BCHG	24	24	—	15.875	20.5	12	4	196.1 (20)
BCHO	32	32	—	19.05	26	20	4	490.3 (50)
BCHT	42	42	31.3	25.40	42	21	7.4	784.5 (80)

Ball Rollers – Steel Press Formed Type Press Fit Type



RoHS 10

BCHW

Press-Fit

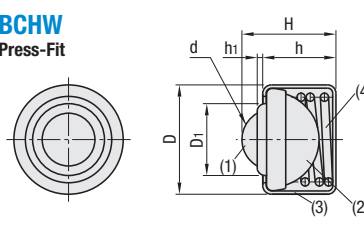

BCHY

Flange Mounting Type

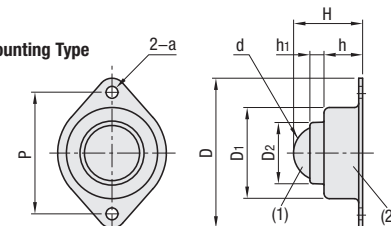

Type	Material			
	(1) Main Ball	(2) Body	(3) Frame	(4) Spring
BCHW	52100 Bearing Steel	Low Carbon Steel	Low Carbon Steel	Spring Steel (ASTM A228)
BCHY	SWRM12 (JIS)	—	—	—

Part Number		D	D ₁	D ₂	d	H	h	h ₁	P	Spring Ball Movement	Allowable Load N (kgf)
Type	No.										
BCHW	20	20	13	—	11.113	17.2	13.4	2.8	—	1.8	49 (5Kg)
	26	25.8	17.5	—	15.875	23.6	17.5	3.7	—	2	78 (8Kg)
BCHY	69	69	42	29.5	25.40	31	17	7.5	56	—	294 (30Kg)

Press Formed Screw Mounted / Threaded Stud Type



RoHS 10

BCHC

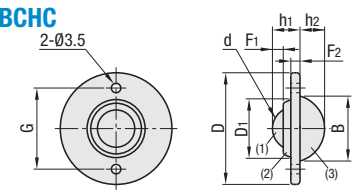

BCHE

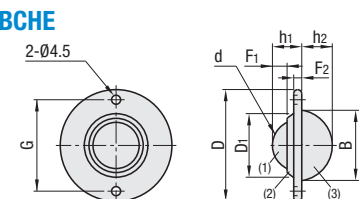

BCHH

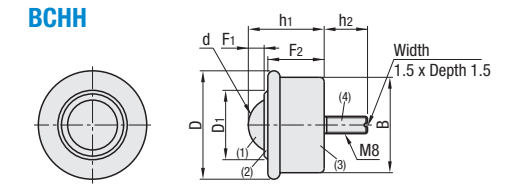

Type	Material			
	(1) Main Ball	(2) Spacer	(3) Ball Roller	(4) Threaded Section
BCHC	SWRM12 (JIS)	Low Carbon Steel	304 Stainless Steel	—
BCHE	SWRM12 (JIS)	Low Carbon Steel	Low Carbon Steel Equivalent	1018 Carbon Steel or Equivalent
BCHH	SWRM12 (JIS)	Low Carbon Steel	Low Carbon Steel Equivalent	1018 Carbon Steel or Equivalent

Part Number		D	D ₁	d	G	B	h ₁	h ₂	F ₁	F ₂	Allowable Load N (kgf)
Type	No.										
BCHC	40	41.3	22	15.875	30	24	10.2	9.1	4	3.4	78.5 (8)
BCHE	55	55.5	32.5	25.40	45.5	36	14.6	15.2	7.3	4	294.2 (30)
BCHH	50	50	32	25.40	—	44	35	20	7.3	26	294.2 (30)

Part Number Example **BCHW 20**