

# Low Dust Raise Greased Bearings with Housings

## Double Bearings

Low Dust Raise Greased Bearings with Housings – Double Bearings

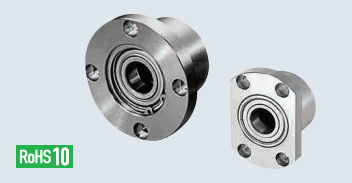

RoHS10

Retained		Unretained		Material		Surface Treatment	
Round	Compact	Compact		Bearings	Housing	Bearings	Housing
S-SBARB	S-SBACB	S-SBACC		Stainless Steel	2000 Series Aluminum Alloy	Clear Anodize	Electroless Nickel Plating
—	—	S-SBAMCC			304 Stainless Steel or Equivalent		
S-SBGRB	—	S-SBGCC					

6.3/(1.6/)

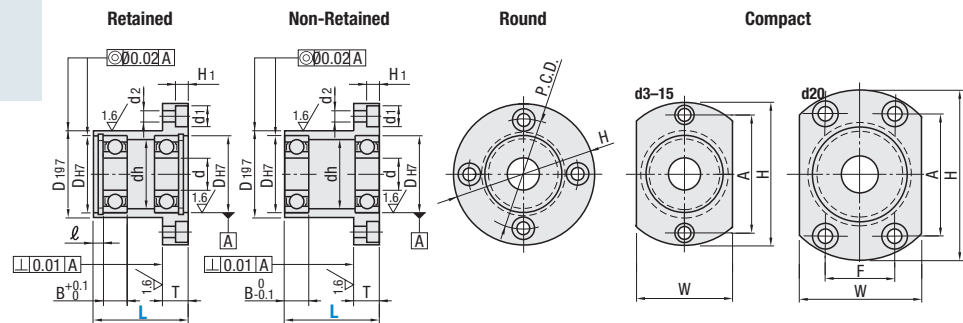

Bearing Accuracy JIS B 1514 Class 0 Accessories: Retaining Ring (304 Stainless Steel)

Part Number		L Selection	d	D <sub>17</sub>	Tolerance	B	ℓ	H	W	T	dh	D <sub>17</sub>	Tolerance	P.C.D.	A	F	d <sub>1</sub>	d <sub>2</sub>	H <sub>1</sub>		
Retained (Round)	623ZZ	20 30	3	10	+0.015 0	4	2.65	33	16	7	7	14	-0.006 -0.024	24	24	—	6.5	3.5	3.1		
	624ZZ	20 30	4	13	+0.018 0	5	2.65	35	18	7	9	17	-0.007 -0.028	26	26	—	8	4.5	4.1		
	605ZZ	20 30	5	14		10	18	26	26												
	625ZZ	25 30	5	16		12	20	28	28												
	606ZZ	20 35	6	17	13	21	29	29	8	19	27	35	35								
	608ZZ	25 35	8	22	18	27	35	35	10	22	32	-0.009 -0.034	40	40	9.5					5.5	5.1
	6900ZZ	25 40	10	26	22	32	40	40													
	6000ZZ	25 40	10	30	24	36	44	44													
	6200ZZ	30 40	12	28	21	30	38	38													
	6901ZZ	25 40	12	24	24	34	42	42													
	6001ZZ	25 40	12	28	25	35	45	45													
	6201ZZ	30 40	15	32	28	38	46	46													
6902ZZ	25 50	15	28	25	35	45	45														
6002ZZ	30 50	20	32	28	38	48	48														
6202ZZ	35 50	20	37	29	42	52	52														
6904ZZ	35 50	20	37	34	45	56	51	24													
6004ZZ	40 50	20	42	36	50	64	56	32													
6204ZZ	45 50	20	47	40	54	68	59	34													

Bearing No.	Available Types					
	Retained (Round)		(Compact)	Non-Retained (Compact)		
	S-SBARB	S-SBGRB	S-SBACB	S-SBACC	S-SBAMCC	S-SBGCC
623ZZ	•	•	•	•	•	•
624ZZ	•	•	•	•	•	•
605ZZ	•	•	•	•	•	•
625ZZ	•	•	•	•	•	•
606ZZ	•	•	•	•	•	•
608ZZ	•	•	•	•	•	•
6900ZZ	•	•	•	•	•	•
6000ZZ	•	•	•	•	•	•
6200ZZ	•	•	•	•	•	•
6901ZZ	•	•	•	•	•	•
6001ZZ	•	•	•	•	•	•
6201ZZ	•	•	•	•	•	•
6902ZZ	•	•	•	•	•	•
6002ZZ	•	•	•	•	•	•
6202ZZ	•	•	•	•	•	•
6904ZZ	•	•	•	•	•	•
6004ZZ	•	•	•	•	•	•
6204ZZ	•	•	•	•	•	•

Part Number Example: Part Number - L  
S-SBACB6900ZZ - 25

Application Example: See Application Example on P.975, 977, 979. Low Dust Raise Greased Bearings on P.1034.

Part Number Alterations: Part Number - L - (NA)  
S-SBACB6900ZZ - 25 - NA

Alteration	Bearings, Retaining Rings Not Assembled
Code	NA
Spec.	Bearing and retaining ring are shipped unassembled to the housing.

# Bearings with Housings

## L-Shaped, Retained

Bearings with Housings – L-Shaped, Retained

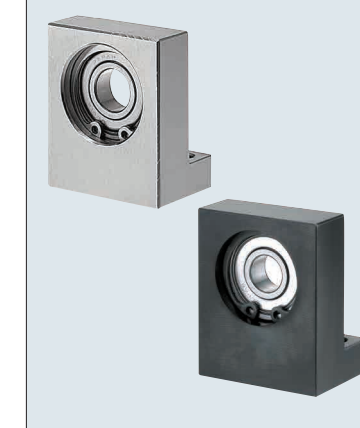

Type		Material		Surface Treatment		Accessory Retaining Ring	
Selectable h	Configurable h	Bearings	Housing	Housing		Retaining Ring	
BGLKB	BGLFB	Steel	1045 Carbon Steel or Equivalent	Black Oxide		Spring Steel	
BGLK	BGLF			Electroless Nickel Plating		304 Stainless Steel or Equivalent	
BGLKA	BGLFA			Clear Anodize		304 Stainless Steel or Equivalent	
BGLKSA	BGLFSA	Stainless Steel	2000 Series Aluminum Alloy	Clear Anodize		304 Stainless Steel or Equivalent	
BGLKS	BGLFS			—		—	

\* Bearings with Rubber Seals (VV and DD) are all made of steel.

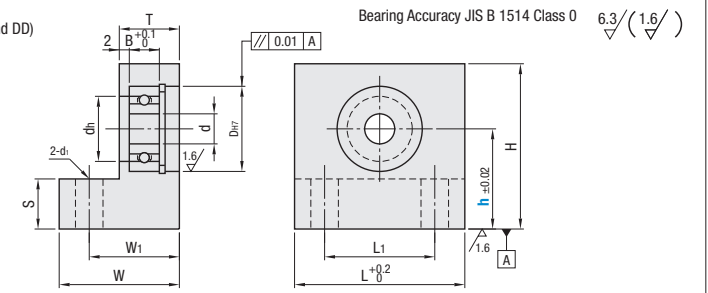

Bearing Accuracy JIS B 1514 Class 0 6.3/(1.6/)

Type	Bearing No.	Seal	h		d	D <sub>17</sub>	Tolerance	dh	B	H	L	L <sub>1</sub>	W	W <sub>1</sub>	T	S	d <sub>1</sub>
			h Selection	Configurable 1 mm Increment													
h Selectable	623	ZZ Double Shielded	15 20 25	15-30	3	10	+0.015 0	7	4	h+9	20	10	20	15	10	5	4.5
	624				4	13	9	5	h+11	22	12	20	15	10			
	605				5	14	10	5	h+11	24	14	20	15	10			
	625				6	16	12	5	h+12	28	16	22	16	10			
	606				6	17	13	6	h+13	34	22	24	18	12			
	626				6	19	15	6	h+14	36	24	24	18	12			
	608				6	22	18	7	h+15	38	26	24	18	12			
	628				8	24	20	8	h+16	34	22	27	21	15			
	6900				10	22	19	6	h+15	32	20	24	18	12			
	6000				10	26	22	8	h+17	38	26	27	21	15			
	6200				12	30	24	9	h+19	40	28	27	21	15			
	h Configurable				6901	*VV Non-Contact Rubber Sealed	25 30 40	25-40	12	28	+0.021 0	21	6	h+16	36		
6001		24	8	h+18	40				28	27	21	15					
6201		32	10	h+20	42				30	28	22	16					
6902		15	28	+0.025 0	25				7	h+18	42	30	24	18	12		
6002		15	32	+0.025 0	28				9	h+20	50	36	29	22	15		
6202		15	35	+0.025 0	29				11	h+22	44	30	31	24	17		
6903		17	30	+0.021 0	27				7	h+19	42	30	26	20	13		
6003		17	35	+0.025 0	31				10	h+22	50	36	31	24	16		
6203		20	40	+0.025 0	34				12	h+24	48	36	33	26	20		
6904		20	37	+0.025 0	34				9	h+23	45	31	29	22	15		
6004		20	42	+0.025 0	36				12	h+25	54	38	35	27	19		
6204		25	47	+0.025 0	40				14	h+28	60	44	36	28	20		
6005	25	47	+0.030 0	41	12	h+28	62	46	35	27	19						
6205	30	52	+0.030 0	45	15	h+31	70	50	42	32	22						
6006	30	55	+0.030 0	48	13	h+32	74	54	40	30	20						
6206	30	62	+0.030 0	55	16	h+36	82	62	43	33	23						

\*No. 623, 624, 605 and 606 are not available for VV (Non-contact Sealed).

Bearing No.	Available Types										
	h Selectable						h Configurable				
	BGLKB	BGLK	BGLKA	BGLKSA	BGLKS	BGLFB	BGLF	BGLFA	BGLFSA	BGLFS	
623	•	•	•	•	•	•	•	•	•	•	•
624	•	•	•	•	•	•	•	•	•	•	•
605	•	•	•	•	•	•	•	•	•	•	•
625	•	•	•	•	•	•	•	•	•	•	•
606	•	•	•	•	•	•	•	•	•	•	•
626	•	•	•	•	•	•	•	•	•	•	•
608	•	•	•	•	•	•	•	•	•	•	•
628	•	•	•	•	•	•	•	•	•	•	•
6900	•	•	•	•	•	•	•	•	•	•	•
6000	•	•	•	•	•	•	•	•	•	•	•
6200	•	•	•	•	•	•	•	•	•	•	•
6901	•	•	•	•	•	•	•	•	•	•	•
6001	•	•	•	•	•	•	•	•	•	•	•
6201	•	•	•	•	•	•	•	•	•	•	•
6902	•	•	•	•	•	•	•	•	•	•	•
6002	•	•	•	•	•	•	•	•	•	•	•
6202	•	•	•	•	•	•	•	•	•	•	•
6903	•	•	•	•	•	•	•	•	•	•	•
6003	•	•	•	•	•	•	•	•	•	•	•
6203	•	•	•	•	•	•	•	•	•	•	•
6904	•	•	•	•	•	•	•	•	•	•	•
6004	•	•	•	•	•	•	•	•	•	•	•
6204	•	•	•	•	•	•	•	•	•	•	•
6005	•	•	•	•	•	•	•	•	•	•	•
6205	•	•	•	•	•	•	•	•	•	•	•
6006	•	•	•	•	•	•	•	•	•	•	•
6206	•	•	•	•	•	•	•	•	•	•	•

Part Number Example: Part Number - h  
Type Bearings Seal - h  
BGLKA 6000 DD - 30  
BGLFA 6904 ZZ - 45

Part Number Alterations: Part Number - h - (KCC / KCC / NA)  
BGLF6000ZZ - 30 - KCC

Alterations	C Chamfer	C2 Chamfer	Bearings, Retaining Rings Not Assembled
Code	KKC	KCC	NA
Spec.	C chamfer (45°) on both top edge corners. Ordering Code: KKC 	C2 chamfered is done on the top edge surface. 	Bearing and retaining ring are shipped unassembled to the housing.