

# Linear Guides for Medium Load

With Plastic Retainers / Interchangeable – Light Preload

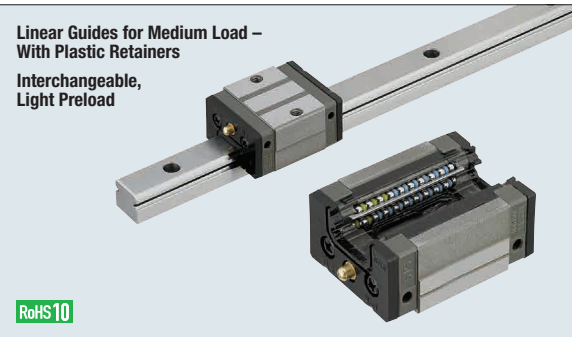

	Type		Block	Rail	L Dimensions	Material Hardness
	1 Block	2 Blocks				
Standard	SVRZ	SV2RZ	SVRB	SRZL	Selectable	Carbon Steel 58 HRC min.
	SVRLZ	SV2RLZ		SRZLF	Configurable	
Wide Block Through Holes	SVWZ	SV2WZ	SVWB	SRZL	Selectable	
	SVWLZ	SV2WLZ		SRZLF	Configurable	
Wide Block Tapped Holes	SVWTZ	SV2WTZ	SVWTB	SRZL	Selectable	
	SVWTLZ	SV2WTLZ		SRZLF	Configurable	

Heat Resistant Temperature: 0–50°C

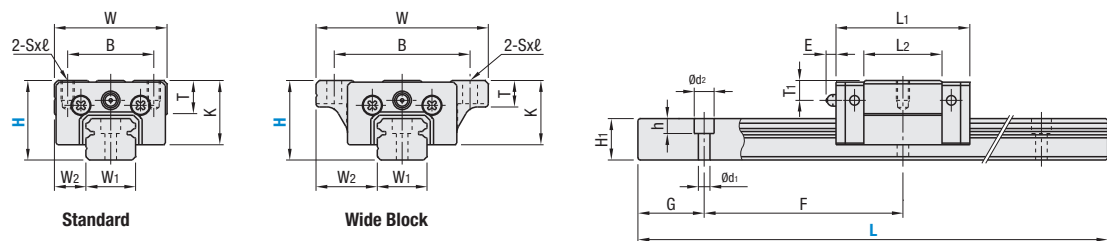
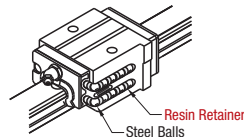

For L Dimension Configurable Type, G dimensions differ from those shown in the table below. For details, see P.608.

### Precautions for Use

- Blocks are equipped with retainers (wire) to prevent balls from derailing. For blocks P.602.
- For Interchangeable, Light Preload Type, rails and blocks can be interchanged.
- Straight grooves are provided on datum planes. Be sure to match the datum lines when using.
- Rails cannot be connected end to end.
- Running parallelism is the value measured after the rail is mounted (it is not the value measured before the rails are fastened with screws.).

### Others

- Filled with Lithium soap based grease (Alvania Grease S2 by Showa Shell Sekiyu K.K.).
- Grease Fittings: Straight Type for H24 and Angled Type for H28, H33 and H42.
- Grease Fitting is screw-in type, and thus, can be repositioned.
- For Operating Life Calculation P.604.

	Part Number		H	L	Block Dimensions										Guide Rail Dimensions					
	Type				W	L <sub>1</sub>	B	S x l	L <sub>2</sub>	K	T	Grease Fittings			H <sub>1</sub>	W <sub>1</sub>	W <sub>2</sub>	Counterbored Holes d <sub>1</sub> x d <sub>2</sub> x h	F	G
	1 Block	2 Blocks										Mounting Holes	E	T <sub>1</sub>						
Standard	SVRZ	SV2RZ	24	100–1480 (160)	34	40.4	26	M4 x 6	23.6	19	10	∅3	3	6	12.5	15	9.5	3.5 x 6 x 4.5	60	20
	SVRLZ	SV2RLZ	28	160–1960 (220)	42	47.2	32	M5 x 7	30	22	12	M6 x P0.75	11	5.5	15.5	20	11	6 x 9.5 x 8.5	60	20
	Blocks SVRB	Balls SRZL SRZLF	33	200–1960 (280)	48	59.6	35	M6 x 9	38	26	12	M6 x P0.75	11	7	18	23	12.5	7 x 11 x 9	60	20
			42	200–1960 (280)	60	67.4	40	M8 x 12	42	33	13	M6 x P0.75	11	8	23	28	16	7 x 11 x 9	80	20
Wide Block	SVWZ	SV2WZ	24	100–1480 (160)	52	40.4	41	4.5 (M5)	23.6	19	8	∅3	3	6	12.5	15	18.5	3.5 x 6 x 4.5	60	20
	SVWLZ	SV2WLZ	28	160–1960 (220)	59	47.2	49	5.5 (M6)	30	22	10	M6 x P0.75	11	5.5	15.5	20	19.5	6 x 9.5 x 8.5	60	20
	SVWTLZ	SV2WTLZ	33	200–1960 (280)	73	59.6	60	7 (M8)	38	26	11	M6 x P0.75	11	7	18	23	25	7 x 11 x 9	60	20
	Blocks SVWB SVWTB	Rails SRZL SRZLF	42	200–1960 (280)	90	67.4	72	9 (M10)	42	33	11	M6 x P0.75	11	8	23	28	31	7 x 11 x 9	80	20

L Dimension: Dimensions in ( ) are for the minimum rail length of the 2-Block Type.  
S x l Dimensions: Dimensions in ( ) are for Wide Block Type Tapped Hole.

Part Number Example: SVRZ28 - L - 820

# Linear Guides for Medium Load

With Plastic Retainers / Interchangeable – Light Preload, *continued*

Part Number Alterations: SVRZ28 - L - RLC

Alterations	Code	Specifications									
Rail End Cut LLC	Left End Cut LLC	Cuts rail ends. Ordering Code: LLC									
	Right End Cut RLC										
		<table border="1"> <thead> <tr> <th>H</th> <th>L Cut</th> <th>N</th> </tr> </thead> <tbody> <tr> <td>24</td> <td rowspan="4">10</td> <td rowspan="4">10</td> </tr> <tr> <td>28</td> </tr> <tr> <td>33</td> </tr> <tr> <td>42</td> </tr> </tbody> </table>	H	L Cut	N	24	10	10	28	33	42
H	L Cut	N									
24	10	10									
28											
33											
42											
		<ul style="list-style-type: none"> <li>Applicable to Selectable Type only.</li> <li>Overall length will be shorter by cutting.</li> </ul>									
3-Block Specifications	B3	Add 2 Blocks to 1-block product to ship as 3-block separate item. Selection Example: SVRZ24-400-B3									
4-Block Specifications	B4	Add 3 Blocks to 1-block product to ship as 4-block separate item. Selection Example: SVRZ24-400-B4									

### Position of Grease Fitting

(Reference plane on the front side)

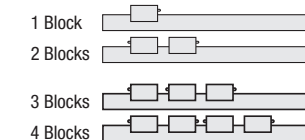

### Selectable Shortest Rail Length

H	B3 (3-Block)	B4 (4-Block)
24	280	340
28	340	400
33	340	400
42	360	440

H	Basic Load Rating		Allowable Static Moment			Mass		Guide Rails kg/m
	C (Dynamic) kN	Co (Static) kN	Ma N-m	Mb N-m	Mc N-m	Block kg		
						Standard	Wide	
24	4.9	7.8	21	18	39	0.14	0.17	1.4
28	7.25	11.8	40	34	80	0.19	0.24	2.3
33	12.7	20.8	96	81	164	0.34	0.44	3.1
42	18.7	29.6	153	128	282	0.58	0.76	4.8

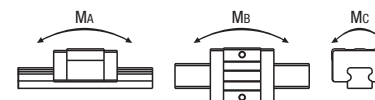

### Options for Linear Guide

Linear Guide Clamps	Rail Height Adjusting Blocks
Block Derailment Prevention Parts / Cover Caps	Block / Rail Fixing Parts

### Preload & Accuracy Standards

Interchangeable, Light Preload Type	
Radial Clearance (µm)	
H24, 28	-4–0
H33, 42	-5–0

Dimension Precision (µm)	Interchangeable
Height H Tolerance	±20
Pair Variation of Height H	15
Width W <sub>2</sub> Tolerance	±30
Pair Variation of Width W <sub>2</sub>	25
Running Parallelism of Plane C against Plane A	Refer to P.602
Running Parallelism of Plane D against Plane B	

