

Miniature Linear Guides (Long Blocks)

Light Preload / Slight Clearance

Similar Products Comparison Points

The most basic type among all the industry standard specifications. Select from Light Preload Types with superior precision and rigidity.

Material Hardness	Type			MX (Lubrication Unit)	L Dimension	Number of Blocks
	Light Preload		Slight Clearance			
	High Grade	Precision Grade	Standard Grade			
Stainless Steel 56 HRC min.	SSELB	SSELBV	SSELBZ	Blank: None -MX: Provided	Selectable	1
	SSEL2B	SSEL2BV	SSEL2BZ			2
	SSELBL	SSELBLV	SSELBLZ		Configurable	1
	SSEL2BL	SSEL2BLV	SSEL2BLZ			2

Heat Resistant Temperature: -20~80°C
 Ⓢ For L Configurable, G dimensions differ from those shown in the table below. For details, P.608.
 Ⓢ H6 is for High Grade only.

Features: Long Block Type of industry standard specifications. Higher load ratings and allowable moments than standard blocks.

H6 Type

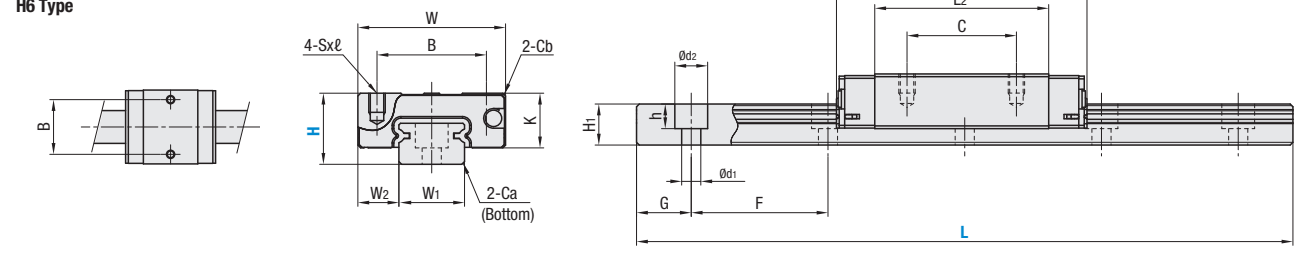

Precautions for Use

- Ⓢ Blocks are equipped with retainers (wire) to prevent balls from falling out. For proper block handling, refer to P.602.
- Ⓢ Radial clearances and accuracies are not guaranteed if the blocks and rails are interchanged from the original set combinations.
- Ⓢ Straight grooves are provided on datum planes. When using, be sure to match the datum lines.
- Ⓢ Rails cannot be connected end to end.
- Ⓢ The accuracy of Linear Guides is guaranteed after mounting the rail (fastening screws on the rail and pushing it onto the datum plane). Minor bending of the rail will be adjusted after being mounted and will not affect the performance.

Accessories

- H6 comes with Number 0, Class 1 Phillips button head screws (M2x6).
- H8 comes with cap screws (M2x6).

Others

- Filled with Lithium soap based grease (Multemp Grease PS2 by Kyodo Yushi Co., Ltd.).
- For operating life calculations, please refer to P.604, or by using our free software at, http://www.misumiusa.com/lg-bs_software/

Part Number	Type	MX	H	L	Block Dimensions								Guide Rail Dimensions							
					W	L ₁	B	C	S x ℓ	L ₂	K	Cb	W ₁	W ₂	H ₁	Ca	Counterbored Holes d ₁ x d ₂ x h	F	G	
SSELB SSELBV SSELBZ SSEL2B SSEL2BV SSEL2BZ SSELBL SSELBLV SSELBLZ SSEL2BL SSEL2BLV SSEL2BLZ	Blank: None -MX: Provided	—	6	40-100 (70)	12	21	8	—	M2 x 1.5	13.3	4.5	0.3	5	3.5	4	0.3	2.4 x 3.5 x 1	15	5	
			8	40-130 (85)	17	32	12	13	M2 x 2.5	22	6.5	0.3	7	5	4.7	0.3	2.4 x 4.2 x 2.3	15	5	
			10	55-275 (95)	20	40	15	16	M3 x 3	29	7.8	0.3	9	5.5	5.5	0.3	3.5 x 6 x 3.5	20	7.5	
			13	70-470 (120)	27	45.8	20	20	M3 x 3.5	31.8	10	0.5	12	7.5	7.5	0.5	3.5 x 6 x 4.5	25	10	
			16	110-670 (150)	32	58.3	25	25	M3 x 4	43.3	12	0.5	15	8.5	9.5	0.5	3.5 x 6 x 4.5	40	15	
20	160-700 (220)	40	67.7	30	30	M4 x 6	52.3	15	0.5	20	10	11	0.5	6 x 9.5 x 5.5	60	20				

Ⓢ L Dimension: Dimensions in () are for the minimum rail length of the 2-Block Type
 kgf=Nx0.101972 Unit: μm

H	Basic Load Rating		Allowable Static Moment			Mass	
	C (Dynamic) kN	Co (Static) kN	M _x N·m	M _y N·m	M _z N·m	Blocks kg	Guide Rails kg/m
6	0.6	1.0	1.8	1.8	2.3	0.005	0.13
8	1.6	2.4	7.5	7.5	9.0	0.016	0.19
10	2.2	3.7	12.3	12.3	13.0	0.03	0.31
13	3.5	5.3	24.5	26.4	32.3	0.06	0.61
16	5.8	8.7	57.8	62.6	67.6	0.10	1.02
20	7.2	13.5	80.7	80.7	138.2	0.18	1.65

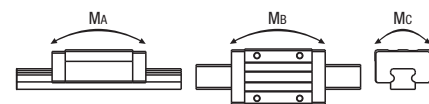

Preload & Accuracy Standards

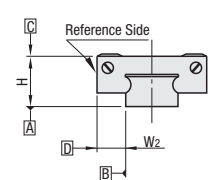

Specifications	Light Preload High Grade	Light Preload Precision Grade	Slight Clearance Standard Grade
Radial Clearance	-3-0		0-15
Height H Tolerance	±20	±10	±20
Height H Pair Variation	15	7	40
Width W ₂ Tolerance	±25	±15	±25
Width W ₂ Pair Variation	20	10	40
Running Parallelism of surf. C against surf. A	Refer to P.602		
Running Parallelism of surf. D against surf. B	Refer to P.602		

Ⓢ Slight Clearance Type has clearance (Gap) between rails and blocks. If precision / rigidity is required, select Light Preload Type.

Lubrication Unit MX

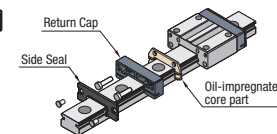

Miniature Linear Guides (Long Blocks)

Light Preload / Slight Clearance, continued

Part Number Example

Part Number - L
 SSELB10 - 275
 RSELB10 - 75 L Type Greased
 SSELB10L - 75 G Type Greased
 SSELB10G - 75

Low Temperature Black Chrome Plating and various Grease types available as alternative

Part Number Alterations

Part Number - L - (MC / RLC / LLC)
 SSEL2BL16 - 450 - MC

Alterations	Code	Spec.												
Tapped Holes	MC	Changes rail mounting holes from counterbored holes to tapped holes. <table border="1"> <tr><th>H</th><th>MC</th></tr> <tr><td>6</td><td>M2.6</td></tr> <tr><td>8</td><td>M3</td></tr> <tr><td>10</td><td>M4</td></tr> <tr><td>13</td><td>M5</td></tr> <tr><td>16</td><td>M6</td></tr> </table>	H	MC	6	M2.6	8	M3	10	M4	13	M5	16	M6
H	MC													
6	M2.6													
8	M3													
10	M4													
13	M5													
16	M6													
Rail Ends Cut	Left End Cut LLC Right End Cut RLC	Cuts rail ends. Ordering Code: LLC <table border="1"> <tr><th>H</th><th>L Cut</th><th>N</th></tr> <tr><td>10</td><td>2.5</td><td>5</td></tr> <tr><td>13</td><td>5</td><td>5</td></tr> <tr><td>16</td><td>10</td><td>5</td></tr> </table> <ul style="list-style-type: none"> Ⓢ Applicable to Selectable Type only. Ⓢ Overall length will be shorter by cutting. Ⓢ Not applicable to H6, 8, 20. 	H	L Cut	N	10	2.5	5	13	5	5	16	10	5
H	L Cut	N												
10	2.5	5												
13	5	5												
16	10	5												
Parallel Use of 2 Rails	WC	Pair variation of Height H between 2 rails is set within 15μm. Rails are shipped in pairs. <ul style="list-style-type: none"> Ⓢ Must be ordered in quantities of 2. Ⓢ Applicable to High Grade Type only. Ⓢ Not applicable to low temperature chrome plated products. 												
3-Block Specifications	B3	Adds 2-blocks to the 1-block product. <ul style="list-style-type: none"> Ⓢ There are restrictions for the L dimension length. See "Selectable Shortest Rail Length" for details. Selection Example: SSELB10-215-B3 												
4-Block Specifications	B4	Adds 3-blocks to the 1-block product. <ul style="list-style-type: none"> Ⓢ There are restrictions for the L dimension length. See "Selectable Shortest Rail Length" for details. Selection Example: SSELBZ13-220-B4 												

Selectable Shortest Rail Length for B3/B4

H	B3 (3-block)	B4 (4-block)
6	85	—
8	115	—
10	155	195
13	170	220
16	230	270
20	280	340

Options for Linear Guide

Positioning Retaining Parts	Block / Rail Fixing Parts
	Rail Push Plates
Rail Height Adjusting Blocks 	Linear Lock
Rail Height Adjusting Blocks 	Linear Guide Lock Units
Stopper Bolts 	