

Brackets / Blind Brackets

Slot Type: HFS8-45 Series (Aluminum Extrusions 45, 90 mm Square)

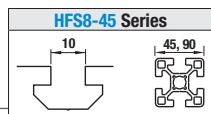

Features: No need for alterations to hide brackets inside of the slot.

Bind Brackets



Type	Material	Surface Treatment
HBLBS8	1045 Carbon Steel or Equivalent	Trivalent Chromate
SHBLBS8	CF-8 Stainless Steel Cast	—
HBLBSL8	1045 Carbon Steel or Equivalent	Trivalent Chromate
SHBLBSL8	CF-8 Stainless Steel Cast	—

Blind Brackets

HBLBS8
SHBLBS8

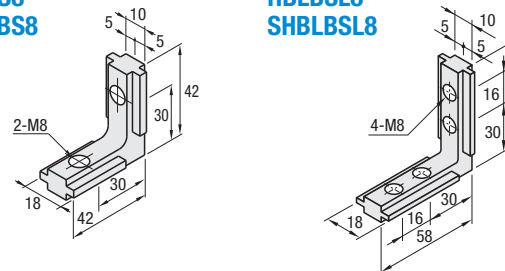

Part Number	Mass (g)	Included Screw		Allowable Load (N)
		Screw	Qty.	
HBLBS8	70	Set Screw M8 x 10	2	1274
SHBLBS8				
HBLBSL8	87	Set Screw M8 x 10	4	1554
SHBLBSL8				

Application Example

How to Use Blind Brackets

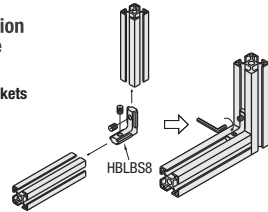

Features: Blind Brackets Post Assy. Insertion Type.

Post-Assembly Insertion Blind Brackets

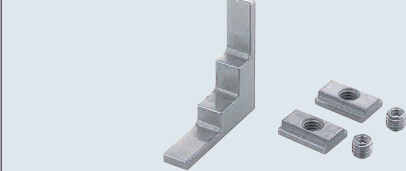

HABLBS8

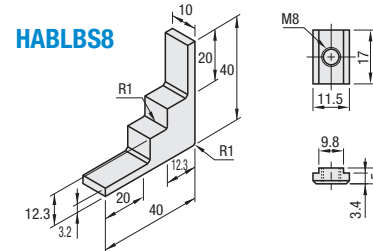

Type	Components	Material
HABLBS8	Post-Assembly Insertion BB Body	CF-8 Stainless Steel Cast
	Post-Assembly Insertion BB Nut	304 Stainless Steel Sintered Alloy
	Set Screw	304 Stainless Steel

Part Number	Mass (g)	Included Screw		Allowable Load (N)
		Screw	Qty.	
HABLBS8	47	Nut / Set Screw M8 x 6	2	700

Application Example

How to Use Post-Assembly Insertion Blind Brackets

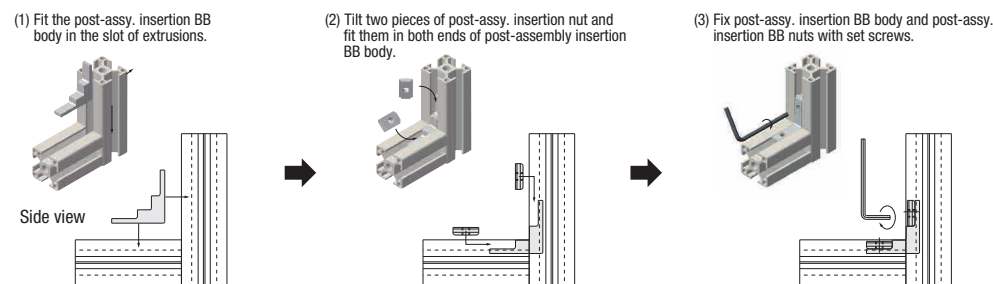

Features: Blind Brackets to connect Extrusions 45 / 30 square.



For 40-30 square connection

HBLBS8-6

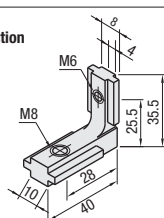

Type	Material	Surface Treatment
HBLBS8-6	1045 Carbon Steel or Equivalent	Trivalent Chromate

Part Number	Mass (g)	Connectable Extrusion Series	Included Set Screw
HBLBS8-6	50	HFS8 and HFS6	M6 x 8 1 pc. M8 x 10 1 pc.
		HFS8-45 and HFS6	

Part Number Example: HBLBS8

Free Angle Brackets

Slot Type: HFS8-45 Series (Aluminum Extrusions 45, 90 mm Square)

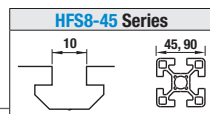

Free Angle Brackets



Extrusion Side Face Connection Type

HBLTBA45
(An order of quantity 1 includes 1 pc.)

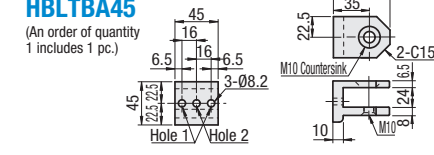

Extrusion Cross Section Connection Type

HBLTBBN45
(An order of quantity 1 includes 1 pc.)

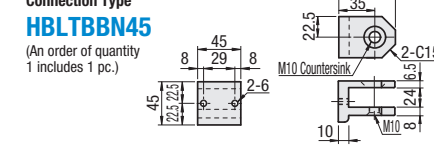

Clamp Lever Type

HBLTBC45
HBLTBD45
(An order of quantity 1 includes 1 pc. each of (1) and (3).)
(An order of quantity 1 includes 1 pc. each of (2) and (3).)

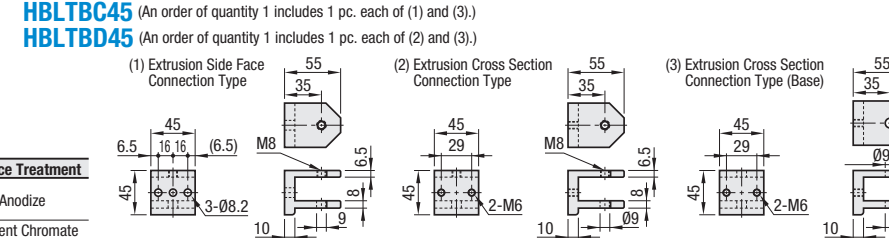

Type	Material	Surface Treatment
HBLTBA45 HBLTBBN45	AGN01SS-T5 Aluminum Alloy	Anodize
HBLTBC45 HBLTBD45	4137 Alloy Steel	Trivalent Chromate

Part Number	Type	No.	Applicable Extrusion	Mass (g)	Accessories	Qty.
HBLTBBN				116		
HBLTBC				299		
HBLTBD				301	CLDMC8-50-M	

Part Number Alterations: HBLTBA45 - SET2, HBLTBBN45 - SET

Alterations	Code	How to use	Part Number	No.	Screw	Qty.	Accessories	
							Nuts / Pre-Assy. Insertion Double Joints	Qty.
Applicable Screws & Nuts Set	SET		HBLTBBN	45	CBM6-35	2	HDJFSN8-45	1
	SET1	Use the hole 1.	HBLTBA	45	CBM8-20	2	HNTT8-8	2
	SET2	Use the hole 2.	HBLTBA	45	CBM8-20	1	HNTT8-8	1
	SET3	Use the hole 1.	HBLTBC	45	CBM6-35	2	HDJFSN8-45	1
	SET4	Use the hole 2.	HBLTBC	45	CBM8-20	2	HNTT8-8	2
SET5			HBLTBD	45	CBM6-35	2	HDJFSN8-45	1
					CBM8-20	1	HNTT8-8	1
					CBM6-35	4	HDJFSN8-45	2

When connecting with Pre-Assembly Insertion Double Joints, S type hole machining is required on extrusions. (Refer to P.2872) Not RoHS compliant when -SET is specified.

Part Number Example: HBLTBA30

Application Example

(1) Connection of Two End Sections

Two pieces of HBLTBBN are used to connect two end sections using Pre-Assembly Insertion Double Joints P.2854 (With Clamp Lever Type: HBLTBD45).

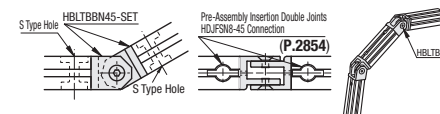

(2) Connection of Two Side Faces

On the extrusion side face, connect with HBLTBA. On the end face, use 1 HBLTBBN for 1 HBLTBA using Pre-Assembly Insertion Double Joint. (With Clamp Lever Type: HBLTBC45)

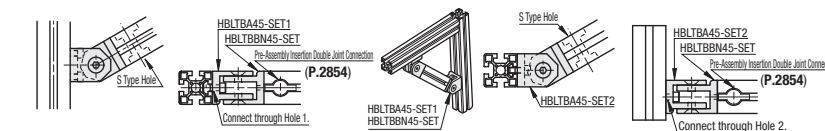

(3) Connection of Two Side Faces

Two pieces of HBLTBA are used to connect them with extrusion side using screws and nuts.

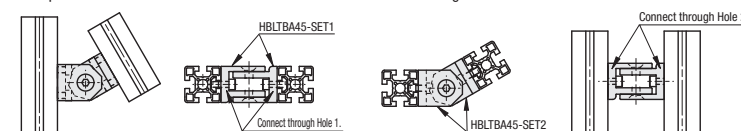

Free Angle Sheet Metal Brackets

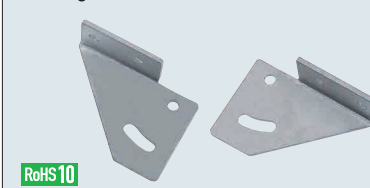

HBLPBL8-45

HBLPBR8-45

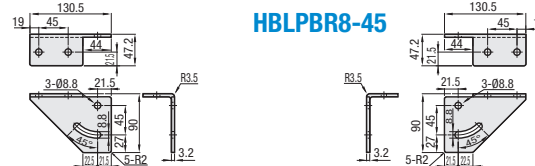

Type	Material	Surface Treatment
HBLPBL8-45 HBLPBR8-45	1045 Carbon Steel or Equivalent	Trivalent Chromate

Part Number	Type	No.	Applicable Extrusion	Applicable Screw / Nut		
				Hexagon Socket Head Cap Screws with Captured Washers	Qty.	Nuts
HBLPBL HBLPBR	8-45	45 Square (HFS8-45)	CBST8-15	4	HNTT8-8	4

Application Example

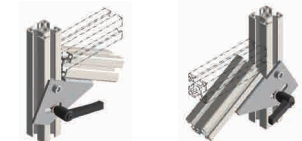

Part Number Example: HBLPBL8-45

Part Number Alterations: HBLPBL8-45 - SET

Alterations	Code	Spec.	Applicable Brackets
Set of Applicable Bolts & Nuts	SET	Supplies a set of applicable bolts and nuts for fixing the bracket to an extrusion.	HBLPBL8-45 HBLPBR8-45
Set with Applicable Bolts, Nuts & Clamp Levers	SET1	Applicable Bolts 3 pcs. Clamp Lever (LNP) 1 Pc. Flat Washer (PWF) 1 Pc. Applicable Nuts 4 Pcs. Set with the above items.	HBLPBL8-45 HBLPBR8-45