

Circular Posts

One End Tapped / One End Threaded

Circular Posts – One End Tapped / One End Threaded



RoHS10

Type		Material	Surface Treatment
One End Tapped	One End Threaded		
NETMN	NETN	1018 Carbon Steel or Equivalent	—
ETKMN	ETKN		Black Oxide
PETMN	PETN		Electroless Nickel Plating
SETMN	SETN	304 Stainless Steel	—

L dim. tolerance is normally:
 L 15–300 ±0.2
 L301–600 ±0.3
 L601–1000 ±0.4
 However, when L≤200, all simultaneously produced pieces in a lot will have L dim. tolerance of ±0.02 or better.

One End Tapped

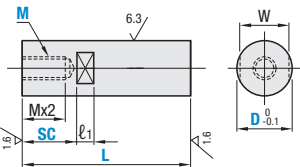

One End Threaded, One End Tapped

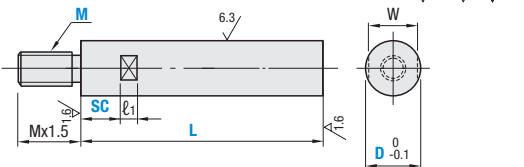

Ⓢ The area around the wrench flats may become glossy due to polishing. Ⓢ SC≤L-l₁
 Ⓢ Rust preventative Oil is applied on 1018 Carbon Steel or Equivalent products.

Part Number		L 1 mm Increment	SC 1 mm Increment	M (Coarse)			W	l ₁		
Type	D			2.6	3	4			5	6
One End Tapped 1018 Carbon Steel or Equivalent NETMN ETKMN PETMN	One End Threaded 1018 Carbon Steel or Equivalent NETN ETKN PETN	5	15–100	0–92	2.6	3	4	8		
		6	15–100	0–92	3	4	5			
		8	20–200	0–192	3	4	5			
		304 Stainless Steel SETMN	304 Stainless Steel SETN	10	20–400	0–392	4	5	6	10
				12	25–500	0–490	5	6	8	
				15	35–600	0–590	6	8	10	
20	40–600			0–590	6	8	10	12		
25	55–700			0–690	6	8	10	12	16	
30	65–800			0–785	6	8	10	12	16	20
*35	80–900			0–885	8	10	12	16	20	
*40	80–1000			0–980	10	12	16	20	24	
*50	80–1000			0–980	12	16	20	24		

Ⓢ When SC≤Mx3 for One End Tapped Type, W–M≥2 is required.
 Ⓢ *D≥35 is applicable only to NETMN, ETKMN and PETMN.

Part Number		Available Types				
Type	B	Min. L–200	L201–400	L401–600	L601–800	L801–1000
One End Tapped	5	•	—	—	—	—
	6	•	—	—	—	—
1018 Carbon Steel or Equivalent NETMN	8	•	—	—	—	—
	10	•	•	—	—	—
	12	•	•	•	—	—
1018 Carbon Steel or Equivalent Black Oxide ETKMN	15	•	•	•	—	—
	20	•	•	•	—	—
	25	•	•	•	—	—
1018 Carbon Steel or Equivalent Electroless Nickel Plating PETMN	30	•	•	•	•	—
	35	•	•	•	•	—
	40	•	•	•	•	•
304 Stainless Steel SETMN	50	•	•	•	•	•

Part Number Example: NETMN10 - 300 - SC250 - M5
 SETN20 - 350 - SC100 - M10

Part Number Alterations: NETN10 - 300 - SC250 - M5 - MLC6

Alterations	Code	Spec.
Threaded Length 	MLC	Changes the Threaded length. Ⓢ Not applicable to D=5. MLC=0.1 mm Increment Ⓢ Mx1≤MLC<Mx1.5 Ordering Code: MLC10 Ⓢ Applicable to One End Threaded only.

Alterations	Code	Spec.
Full Length (L Dimension) Precision 	LVC	When ordering multiple, each L dimension variation will be within ±0.02mm Ordering Code: LVC Ⓢ Applicable only for L≤200 and less than 10 orders for 1 itemized line. Ⓢ Not available for L Dimension Selectable Type.

Ⓢ For LKC, P2219

Resin Circular Posts

One End Tapped / One End Threaded / One End Threaded Inserts / Both Ends Threaded Inserts

Ⓢ Thread inserts added to the body (resin) to strengthen the tapped holes.

Resin Circular Posts – One End Tapped / One End Threaded / One End Threaded Inserts / Both Ends Threaded Inserts

Type				Material	Color	Threaded Inserts Material
One End Tapped	Both Ends Tapped	One End Threaded Inserts	Both Ends Threaded Inserts			
PHRF	PLRF	PHNRF	PLNRF	Polyacetal	White	304 Stainless Steel

One End Tapped / One End Threaded Inserts

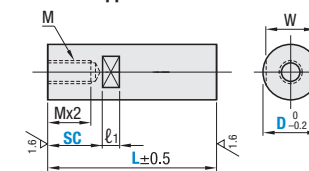

Both Ends Tapped / Both Ends Threaded Inserts

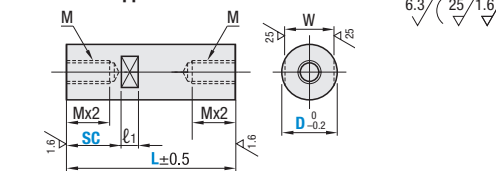

Ⓢ SC≤L-l₁, Ⓢ Characteristic Values P.3068

Part Number				L 1 mm Increment	SC 1 mm Increment	M (Coarse)	W	l ₁
Type	D	6	8					
One End Tapped	PHRF	Both Ends Tapped	PLRF	One End Threaded Inserts	PHNRF	Both Ends Threaded Inserts	PLNRF	5
								7
One End Tapped	PHRF	Both Ends Tapped	PLRF	One End Threaded Inserts	PHNRF	Both Ends Threaded Inserts	PLNRF	8
								10
								12
								15
								20
								25
								30

Part Number Example: PHRF10 - 300 - SC200
 PLNRF20 - 400 - SC310