

# Support Pins

## Selectable Pilot (Tip) Shape

### Support Pins – Selectable Pilot (Tip) Shape



Threaded	Tapped	Pilot	Material	Surface Treatment	Hardness
LSPC	LSPA	LSPB	1045 Carbon Steel or Equivalent	Black Oxide	—
LSPRC	LSPAR	LSPBR		Hard Chrome Plating	Plating Hardness :750 HV min.
LSPHBC	LSPAHB	LSPBHB		Black Oxide	Treated Hardness: 45~50 HRC min.
LSPHRC	LSPAHR	LSPBHR		Hard Chrome Plating	Treated Hardness: 45~50 HRC min. Plating Hardness :750 HV min.
LSPSUC	LSPASU	LSPBSU	304 Stainless Steel	—	—
LSPSCC	LSPASC	LSPBSC	440C or 420 Stainless Steel	—	Treated Hardness: 50~55 HRC min.

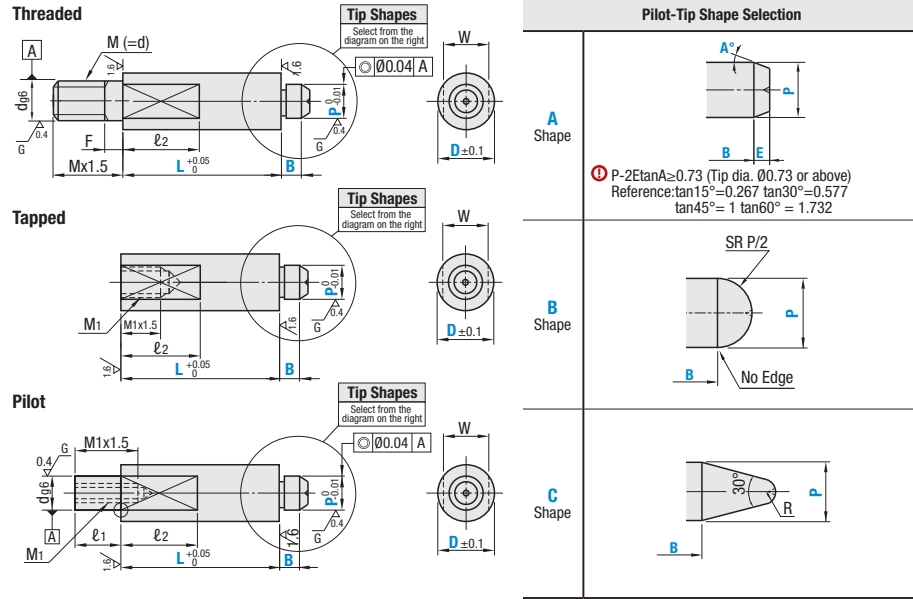

① For Stepped Pilot Type, D Dimension 10 or more is available. ② Note the strength of undercut part for Tapped. P.1542

Part Number		Type	Tip Shape	D	L 0.01 mm Increment	P 0.01 mm Increment	B 0.1 mm Increment	E 0.1 mm Increment (Shape A Only)	A Selection (Shape A Only)	R (Shape C)	d	M (Coarse)	F	M <sub>1</sub> (Coarse)	ℓ <sub>1</sub>	W	ℓ <sub>2</sub>									
Threaded	LSPC																	LSPA	LSPB	6	10.00-50.00	3.00-4.00	2.0-12.0	0.5-10.0	15	1
Tapped	LSPRC	LSPAR	LSPBR	8	20.00-80.00	3.00-6.00	2.0-15.0	30	1.5	5	5	2	M5	6	8	10										
Pilot	LSPHBC	LSPAHB	LSPBHB	10		4.00-8.00	2.0-20.0										45	2	10	10	5	M8	9			
	LSPHRC	LSPAHR	LSPBHR	12	4.00-10.00	2.0-20.0	60	3	8	8	4	M8	9	17	20											
	LSPSUC	LSPASU	LSPBSU	15	5.00-10.00	2.0-25.0										10	4	16	16	5	M8	9	17	20		
	LSPSCC	LSPASC	LSPBSC	20	8.00-15.00	2.0-30.0	10	4	16	16	5	M8	9	17	20											
				25	10.00-15.00	2.0-30.0																				

③ D values 6, 8 unavailable for Pilot type parts.

Part Number Example

Part Number	LSPAA10	-	L20.01	-	P4.05	-	B5	-	E2.0	-	A15
	LSPBC12	-	L25.01	-	P8.00	-	B10	-		-	
	LSPCA10	-	L20.01	-	P4.05	-	B5	-	E2.0	-	A15

### Tapped, Threaded

#### Recommended Tightening Torque (Reference)

M (Coarse)	Tightening Torque N•cm
M3	98
M4	225
M5	461
M6	784
M8	1911
M10	3783
M12	6605
M16	16366
M20	32928

\* The tightening torque (ref. value) for hardened products is strength class 8.8. (See technical data on MISUMI 2019 catalog P.4015). Not applicable when using locking agents or spring washers.

# Hex Support Pins

## Stepped

### Hex Support Pins – Stepped



RoHS 10

Type			Material	Surface Treatment	Hardness
Threaded	Tapped	Pilot			
SRPCB	SRPAB	SRPBB	1045 Carbon Steel or Equivalent	Black Oxide	—
SRPCR	SRPAR	—		Hard Chrome Plating	Plating Hardness: 750 HV min.
SRPCHB	SRPAHB	SRPBHB		Black Oxide	Treated Hardness: 45~50 HRC min.
SRPCHR	SRPAHR	SRPBHR		Hard Chrome Plating	Treated Hardness: 45~50 HRC min. Plating Hardness: 750 HV min.
SRPCC	SRPAC	SRPBC	440C or 420 Stainless Steel	—	Treated Hardness: 50~55 HRC min.

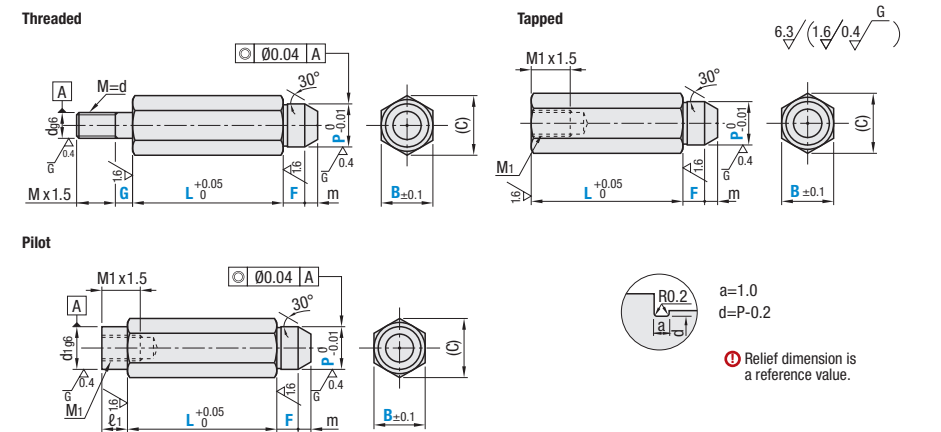

① When G < Pitch x 2, the incomplete threaded section (Pitch x 2) is included in M x 1.5. Pitch Diameter P.4010

Pilot Type	Tapped Type	Threaded Type	B	L 0.01 mm Increment	P 0.01 mm Increment	F 0.1 mm Increment	G 1 mm Increment Threaded Only	m	(C)	d	M (Coarse)	M <sub>1</sub> (Coarse)	ℓ <sub>1</sub>	d <sub>1</sub>					
															SRPBB	SRPAB	SRPCB	6	10.00-50.00
SRPBHB	SRPAR	SRPCR	7	15.00-50.00	3.00-6.00	2.0-15.0	2	5	M5	M4	6	8							
SRPBHR	SRPAHB	SRPCHB	10										4.00-8.00	2.0-20.0					
SRPBC	SRPAHR	SRPCHR	12	4.00-10.00	2.0-25.0														
	SRPAC	SRPCC	13	5.00-10.00	2.0-30.0														
			14	20.00-80.00	8.00-15.00	2.0-30.0		3	6	M6	M6	8	10						
			17																
			19																
			24																
								4	10	M10	M8	9	12						
												10	16						

① Pilot type available for B ≥ 10. ② 440C or 420 Stainless Steel is B ≥ 8.  
③ D6, D7 unavailable for SRPAC, SRPCC part types ④ For full thread, specify a G dimension of 0 and NNC alteration.

Part Number Example

Part Number	L	P	F
Type	B		
SRPBHB	14	L70.02	P6.00 F5.0
SRPAHB	14	L70.02	P6.00 F5.0

Part Number Alterations

Part Number	L	P	F	G	(DRC, NNC)
SRPCB12	L30.00	P4.98	F3.0	G0	NNC

Alterations	Screwdriver Slot	Relief
	Code	DRC
Spec.	Machines a screwdriver slot of width 0.8mm and depth 1 mm.	Adds a relief at the thread end. ① Applicable when G=0.

### Tapped and Threaded

#### Recommended Tightening Torque (Reference)

M (Coarse)	Tightening Torque N•cm
M3	98
M4	225
M5	461
M6	784
M8	1911
M10	3783
M12	6605
M16	16366
M20	32928

\* The tightening torque (ref. value) for hardened products is strength class 8.8. (See technical data on MISUMI 2019 catalog P.4015). Not applicable when using locking agents or spring washers.