

Locating Pins (Large Head) with Threaded Shank / Hex Socket / Wrench Hole

Locating Pins – Threaded Shank / Hex Socket / Wrench Hole



Materials No.	Material	Surface Treatment	Hardness	Type	Shape Code
(1)	O1 Tool Steel	—	Treated Hardness: 60–63 HRC min.	FPNS	A Round D Diamond
(2)	O1 Tool Steel	Hard Chrome Plating	Hardness: 50–55 HRC min. Plating Hardness: 750 HV min.	GFPS	
(3)	SKS3 Tool Steel or Equiv.	—	—	BFPS	
(4)	304 Stainless Steel	—	—	SFPS	
(5)	304 Stainless Steel	Hard Chrome Plating	Plating Hardness 750 HV min.	HFPS	
(6)	440C or 420 Stainless Steel	—	Treated Hardness: 50–55 HRC min.	CFPS	

Some combinations are not available. Refer to the price list to select the available combination.

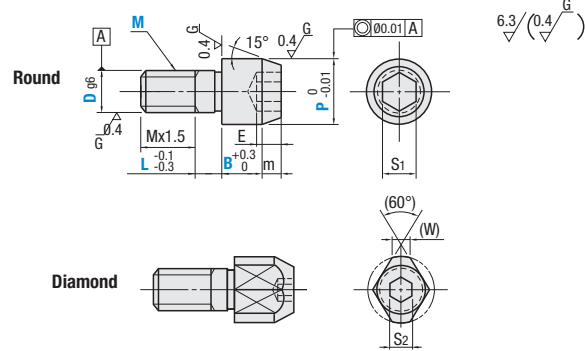

- ① 440C or 420 Stainless Steel has an identification groove on D part.
- ② When M<D, Mx1.5, the incomplete threaded portion (Pitchx2) is included in Mx1.5.

Type	Part Number		D Tolerance g6	P 0.01 mm Increment	L 1 mm Increment	B 0.1 mm Increment	M (Coarse)	m	(W)	S ₁	S ₂	E
	Shape	D										
FPNS GFPS BFPS SFPS HFPS CFPS	A Round	3	-0.002 -0.008	6.00–6.50	2–6	3.5–10.0	3	2	—	3	—	2
		4	-0.004 -0.012	6.50–7.00	2–8	2.5–10.0	3 4	—				
		5	-0.005 -0.014	6.50 (8.00)–10.00	3–10	2.5–10.0	4 5 6	—				
		8	-0.005 -0.014	9.00 (10.00)–13.00	5–10	3.0–15.0	4 5 6 8	3.5	4	4	2.5	
	D Diamond	10	-0.006 -0.017	11.00 (12.00)–15.00	5–15	4.5–20.0	5 6 8 10	4	5	5	3	—
		12	-0.006 -0.017	13.00–18.00	8–15	6.0–20.0	6 8 10 12	5	6	6	4	—
		16	-0.007 -0.020	17.00–25.00	8–20	8.0–20.0	8 10 12 16	7	8	8	5	—
		20	-0.007 -0.020	22.00–30.00	10–20	8.0–20.0	10 12 16 20	9	8	8	5	—

① P dimension in () is applicable to Diamond Shape. ② When M dimension is not specified, D=M.

D	Available Types for Round Shape						Available Types for Diamond Shape					
	(1) O1 Tool Steel Hardened FPNSA	(2) Hard O1 Tool Steel GFPSA	(3) O1 Tool Steel BFPSA	(4) 304 Stainless Steel SFPSA	(5) 304 Stainless Steel Hard HFPSA	(6) 440C or 420 Stainless Steel CFPSA	(1) O1 Tool Steel Hardened FPNSD	(2) Hard O1 Tool Steel GFPSD	(3) O1 Tool Steel BFPSD	(4) 304 Stainless Steel SFPSD	(5) 304 Stainless Steel Hard HFPSD	(6) 440C or 420 Stainless Steel CFPSD
3	•	•	•	•	•	•	—	—	—	—	—	—
4	•	•	•	•	•	•	—	—	—	—	—	—
5	•	•	•	•	•	•	—	—	—	—	—	—
8	•	•	•	•	•	•	—	—	—	—	—	—
10	•	•	•	•	•	•	—	—	—	—	—	—
12	•	•	•	•	•	•	—	—	—	—	—	—
16	•	•	•	•	•	•	—	—	—	—	—	—
20	•	•	•	•	•	•	—	—	—	—	—	—

Part Number Example

Part Number: [Type] [Shape] [D] - P - L - B - M

Example: FPNS A 10 - P12.00 - L5 - B5.0

Example: GFPS D 16 - P19.50 - L14 - B10.0 - M12

Part Number Alterations

Part Number: [Type] - P - L - B - M - (NNC)

Example: FPNSA8 - P10.00 - L10 - B10.0 - M6 - NNC

Alterations

- Code:** NNC
- Spec:** Adds a relief at the thread end. Undercut length is approx. Pitch x 2.

Locating Pins (Large Head) with Counterbore Hole

Locating Pins – Large Head with Counterbore Hole



Materials No.	Material	Surface Treatment	Hardness	Standard Type			Shape Code
				P Configurable	P, L, B Configurable	Compact Type P, L, B Configurable	
(1)	O1 Tool Steel Equivalent	—	Treated Hardness: 60–63 HRC min.	JPT	FPT	FPTC	MA Round MD Diamond
(2)	O1 Tool Steel Equivalent	Hard Chrome Plating	Hardness: 50–55 HRC min. Plating Hardness: 750 HV min.	—	GFPT	—	
(3)	SKS3 Tool Steel or Equiv.	—	—	—	BFPT	—	
(4)	304 Stainless Steel Equivalent	—	—	SJPT	SFPT	SFPTC	
(5)	304 Stainless Steel Equivalent	Hard Chrome Plating	Plating Hardness 750 HV min.	HJPT	HFPT	—	
(6)	440C or 420 Stainless Steel	—	Treated Hardness: 50–55 HRC min.	CJPT	CFPT	—	

Some combinations are not available. Refer to the price list to select the available combination.

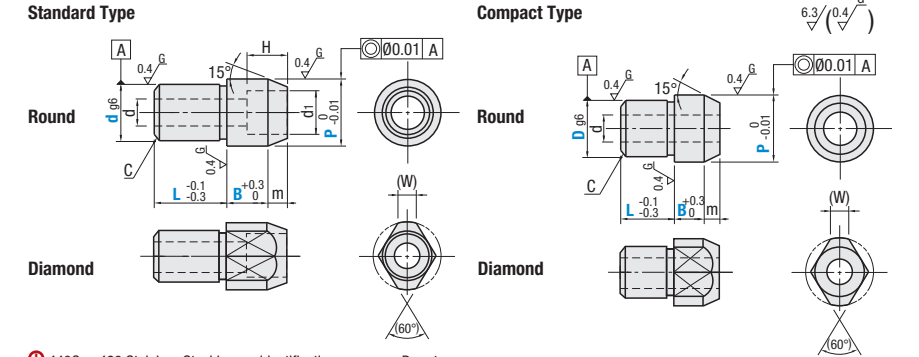

Applicable Screws

D	g6	d	d ₁	H	Applicable Screw M
10	-0.005 -0.014	4.5	8	5	M4
12	—	5.5	9.5	6.5	M5
13	-0.006 -0.017	6.6	11	7.5	M6
16	—	9	14	10	M8
20	-0.007 -0.020	—	—	—	—

- ① 440C or 420 Stainless Steel has an identification groove on D part.
- ② Polished, centering hole is sometimes not available for 304 Stainless Steel.

Standard – P Configurable

Type	Shape	D	P		L	B	C	m	(W)
			0.01 mm Increment	1 mm Increment					
JPT SJPT HJPT CJPT	MA Round MD Diamond	10	14.00–17.00	5–20	15	10	2	4	4
		12	15.00–18.00	6–24					5
		13	17.00–20.00	6–26	22	3	5	5.5	
		16	20.00–27.00	7–32				7	
		20	23.00–30.00	8–40	30	15	9	9	

Standard – P, L & B Configurable

D	Available Types for Round Shape				Available Types for Diamond Shape			
	(1) O1 Tool Steel Hardened JPTMA	(4) 304 Stainless Steel SJPTMA	(5) 304 Stainless Steel Hard HJPTMA	(6) 440C or 420 Stainless Steel CJPTMA	(1) O1 Tool Steel Hardened JPTMD	(4) 304 Stainless Steel SJPTMD	(5) 304 Stainless Steel Hard HJPTMD	(6) 440C or 420 Stainless Steel CJPTMD
10	•	•	•	•	•	•	•	•
12	•	•	•	•	•	•	•	•
13	•	•	•	•	•	•	•	•
16	•	•	•	•	•	•	•	•
20	•	•	•	•	•	•	•	•

Standard – P, L & B Configurable

Type	Shape	D	P		L	B	C	m	(W)
			0.01 mm Increment	1 mm Increment					
FPT GFPT BFPT SFPT HFPT CFPT	MA Round MD Diamond	10	14.00–17.00	5–20	15	10	2	4	4
		12	15.00–18.00	6–24					5
		13	17.00–20.00	6–26	22	3	5	5.5	
		16	20.00–27.00	7–32				7	
		20	23.00–30.00	8–40	30	15	9	9	

① When L-D, C dimension (chamfered) is 0.5.

Compact Type

Type	Shape	D	P		L	B	C	m	(W)
			0.01 mm Increment	1 mm Increment					
FPTC SFPTC	MA Round MD Diamond	10	11.00–15.00	5–14	10	10	2	4	4
		12	13.00–17.00	6–15					5
		13	14.00–18.00	6–16	20	3	5	5.5	
		16	17.00–21.00	7–18				7	
		20	21.00–25.00	8–20	9				

Part Number Example

Type	Shape	D	P	L	B
JPT	MA	10	-	14.00	—
FPT	MA	10	-	P14.00 - L15 - B6.0	—
FPTC	MA	12	-	P13.00 - L6 - B3.0	—

Application Example

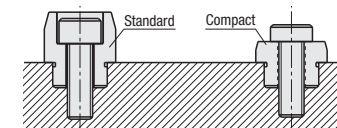

Although the screw head protrudes from Compact Type pin, head diameter P and height B are configurable to even smaller dimensions.