

Flanged Idlers with Teeth

P2M, P3M, P5M, P8M, 2GT, 3GT, 5GT, 8YU Type

ⓘ Idler shafts (cantilever shafts) can be selected from P.912.

Flanged Idlers with Teeth –
P2M, P3M, P5M, P8M, 2GT,
3GT, 5GT, 8YU Type

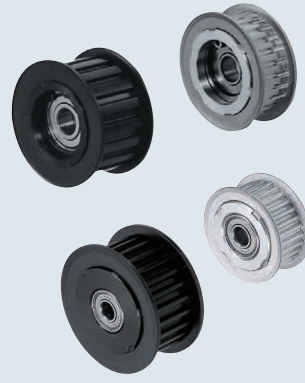

RoHS10

Type				Material			Surface Treatment
P2M / P3M / P5M / P8M	2GT / 3GT / 5GT / 8YU			Main Body	Flange	Bearing	
Center Bearing	Both Sides Bearing	Center Bearing	Both Sides Bearing	2000 Series Aluminum Alloy	Aluminum Alloy	Steel or Equivalent	Clear Anodize
APTF	APTFW	AGTF	AGTFW				Hard Clear Anodize*
—	KPTFW	—	—	1045 Carbon Steel or Equivalent	Low Carbon Steel		Black Oxide
BPTF	BPTFW	BGTF	BGTFW				

*Hard Anodize Treatment:
Film Hardness 300 HV min.
Bearing Accuracy JIS B1514 Class 0
ⓘ Bearings are press-fitted.
(*1) Body material of P8M is Ultra Duralumin-Based Aluminum Alloy

Center Bearing Type

Bearing 1 Pcs.

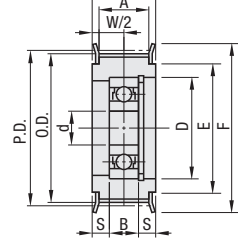

Both Sides Bearing Type

Bearing 2 Pcs.

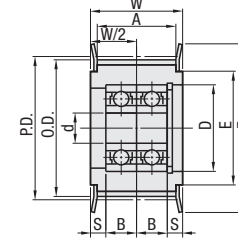

Both Sides Bearing Type

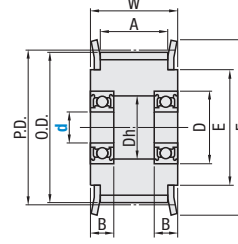

P2M / P3M / P5M / P8M Type (Center Bearing Type)

*E and F dimensions in () are for BPTF.

Type	Teeth	Applicable Belt	Shaft Diameter d	P.D.	O.D.	F		E		A	W	S	Bearing Dimensions			Available Types	
						APTF	BPTF	APTF	BPTF				No.	D	B	APTF	BPTF
APTF BPTF	40	P2M060	6	25.46	24.96	32	—	23	—	7.5	11.5	3.25	696ZZx1	15	5	•	—
	30	P3M100	6	28.65	27.89	35	35	25	25	12	16	5	626ZZx1	19	6	•	•
		P3M150								17	21	4.5	626ZZx2			•	•
	20	P5M100	8	31.83	30.69	35	—	25	—	11.6	16	5	698ZZx1	19	6	•	—
		P5M150								16.6	21	5	698ZZx2			•	•
	28	P5M100	10	44.56	43.42	50	50	38	38	11.6	16	3.5	6200ZZx1	30	9	•	•
		P5M150								16.6	21	6	6200ZZx2			•	•
	20	P8M150	12	50.93	49.56	55	—	40	—	16.8	22	6	6201ZZx1	32	10	•	—
		P8M250								27.8	33	5.5	6202ZZx2			35	11
	24	P8M250	12	61.12	59.74	67	—	50	—	27.8	33	6.5	6201ZZx2	32	10	•	—
		P8M150								16.8	22	5.5	6202ZZx1			35	11
	30	P8M150	15	76.39	75.02	83	83	63	63	27.8	33	5.5	6202ZZx1	35	11	•	•
P8M250		27.8								33	5.5	6202ZZx2	35			11	•

P5M / P8M Type (Both Sides Bearing Type)

*E and F dimensions in () are for BPTFW.

Type	Teeth	Applicable Belt	Shaft Diameter d	P.D.	O.D.	F		E		A	W	Dh	Bearing Dimensions			Available Types									
						APTF	BPTF	APTF	BPTF				No.	D	B	APTFW	KPTFW	BPTFW							
APTFW KPTFW BPTFW	25	P5M100	6	39.79	38.65	—	—	—	—	11.6	16	13	696ZZx2	15	5	—	—	•							
		P5M150								16.6	21					•	•								
		P5M100								8	44					44	32	11.6	16	16.5	698ZZx2	19	6	•	•
		P5M150																16.6	21					•	•
	28	P5M100	10	44.56	43.42	50	50	38	38	11.6	16	19.5	6900ZZx2	22	6	•	•								
		P5M150								16.6	21					•	•								
	30	P5M150	12	47.75	46.60	—	55	—	40	16.6	21	24	6001ZZx2	28	8	—	—	•							
		P5M150								57.30	56.15					—	67	—	50	16.6	21	28	6002ZZx2	32	9
	26	P8M150	12	66.21	64.84	74	74	58	58	16.8	22	24	6001ZZx2	28	8	•	•								
										P8M250	27.8					33	•	•							
		30	P8M150	15	76.39	75.02	83	83	63	63	16.8	22	28	6002ZZx2	32	9	•	•							
			P8M250								27.8	33					•	•							
30	P8M250	20	76.39	75.02	83	83	63	63	27.8	33	36	6004ZZx2	42	12	•	•									
	P8M250								27.8	33					•	•									

Part Number Alterations
Part Number - (FC-NFC / LFC / RFC)
APTF30P8M250 - NFC

Flanged Idlers with Teeth

P2M, P3M, P5M, P8M, 2GT, 3GT, 5GT, 8YU Type, continued

2GT / 3GT / 5GT / 8YU (Center Bearing Type)

Type	Part Number		Shaft Diameter d	P.D.	O.D.	F	E	A	W	S	Bearing Dimensions			Available Types	
	Teeth	Applicable Belt									No.	D	B	AGTF	BGTF
AGTF BGTF	40	GT2060	6	25.46	24.96	30	21	7.0	10.3	3.65	676ZZx1	10	3	•	—
		GT2090	6								676ZZx1	10	3	•	—
	30	GT3060	6	28.65	27.89	32	23	7.3	11.0	3.00	686ZZx1	13	5	•	—
		GT3090	6								686ZZx1	13	5	•	—
	20	GT5090	8	31.83	30.69	35	24	10.3	14.0	5.25	678ZZx1	12	3.5	•	•
		GT5120	8								678ZZx2	12	3.5	•	•
	24	GT5090	10	38.20	37.06	42	30	10.3	14.0	4.50	6800ZZx1	19	5	•	•
		GT5120	10								6800ZZx2	19	5	•	•
	28	GT5090	10	44.56	43.42	48	36	10.3	14.0	4.50	6800ZZx1	19	5	•	•
		GT5120	10								6800ZZx1	19	5	•	•
	30	GT5090	12	47.75	46.61	51	39	10.3	14.0	4.50	6801ZZx1	21	5	•	•
		GT5120	12								6801ZZx1	21	5	•	•
20	YU8150	20	50.93	49.56	62	40	16.7	23.0	8.00	6804ZZx1	32	7	•	•	
	YU8200	20								6804ZZx2	32	7	•	•	
30	YU8150	25	76.39	75.02	85	64	16.7	23.0	7.00	6805ZZx1	37	7	•	•	
	YU8200	25								6805ZZx2	37	7	•	•	
	YU8250	25								6805ZZx2	37	7	•	•	
	YU8250	25								6805ZZx2	37	7	•	•	

2GT / 3GT / 5GT / 8YU (Both Sides Bearing Type)

Type	Part Number		Shaft Diameter d	P.D.	O.D.	F	E	A	W	Dh	Bearing Dimensions			Available Types	
	Teeth	Applicable Belt									No.	D	B	AGTFW	BGTFW
AGTFW BGTFW	30	GT2040	5	19.10	18.59	24	15	5.0	8.3	7	675ZZx2	8	2.5	•	—
		GT2060	5				15	7.0	10.3	7	675ZZx2	8	2.5	•	—
		GT2090	5				15	10.0	13.3	7	675ZZx2	8	2.5	•	—
	20	GT3090	5	19.10	18.34	23	14	10.3	14.0	7	675ZZx2	8	2.5	•	—
		GT3150	5				14	16.3	20.0	7	675ZZx2	8	2.5	•	—
	24	GT3090	6	22.92	22.16	26	18	10.3	14.0	9	676ZZx2	10	3	•	—
		GT3150	6				18	16.3	20.0	9	676ZZx2	10	3	•	—
	30	GT3090	8	28.65	27.89	32	23	10.3	14.0	11	678ZZx2	12	3.5	•	—
		GT3150	8				23	16.3	20.0	11	678ZZx2	12	3.5	•	—
	20	GT5120	8	31.83	30.69	35	24	13.3	17.0	11	678ZZx2	12	3.5	•	•
		GT5150	8				24	16.3	20.0	11	678ZZx2	12	3.5	•	•
	30	GT5120	8	47.75	46.61	51	39	13.3	17.0	11	678ZZx2	12	3.5	•	•
GT5150		12	39				16.3	20.0	18.5	6801ZZx2	21	5	•	•	
32	GT5120	12	50.93	49.79	55	42	13.3	17.0	18.5	6801ZZx2	21	5	•	•	
	GT5150	12				42	16.3	20.0	18.5	6801ZZx2	21	5	•	•	
36	GT5120	15	57.30	56.16	61	49	13.3	17.0	21.5	6802ZZx2	24	5	•	•	
	GT5150	15				49	16.3	20.0	21.5	6802ZZx2	24	5	•	•	
30	YU8200	25	76.39	75.02	85	64	21.7	28.0	34.5	6805ZZx2	37	7	•	•	
	YU8250	25				64	26.7	33.0	34.5	6805ZZx2	37	7	•	•	

Part Number Example

Center Bearing Type			Both Sides Bearing Type		
Type	Teeth	Applicable Belt	Type	Teeth	Applicable Belt
APTF	20	P5M100	APTFW	25	P5M150
AGTF	30	GT5090	AGTFW	20	GT3090

Application Example

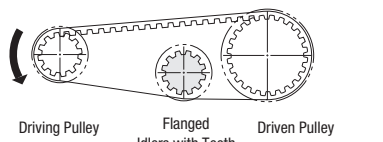

ⓘ Be sure to use the idler on the loose side.
ⓘ Install the idler as close as possible to the larger pulley.

Alteration	Flange Cut	Flange Not Swaged	Flange Swaged on One Side
Code	FC	NFC	LFC / RFC
Spec.	<p>Lowers flange by cutting. FC: 0.5 mm Increment (No surface treatment applied on flange circumference.)</p> <p>ⓘ No surface treatment applied on flange circumference. ⓘ FC=(O.D.)+2 Ⓞ FC=F-2 Ordering Code: FC35</p>	<p>Flange is not installed. (Flange included)</p>	<p>Flange installed on the retaining ring side (RFC) or the opposite side (LFC).</p>