

Timing Pulleys

Width Configurable Type MXL, XL, S2M, S3M, S5M Type

Timing Pulleys – Width Configurable Type MXL, XL, S2M, S3M, S5M Type

RoHS10

FTP_A_MXL
XL
S2M
S3M
S5M

Pulley Shape

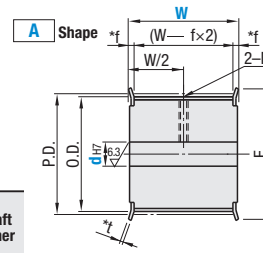

Shaft Bore Specs. The shaft bore may not have surface treatment.

H Round Hole

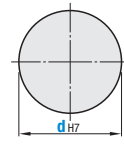

P Round Hole+Tap

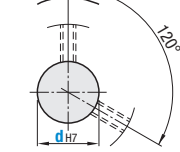

*No tapped holes and set screws. The set screw holes are placed at around 120° in order to avoid peaks.

*MXL, S2M, S3M : f=2.0t=1.0
XL, S5M : f=2.5t=1.6

Type	Material	Surface Treatment
FTP_A	2017 Aluminum Alloy	Clear Anodize

Tapped Hole Dimensions

M (Coarse)	Accessory Set Screw	MXL (d ₁₇ Shaft Bore Inner Dia.)	XL (d ₁₇ Shaft Bore Inner Dia.)	S2M (d ₁₇ Shaft Bore Inner Dia.)	S3M (d ₁₇ Shaft Bore Inner Dia.)	S5M (d ₁₇ Shaft Bore Inner Dia.)
M 3	M3 x 3	3-5	—	3-5	4-5	—
M 4	M4 x 3	6-18	6-12	6-22	6-17	6-12
M 5	M5 x 4	19-20	13-17	—	18-32	13-17
M 6	M6 x 5	—	18-30	—	—	18-30
M 8	M8 x 6	—	31-47	—	—	31-38

Part Number	Type	Teeth	Belt Type	Pulley Shape	W mm Inc.	Shaft Bore Specs	Shaft Bore Dia. d _{H7} (1 mm Inc.)	P.D.	O.D.	F	Available Types								
											W15-25	W26-50	W51-75	W76-100					
14	FTP_A	14	MXL	A	15-100	H	3-4	9.06	8.55	12									
15		3-4					9.70	9.19											
16		3-5					10.35	9.84											
17		3-5					11.00	10.49											
18		3-5					11.64	11.14											
19		3-5					12.29	11.78											
20		4-6					12.94	12.43											
21		4-6					13.58	13.07											
22		4-6					14.23	13.72											
23		4-7					14.88	14.37											
24		4-7					15.52	15.02											
25		4-7					16.17	15.66											
26		4-8					16.82	16.31											
27		4-8					17.46	16.96											
28		4-8					18.11	17.60											
30		4-10					19.40	18.90											
32		4-10					20.70	20.19											
34		4-10					21.99	21.48											
36		5-12					23.29	22.78											
38		5-12					24.58	24.07											
40		5-12					25.87	25.36											
42		5-12					27.17	26.66											
44		5-13					28.46	27.95											
46		5-13					29.75	29.24											
48	5-15	31.05	30.54																
50	5-15	32.34	31.84																
60	5-20	38.81	38.30																
72	5-20	46.57	46.06																
16	FTP_A	16	XL	A	15-100	H	6-13	25.87	25.36	32									
18		6-15					29.11	28.60											
19		6-15					30.72	30.22											
20		8-16					32.34	31.83											
22		8-20					35.57	35.07											
24		8-22					38.81	38.30											
25		8-22					40.43	39.92											
26		8-23					42.04	41.53											
28		8-25					45.28	44.77											
30		10-30					48.51	48.00											
32		10-30					51.74	51.24											
36		10-38					58.21	57.70											
40		10-38					64.68	64.17											
16		FTP_A					16	S2M	A	15-100	H	3-4	8.91	8.40	12				
15							3-4					9.55	9.04						
16							3-5					10.19	9.68						
18							3-5					11.46	10.95						
20							3-6					12.73	12.22						
22							3-6					14.01	13.50						
24							3-7					15.28	14.77						
25							3-7					15.92	15.41						
26							3-8					16.55	16.04						
28							3-8					17.83	17.32						
30							3-8					19.01	18.59						
32	4-10		20.37	19.86															
36	4-10		22.92	22.41															
40	4-12		25.46	24.96															
44	5-13		28.01	27.50															
48	5-15		30.56	30.05															
50	5-16		31.83	31.32															
60	5-22		38.20	37.69															
14	FTP_A		14	S3M	A	15-100	H					4-6	13.37	12.61	16				
15			4-6									14.32	13.56						
16			4-7									15.28	14.52						
18			4-8									17.19	16.43						
20			4-8									19.10	18.34						
22			4-10									21.01	20.25						
24		4-10	22.92					22.16											
25		4-11	23.87					23.11											
26		5-11	24.83					24.07											
28		5-13	26.74					25.98											
30		6-14	28.65					27.89											
32		6-16	30.56					29.80											
36		6-18	34.38					33.62											
40		8-23	38.20					37.44											
44		8-25	42.02					41.25											
48		8-25	45.84					45.07											
50		8-28	47.75					46.98											
60		8-32	57.30					56.53											
14		FTP_A	14					S5M	A	20-100	H	6-10	22.28	21.32	26				
16			7-12									25.46	24.50	32					
20			7-16									31.83	30.87	36					
24			7-20									38.20	37.24	45					
30			7-20									39.79	38.83	45					
32			10-26									47.75	46.79	52					
36	10-28		50.93	49.97	55														
40	10-30		57.30	56.34	61														
40	10-38		63.66	62.70	67														

Catalog No.	Type	Teeth	Belt Type	Pulley Shape	W mm Inc.	Shaft Bore Specs	Shaft Bore Dia. d _{H7} (1 mm Inc.)	P.D.	O.D.	F	Available Types								
											W15-25	W26-50	W51-75	W76-100					
14	FTP_A	14	MXL	A	15-100	H	3-4	8.91	8.40	12									
15		3-4					9.55	9.04											
16		3-5					10.19	9.68											
18		3-5					11.46	10.95											
20		3-6					12.73	12.22											
22		3-6					14.01	13.50											
24		3-7					15.28	14.77											
25		3-7					15.92	15.41											
26		3-8					16.55	16.04											
28		3-8					17.83	17.32											
30		3-8					19.01	18.59											
32		4-10					20.37	19.86											
36		4-10					22.92	22.41											
40		4-12					25.46	24.96											
44		5-13					28.01	27.50											
48		5-15					30.56	30.05											
50		5-16					31.83	31.32											
60		5-22					38.20	37.69											
14		FTP_A					14	S2M	A	15-100	H	4-6	13.37	12.61	16				
15							4-6					14.32	13.56						
16							4-7					15.28	14.52						
18							4-8					17.19	16.43						
20							4-8					19.10	18.34						
22							4-10					21.01	20.25						
24	4-10		22.92	22.16															
25	4-11		23.87	23.11															
26	5-11		24.83	24.07															
28	5-13		26.74	25.98															
30	6-14		28.65	27.89															
32	6-16		30.56	29.80															
36	6-18		34.38	33.62															
40	8-23		38.20	37.44															
44	8-25		42.02	41.25															
48	8-25		45.84	45.07															
50	8-28		47.75	46.98															
60	8-32		57.30	56.53															
14	FTP_A		14	S3M	A	15-100	H					6-10	22.28	21.32	26				
16			7-12									25.46	24.50	32					
20			7-16									31.83	30.87	36					
24			7-20									38.20	37.24	45					
30			7-20									39.79	38.83	45					
32			10-26									47.75	46.79	52					
36		10-28	50.93					49.97	55										
40		10-30	57.30					56.34	61										
40		10-38	63.66					62.70	67										

Part Number Example
FTP_A20S5M - A - W80 - P16

Part Number Alterations
FTP_A20S5M - A - W80 - P16 - KC90-WMC40-WA20

Alterations	Set Screw Angle	Flange Not Swaged	Flange Swaged on One Side	Flange Cut	Tapped Hole
Code	KC90	NFC	RFC	FC	WMC
Spec.	Changes an angle of set screw to 90°. The set screw hole is set at around 90° in order to avoid peaks.	Flange is not installed. (Flange included)	RFC	Lowers flange by cutting. FC: 0.5 mm Increment No surface treatment applied on flange circumference.	Adds a tapped hole. WMC=M+3 WA=M/2+3 WMC+WA=M-(M/2+3) Ordering Code: WMC20-WA5

Timing Pulley Stock

MXL, XL, S2M, S3M, S5M Type

Timing Pulley Stock – MXL, XL, S2M, S3M, S5M Type

RoHS10

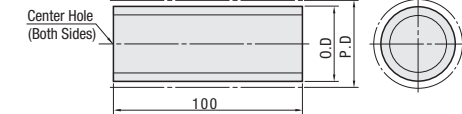

BMXL (MXL)

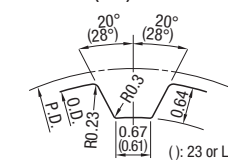

BXL (XL)

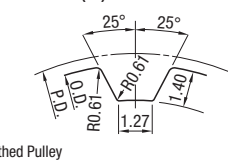

BS3M (S3M)

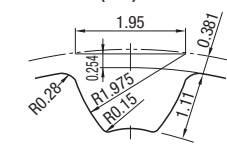

BS2M (S2M)

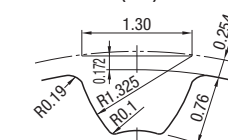

BS5M (S5M)

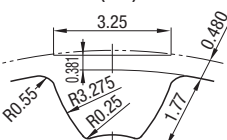

(): 23 or Less Toothed Pulley

Tooth groove dimensions slightly change according to number of teeth.

Material: Aluminum Alloy 2000 series

Part Number	Type	Teeth	P.D.	O.D.
11	7.11	6.61		
12	7.76	7.25		
13	8.41	7.90		
14	9.06	8.55		
15	9.70	9.19		
16	10.35	9.84		
17	11.00	10.49		
18	11.64	11.14		
19	12.29	11.78		
20	12.94	12.43		
21	13.58	13.07		
22	14.23	13.72		
23	14.88	14.37		
24	15.52	15.02		
25	16.17	15.66		
26	16.82	16.31		
27	17.46	16.96		
28	18.11	17.60		
30	19.40	18.90		