



Precision Rollers

■ **Features:** This roller has tight O.D. and Geometrical Tolerances. Use in carriers that require accuracy.

■ **With Bearings**



RoHS10

Type	Material	Surface Treatment	O.D. Tolerance	Run-out		Perpendicularity		Circularity
				100-500mm	600-700mm	100-500mm	600-700mm	
RORSPM	1045 Carbon Steel	Electroless Nickel Plating	h7	5/100	0.1	5/100	0.1	5/100
RORSPA	Aluminum Alloy	Clear Anodize						

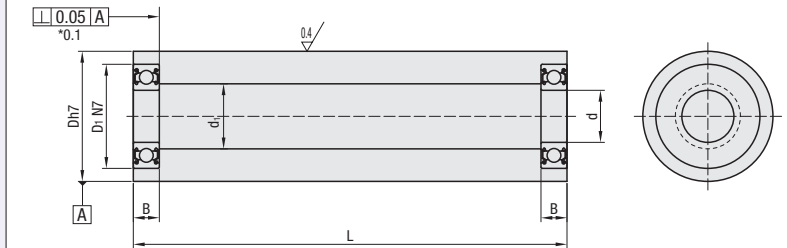

* Perpendicularity of L dimension 600 and 700 is 0.1.

Part Number	TYPE	D	d Tolerance	L Selection		Bearing Used	d1		D1	B
				1045 Carbon Steel	Aluminum		1045 Carbon Steel	Aluminum Alloy		
RORSPM RORSPA	30	0 -0.021	8	100	B608ZZ	15.8	15	22	7	
			10					22	6	
			12					24	6	
			10					26	8	
			12					28	8	
			15					28	7	
	40	0 -0.025	20	100	B600ZZ	21	22	32	7	
			12					37	12	
			15					35	11	
			20					37	9	
			25					42	9	
			15					42	9	
	50	0 -0.025	20	100	B6301ZZ	30	27	42	13	
			15					37	9	
			20					37	9	
			25					42	9	
			15					42	9	
			20					47	9	
	60	0 -0.030	25	100	B620ZZ	35	32	62	17	
			30					62	16	
			25					62	16	
			30					62	14	
			35							
			35							
80	0 -0.030	25	100	B6900ZZ	49	41				
		30								
		30								
		30								
		30								
		35								

Ordering Example: Part Number - d - L
RORSPM50 - 12 - L300

Days to Ship [Configure Online](#)

Price [Configure Online](#)

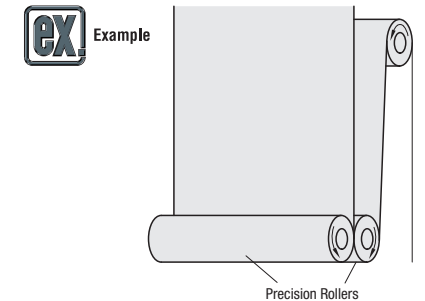

■ **1045 Carbon Steel**

D	Unit Price					
	L100	L150	L200	L300	L400	L500
30						
40						
50						
60						
80						

■ **Aluminum**

D	Unit Price						
	L100	L150	L200	L300	L400	L500	L700
30							
40							
50							
60							
80							

Alterations Part Number - d - L(LC)
RORSPA30 - 10 - LC413

Alterations	L Dimension
Spec.	<p>Ordering Code LC151(Change L to LC) LC=1mm Increment * 1045 Carbon Steel, Aluminum Ø30, 40 50≤LC≤490 * Aluminum Ø50, 60, 80 50≤LC≤690</p>
Code	LC