



Slit Couplings

Extra Super Duralumin - Clamping Long

For Servo Motors

■ **Features:** Long slit coupling for Servo Motors.

■ **For Servo Motors**

CPLCX (Clamping)

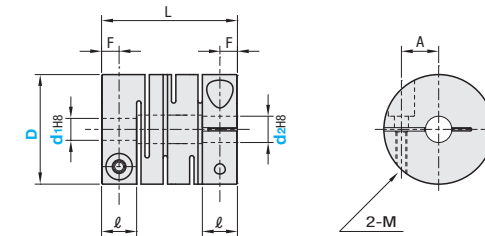

⚠ Misalignment values are guaranteed only when ONE type of misalignments is occurring, but when multiple misalignments are occurring simultaneously, the allowable maximum value of each will be reduced to 1/2.
 ⚠ Tolerances for d1 and d2 are values before slits are machined.
 ⚠ For selection criteria and alignment procedures, see **EP P.1061**.

M	Material	S	Surface Treatment	A	Accessories
	Extra Super Duralumin		Clear Anodize		Hex Socket Head Cap Screw

Part Number		d1	d2			L	ℓ	M (Coarse)	A	F	Unit Price	
Type	D											
Clamping CPLCX	16	5	5	6		23	6.5	M2.5	5	3.25		
		6		6								
	20	5	6	6.35	8	26	7.5	M2.5	6.5	3.75		
		6	6	6.35	8							
		6.35		8								
	25	5	6	8	10	31	8.5	M3	9	4.2		
		6	6	8	10							
		6.35		8	10							
		8		8	10							
	32	8	8	10	12	41	12	M4	11	6		
		10		10	12							14
				10	12							14
12			12	14								

Part Number	Allowable Torque (N·m)	Angular Misalignment (°)	Lateral Misalignment (mm)	Static Torsional Spring Constant (N·m/rad)	Max. Rotational Speed (r/min)	Moment of Inertia (kg·m ²)	Allowable Axial Misalignment (mm)	Screw Tightening Torque (N·m)	Mass (g)	
CPLCX	0.5	1	0.05	96	39000	3.7x10 ⁻⁷	±0.3	1.0	10.1	
	1		0.10	204	31000	10.0x10 ⁻⁷	±0.3	1.0	17.6	
	2				456	25000	2.9x10 ⁻⁶	±0.4	1.5	30.8
	4		0.15	600	19000	10.7x10 ⁻⁶	±0.4	2.5	70.4	

◆ **Features of CPLCX**
 High torsional rigidity, large misalignment tolerances.

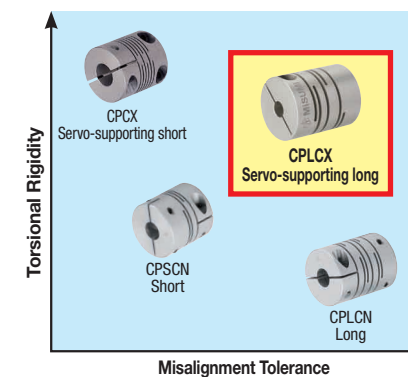

Suitable for responsive servo motor applications.

Ordering Example: Part Number **CPLCX20** - Shaft Bore Dia. d1 **5** - Shaft Bore Dia. d2 **6**

Days to Ship [Configure Online](#)

Price [Configure Online](#)