

# Post Clamps

Equal/Unequal Dia., Perpendicular Configuration, Hole Pitch Selectable



# Height Adjusting Spacer Clamp

Feature: Selectable shaft pitch between two posts for stands.

Equal Dia., Perpendicular Configuration, Hole Pitch Selectable

Type	Material	Surface Treatment	Accessories
Equal Dia., Perpendicular Configuration KMKC	1018 Carbon Steel	Black Oxide	Hex Socket Head Cap Screw
Unequal Dia., Perpendicular Configuration MMKC	Carbon Steel	Electroless Nickel Plating	Hex Socket Head Cap Screw (Stainless Steel)
AMKC	6063 Aluminum Alloy	Black Anodize	Hex Socket Head Cap Screw
SMKC	304 Stainless Steel	-	Hex Socket Head Cap Screw (Stainless Steel)

CB screws are included with the black oxide and black anodized products, and SCB screws are included with the other products.

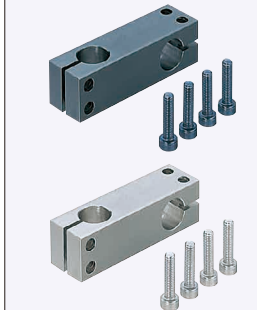

Unequal Dia., Perpendicular configuration, Hole Pitch Selectable

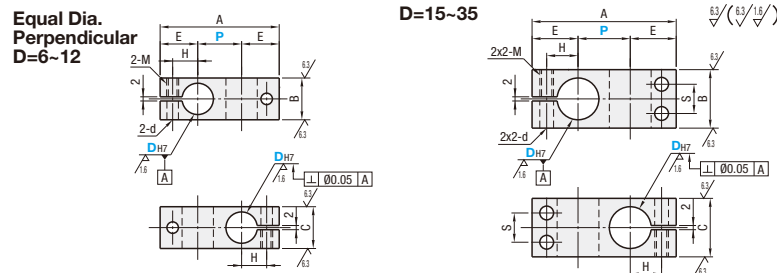
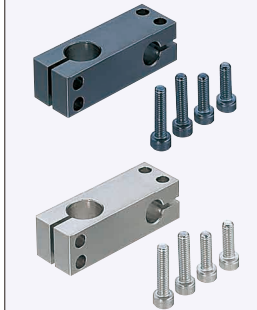

P Dimension Tolerance: JIS B 0405 Medium Class (See P.1992)

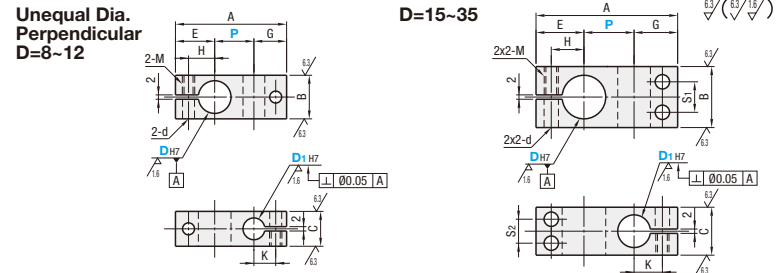

P Dimension Tolerance: JIS B 0405 Medium Class (See P.1992)

Equal Dia., Perpendicular, Hole Pitch Selectable

Type	Part Number	D <sub>H7</sub>	P										A	B	C	E	H	S	M	d
			10	15	20	25	30	40	50	75	100	150								
KMKC MMKC AMKC SMKC	6	+0.012 0	10	15	20							A=P+(2xE)	10	10	12	7	-	M4	4.5	
	8	+0.015 0	10	15	20	25							12	12	14	8	-			
	10	+0.018 0	15	20	25	30						16	16	15	9	-	M5	5.5		
	12	+0.018 0	20	25	30	40						22	22	18	12	11				
	15	+0.021 0	25	30	40	50						28	28	22	15	14		M6	6.6	
	20	+0.021 0	30	40	50	75						32	32	25	18	16				
	25	+0.021 0	40	50	75							40	40	29	21	20		M8	9	
	30	+0.025 0	50	75	100	150						45	45	32	24	24				
	35	+0.025 0																		

For the available sizes, refer to the price list.  
The tolerance and perpendicularity of D<sub>H7</sub> is before slitting.  
For mating, g6, f8 shaft tolerances are recommended. Use of a long wrench is recommended for fastening.

Unequal Dia. Perpendicular Pitch Selectable

Type	Part Number	D <sub>H7</sub>	D <sub>H17</sub>	P										A	B	C	E	G	H	K	S <sub>1</sub>	S <sub>2</sub>	M	d
				10	15	20	25	30	40	50	75	100	150											
KMKD MMKD AMKD SMKD	8	+0.015 0	6	10	15	20						A=P+E+G	12	9	13	12	8	7	-	-	M4	4.5		
	10	+0.015 0	8	10	15	20	25						16	12	15	14	9	8	-	-				
	12	+0.018 0	10	15	20	25	30					16	16	16	15	10	9	-	-	M5	5.5			
	15	+0.018 0	15	20	25	30	40					22	18	18	15	12	10	11	9					
	20	+0.021 0	20	25	30	40	50					28	22	22	20	15	13	14	11		M6	6.6		
	25	+0.021 0	25	30	40	50	75					32	25	25	20	18	13	16	14					
	30	+0.021 0	30	40	50	75						40	30	29	24	21	16	20	15					
	35	+0.025 0	35	50	75	100	150					45	35	32	27	24	19	24	20		M8	9		

D Dimension for SMKD is available up to 30. D Dimension 8 is not available for AMKD and SMKD.  
The tolerance and perpendicularity of D<sub>H7</sub>, D<sub>H17</sub> are the tolerances before slitting.  
For mating, g6, f8 shaft tolerances are recommended. Use of a long wrench is recommended for fastening.

Ordering Example: Part Number: KMKC10, MMKD20, D1: 10, P: 20, 30. Price: Configure Online. Days to Ship: Configure Online.

D	Unit Price							
	Equal Dia., Perpendicular Configuration				Unequal Dia., Perpendicular Configuration			
	KMKC	MMKC	AMKC	SMKC	KMKD	MMKD	AMKD	SMKD
6								
8								
10								
12								
15								
20								
25								
30								
35								

D	Included Screw	
	Equal Dia., Perpendicular Configuration	Unequal Dia., Perpendicular Configuration
6	M4-10, 2 pcs.	-
8	M5-12, 2 pcs.	M4-8/M4-12, 1 pc. each
10	M5-15, 2 pcs.	M5-12/M5-10, 1 pc. each
12	M5-15, 2 pcs.	M5-20, 2 pcs.
15	M5-20, 4 pcs.	M5-20/M5-15, 2 pcs. each
20	M6-25, 4 pcs.	M6-25/M6-20, 2 pcs. each
25	M6-30, 4 pcs.	M6-30/M6-25, 2 pcs. each
30	M8-35, 4 pcs.	M8-35/M8-30, 2 pcs. each
35	M8-40, 4 pcs.	M8-40/M8-35, 2 pcs. each

Feature: By mounting below the clamp, fine manual adjustments are possible (Max. stroke 5mm recommended). Best suited for adjustments of cameras and sensors.

With Double Nuts



Without Double Nuts



Type	Material	Surface Treatment	Accessories
With Double Nuts CLAWM	1045 Carbon Steel	Electroless Nickel Plating	Hex Socket Head Cap Screw (Stainless Steel)
Without Double Nuts CLAJM	1215 Carbon Steel Equivalent	Black Oxide	Hex Socket Head Cap Screw

CB screws and SCB screws are included with the black oxide products and electroless nickel plating products, respectively.

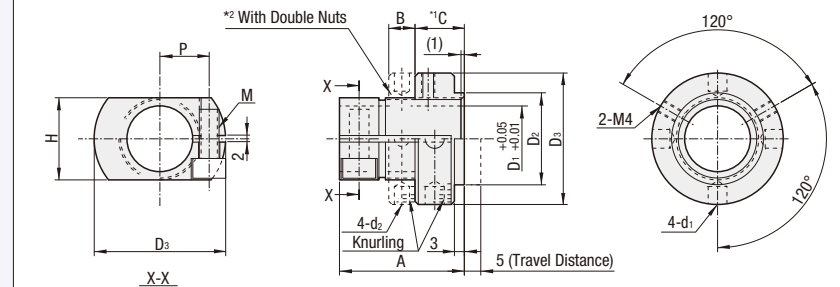

\*1 The drawing shows the nut protruding 1mm from the sleeve (Part A).  
\*2 When the type without the Double Nuts is selected, double nuts will not be included. Only Part A and B are included.  
See the instruction below for Part A, B, and C.

Part Number	Type	D <sub>1</sub>	A	B	C	H	P	D <sub>2</sub>	D <sub>3</sub>	M	d <sub>1</sub>	d <sub>2</sub>	Travel Distance	Included Screw	Unit Price				
															With Double Nuts	Without Double Nuts	With Double Nuts	Without Double Nuts	
CLAWM CLAWB	CLAJM CLAJB	10	+0.05 +0.01	35	6	11	14	9.5	16	28	4	4.6	3.4	5	M4-8, 1pc.				
		12		36		12	16	10	18	30					M4-10, 1pc.				
		15		38		13	20	12	22	35					5	M5-12, 1pc.			
		20		43		15	25	15	28	40					6	M6-15, 1pc.			
		25		45		17	30	17	34	45					6	M6-18, 1pc.			
		30		51		19	36	21	40	55					8	M8-20, 1pc.			

D<sub>1</sub> tolerance is before the slit machining. Set screw is not included.  
Recommended tolerances of fitting shafts for D<sub>1</sub>: g6, f8.

Ordering Example: Part Number: CLAJM20, Days to Ship: Configure Online, Price: Configure Online.

How to Use (Adjustable range is 5mm)

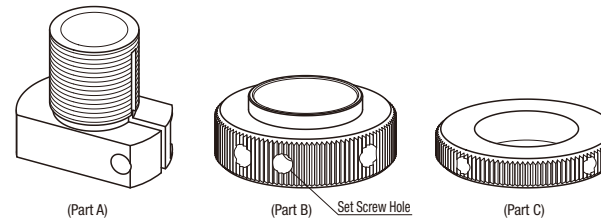

- Mount Part A below a post clamp to be adjustable.
- Install Part B on the threaded part of Part A.
- After mounting the post clamp, position Part B with a hand or HEX wrench, adjust the post clamp to a desired position by utilizing the thread pitch. (Stroke 5mm)
- Secure the post clamp by tightening the screw. (The Set Screw can be used to temporarily fix the position before the final step ④.)

<Double Nut Type>  
Mount Part C on thread part of Part A after the step ①.  
Using the Part C, Double Nut mounting is facilitated.  
Can be used as a stopper when the post clamp is loosened.

Example: "Fine vertical adjustments are needed." "Economical clamping adjustment mechanism is needed." Best suited for these customer needs.

Suitable for 1~2mm adjustments of cameras, etc.

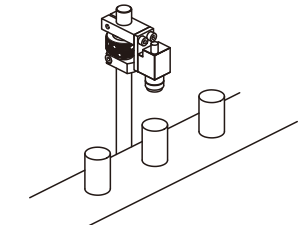

A wrench can be used for heavier objects.

