

Silicon Rubber, Urethane Molded Bearings

Flat Type



Silicon Rubber, Urethane Molded Bearings

R Type / Hubbed Type



Type Bearing	Material	Hardness	Color
Steel (S2100 Bearing Steel)	Stainless Steel (440C Stainless Steel)		
UMBBK UMSBK	Urethane	Shore A95	Black
UMBBKW UMSBKW		Shore A90	White
UMBB UMSB		Shore A70	Black
UMBW UMSW		Shore A70	White
UMBG UMSG		Shore A70	Black
UMBGW UMSGW		Shore A70	White
UMBL	Antistatic Urethane	Shore A90	Black
UMBLW		Shore A90	White
UMBD	Silicon Rubber	Shore A70	Gray
SUMBB			Light Gray
SUMSB			

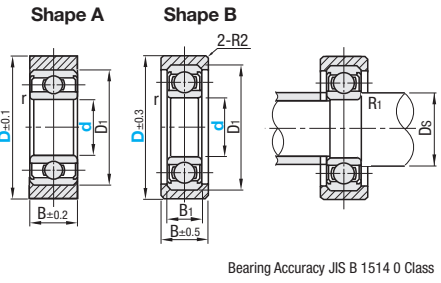

Bearing Accuracy JIS B 1514 0 Class

Shape A

Part Number	Type	d	D	Allowable Load N (kgf)					B	D1	r (min.)	Relative Dimension			Bearing Used
				Urethane Shore A95	Urethane Shore A90	Urethane Shore A70	Urethane Shore A50	Silicon Shore A70				Ds (min.)	Rs (min.)	R1 (max.)	
Urethane	UMBBK UMSBK	3	10	38(3.8)	28(2.8)	9(0.9)	4(0.4)	7(0.7)	3	7	0.1	3.9	4.1	0.1	W683ZZA
	UMBBKW UMSBKW		12	53(5.4)	34(3.5)	10(1)	6(0.6)	9.8(1)							W684AX50ZZ
	UMBB UMSB		13	66(6.7)	44(4.5)	13(1.3)	7(0.7)	13(1.3)	4	9	0.15	5	5.2		624ZZ
	UMBW UMSW		16	79(8.1)	59(6)	16(1.6)	6(0.6)	18(1.8)							WBC5-13ZZ
	UMBG UMSG		20	102(10.4)	78(8)	20(2)	9(0.9)	24(2.4)	5	16	0.3	7	7.6	0.3	625ZZ
	UMBGW UMSGW		20	114(11.7)		23(2.3)	15(1.5)			15	0.2	7.6	7.8	0.2	696ZZ
	UMBL		28	218(22.2)	157(16)	44(4.5)	39(4)	47(4.8)	6	19	0.2	8	9.5		626ZZ
	UMBLW		30A	208(21.2)		42(4.3)	35(3.6)			7	0.3	10	12.2	0.3	608ZZ
Antistatic Urethane	UMBD		40A	-	176(18)	81(8.3)	65(6.7)	53(5.4)	8	26	0.3	12	13.5		6000ZZ
			40A	-	274(28)	136(13.9)	93(9.5)	82(8.4)	9	30	0.6	14	16	0.6	6200ZZ
Silicon Rubber	SUMBB *SUMSB		15	40A	-	122(12.4)	96(9.9)	103(10.5)	11	35	0.6	19	20	0.6	6202ZZ
			20	45A	-	109(11.1)	102(10.5)		9	37	0.3	22	24	0.3	6904ZZ
			25	55A	-	490(50)	225(22.9)	176(18.1)	14	47	1	25	28		6204ZZ
				65A	-	750(70)	333(34)	250(25.8)	15	52	1	30	32	1	6205ZZ

Only d4-8 are available for * marked types. Allowable load is for reference.

Shape B

Part Number	Type	d	D	Allowable Load N (kgf)					B	D1	B1	r (min.)	Relative Dimension			Bearing Used	
				Urethane Shore A95	Urethane Shore A90	Urethane Shore A70	Urethane Shore A50	Silicon Shore A70					Ds (min.)	Rs (min.)	R1 (max.)		
Urethane	UMBBK UMSBK	8	30	248(25.3)	176(18)	81(8.3)	65(6.7)	53(5.4)	11	22	7	0.3	10	12.2	0.3	608ZZ	
	UMBBKW UMSBKW		10	30	201(20.5)	136(13.9)	93(9.5)	82(8.4)								6000ZZ	
	UMBB UMSB		10	40	412(42)	274(18)	122(12.4)	96(9.9)	82(8.4)	12	32	0.3	17	19	0.3	6002ZZ	
	UMBW UMSW		15	40	369(37.6)		109(11.1)	102(10.5)	103(10.5)	15	35	11	0.6	19	20	0.6	6202ZZ
	UMBG UMSG		45	534(54.5)	343(35)	109(11.1)	102(10.5)	103(10.5)	12	37	9	0.3	22	24	0.3	6904ZZ	
	UMBGW UMSGW		20	45	391(39.9)		130(13.3)	98(10.1)	103(10.5)	12	37	9	0.3	22	24	0.3	6904ZZ
	UMBL		55	674(68.7)	490(50)	225(22.9)	176(18.1)	147(15)	18	47	14	1	25	28		6204ZZ	
	UMBLW		65	999(101.9)	750(70)	333(34)	250(25.8)	226(23)	19	52	15	1	30	32	1	6205ZZ	

Allowable load is for reference.

Unit Price

d	D	Steel Bearing										Stainless Steel Bearing				
		Urethane					Silicon					Urethane		Silicon		
		Shore A95	Shore A90	Shore A70	Shore A50	Shore A90	Shore A70	Shore A95	Shore A90	Shore A70	Shore A50	Shore A95	Shore A90	Shore A70	Shore A50	
3	10	UMBBK UMSBK	UMBBKW UMSBKW	UMBB UMSB	UMBW UMSW	UMBG UMSG	UMBGW UMSGW	UMBL	UMBLW	UMBD	SUMBB	UMSBK UMSBKW	UMSB	UMSW	UMSG UMSGW	SUMSB
3	12															
3	13															
4	16															
4	16															
5	20															
5	20															
6	28															
6	28															
8	30															
8	30A															
10	30															
10	40															
10	30A															
10	40A															
15	40															
15	45															
15	40A															
15	45A															
20	45															
20	55															
20	45A															
20	55A															
25	65															
25	65A															



Urethane (white) may turn yellow over time.

Type Bearing	Material	Hardness	Color
Steel (S2100 Bearing Steel)	Stainless Steel (440C Stainless Steel)		
UMBBR	Urethane	Shore A90	Black
UMBSR		Shore A90	White
UMBWR	Silicon Rubber	Shore A70	Light Gray
UMBSWR			
SUMBBR			

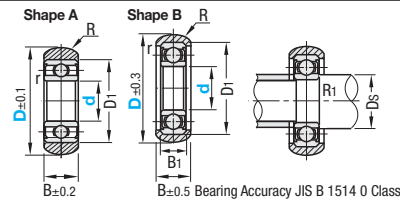

Bearing Accuracy JIS B 1514 0 Class

Shape A

Part Number	Type	d	D	Allowable Load N (kgf)		B	D1	r (min.)	R	Relative Dimension			Bearing Used
				Urethane Shore A90	Silicon Shore A70					Ds (min.)	Rs (max.)	R1 (max.)	
Urethane	UMBBR *UMBSR	3	12	34(3.5)	9.8 (1)	3	7	0.1		3.9	4.1	0.1	W683ZZA
	UMBWR *UMSWR		13	44(4.5)	13 (1.3)	4	9	0.15		5	5.2		W684AX50ZZ
			16	59(6)	18 (1.8)				5	6.6	6.2	0.2	624ZZ
			16				13	0.2		6.6	6.9		WBC5-13ZZ
Silicon Rubber	SUMBBR		20	78(8)	24 (2.4)					7	7.6	0.3	625ZZ
			20				16	0.3		7.6	7.8	0.2	696ZZ
			20	157(16)	47 (4.8)		6	19	0.3	8	9.5		626ZZ
			28	176(18)			7	22		10	12.2	0.3	608ZZ

Only d4-8 are available for * marked types. Allowable load is for reference.

Shape B

Part Number	Type	d	D	Allowable Load N (kgf)		B	D1	B1	r (min.)	R	Relative Dimension			Bearing Used		
				Urethane Shore A90	Silicon Shore A70						Ds (min.)	Rs (max.)	R1 (max.)			
Urethane	UMBBR UMSBR	8	30	176(18)	53(5.4)		22	7	0.3		10	12.2	0.3	608ZZ		
	UMBWR UMSWR		10	30	274(18)	82(8.4)	11	26	8	0.3	12	13.5		6000ZZ		
			40					30	9	0.6	14	16	0.6	6200ZZ		
			40					12	32	0.3	17	19	0.3	6002ZZ		
Silicon Rubber	SUMBBR		15	45	343(35)	103(10.5)		15	35	11	0.6	19	20	0.6	6202ZZ	
			20	45	490(50)	147(15)		12	37	9	0.3	22	24	0.3	6904ZZ	
			25	65	750(70)	226(23)		19	52	15	1	20	30	32	1	6205ZZ

Allowable load is for reference.



Type	Type Bearing	Material	Hardness	Hub Material	Color
UMBBKBOS	Flat	Steel (S2100 Bearing Steel)	Urethane	A95	SUM (Electroless Nickel Plating)
UMBBBOS				A90	Black
UMBBGOS				A70	
UMBLBOS				A50	
UMBBBOSR	R Type			A90	

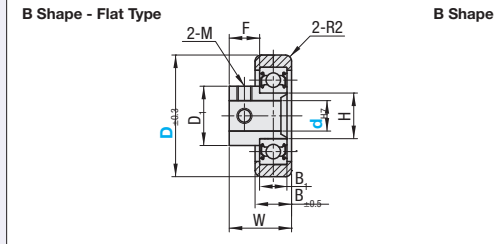

Bearing Accuracy JIS B 1514 0 Class

Hubbed Type

Part Number	Type	d	D	Allowable Load N (kgf)				W	B	D1	B1	H	F	M	R	Bearing Used
				Shore A95	Shore A90	Shore A70	Shore A50									
UMBBKBOS		6	30	201(20.5)	176(18)	94(9.6)	51(5.2)	19.5	11	13	8	10	4	15	4	6000ZZ
UMBBBOS		8	40	369(37.6)	274(18)	122(12.4)	96(9.9)	20.5	12	19	9	15	10	15	4	6002ZZ
UMBBGOS		10	40													
UMBLBOS		15	45	391(39.9)	343(35)	130(13.3)	98(10.1)	22.5	12	23	10	20	12	5	5	6904ZZ
UMBBBOSR		20	65	999(101.9)	750(70)	333(34)	250(25.8)									