

Clamping Links

-For Rod End Bearing-



Material	Surface Treatment	Included Hardware S.H.C.S. (1 pcs): Material	Type
1045 Steel	Black Oxide	Steel	U-CLKB
	Electroless Nickel Plating		U-CLKM
304 Stainless Steel	-	304 Stainless Steel	U-CLKS

Material Characteristics P.628, 629

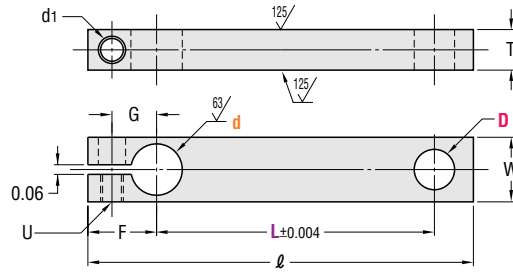

General Tolerance
Unless otherwise specified use the table below.

From	To	Tolerance
0.000	5.000	±0.01
5.001	16.000	±0.02
16.001	60.000	±0.05

Thread or hole location tolerance: ±0.005' non-cumulative.

Surface Roughness: Unless otherwise specified 250

Type	Part No.			D				L
	Callout	Nominal	Tolerance	Selection (Callout)				
U-CLKB U-CLKM U-CLKS	0.38	3/8	0.3756 0.3750	0.25	0.38			1.250 ~ 6.000
	0.50	1/2	0.5007 0.5000	0.25	0.38	0.50		1.250 ~ 6.000
	0.63	5/8	0.6257 0.6250	0.25	0.38	0.50		1.250 ~ 6.000
	0.75	3/4	0.7508 0.7500		0.38	0.50	0.63	2.000 ~ 6.000
	1.00	1"	1.0008 1.0000		0.38	0.50	0.63	2.000 ~ 6.000

Order Example The part number consists only of the fields with blue characters. Please refer to the table below for technical information.

Part No. **D** - **L**
Type **d**
U-CLKB 0.63 - D 0.38 - L1.375

Technical Information

d	D	l	W	F	G	U(Thread)		d1	T	D	
						Size	Major Dia.			Callout	Actual
0.38	0.25	L + 0.875	0.500	0.563	0.375	1/4-20	0.250	0.281	0.375	0.25	0.250
0.38	0.38	L + 0.938	0.500	0.563	0.375	1/4-20	0.250	0.281	0.375	0.38	0.375
0.50	0.25	L + 1.000	0.750	0.750	0.500	1/4-20	0.250	0.281	0.500	0.50	0.500
0.50	0.38	L + 1.063	0.750	0.750	0.500	1/4-20	0.250	0.281	0.500	0.50	0.500
0.50	0.50	L + 1.125	0.750	0.750	0.500	1/4-20	0.250	0.281	0.500	0.50	0.500
0.63	0.25	L + 1.063	0.875	0.813	0.563	1/4-20	0.250	0.281	0.500	0.63	0.500
0.63	0.38	L + 1.125	0.875	0.813	0.563	1/4-20	0.250	0.281	0.500	0.63	0.500
0.63	0.50	L + 1.188	0.875	0.813	0.563	1/4-20	0.250	0.281	0.500	0.63	0.500
0.75	0.38	L + 1.188	1.000	0.875	0.625	5/16-18	0.313	0.344	0.625	0.75	0.625
0.75	0.50	L + 1.250	1.000	0.875	0.625	5/16-18	0.313	0.344	0.625	0.75	0.625
0.75	0.63	L + 1.313	1.000	0.875	0.625	5/16-18	0.313	0.344	0.625	0.75	0.625
1.00	0.38	L + 1.313	1.250	1.000	0.750	5/16-18	0.313	0.344	0.625	1.00	0.625
1.00	0.50	L + 1.375	1.250	1.000	0.750	5/16-18	0.313	0.344	0.625	1.00	0.625
1.00	0.63	L + 1.438	1.250	1.000	0.750	5/16-18	0.313	0.344	0.625	1.00	0.625

Related Components



Days to Ship **6** Days
Non-Returnable P.30

Price **Quantity Discount Rate**

Quantity	1-4	5-9	10-19	20~
Rate	-	5%	10%	15%

For larger quantity orders 'Days to Ship' may differ from published catalog term. P.29

d	\$Unit Price(Qty.1~4)					
	U-CLKB		U-CLKM		U-CLKS	
	Min.L~3.500	3.501~6.000	Min.L~3.500	3.501~6.000	Min.L~3.500	3.501~6.000
0.38	18.10	28.30	19.40	30.10	24.60	38.30
0.50	20.70	32.50	22.20	34.50	28.00	43.90
0.63	22.70	35.40	24.30	37.70	30.30	47.50
0.75	29.30	45.90	32.70	50.30	40.50	63.20
1.00	33.30	52.00	36.90	56.90	45.30	68.20

Optional Modifications Part No. **D** - **L** (Ordering Code)
Type **d**
U-CLKB 0.63 - D 0.38 - L1.375 - DKC
8 Days Non-Returnable P.30

Optional Modifications	Part d Reamer Machining (DH7, L Tolerance Modification)	C Chamfering																								
Ordering Code	DKC	CKC																								
Details	Adds reamer machining (DH7) on D part and changes L tolerance. Ordering Code DKC	Adds chamfering on d part. Ordering Code CKC																								
	<table border="1"> <thead> <tr> <th rowspan="2">Callout</th> <th colspan="2">D</th> <th rowspan="2">L Tolerance</th> </tr> <tr> <th>Callout</th> <th>Tolerance</th> </tr> </thead> <tbody> <tr> <td>0.25</td> <td>0.2506</td> <td>0.2500</td> <td rowspan="4">±0.002</td> </tr> <tr> <td>0.38</td> <td>0.3756</td> <td>0.3750</td> </tr> <tr> <td>0.50</td> <td>0.5007</td> <td>0.5000</td> </tr> <tr> <td>0.63</td> <td>0.6257</td> <td>0.6250</td> </tr> </tbody> </table>	Callout	D		L Tolerance	Callout	Tolerance	0.25	0.2506	0.2500	±0.002	0.38	0.3756	0.3750	0.50	0.5007	0.5000	0.63	0.6257	0.6250	<table border="1"> <thead> <tr> <th>D</th> <th>Chamfering</th> </tr> </thead> <tbody> <tr> <td>0.38~0.50</td> <td>0.08</td> </tr> <tr> <td>0.63~1.00</td> <td>0.12</td> </tr> </tbody> </table>	D	Chamfering	0.38~0.50	0.08	0.63~1.00
Callout	D		L Tolerance																							
	Callout	Tolerance																								
0.25	0.2506	0.2500	±0.002																							
0.38	0.3756	0.3750																								
0.50	0.5007	0.5000																								
0.63	0.6257	0.6250																								
D	Chamfering																									
0.38~0.50	0.08																									
0.63~1.00	0.12																									
Price Adder	2.00	3.00																								

When using Optional Modifications, add the "Price Adder" to the standard "Unit Price".

Example

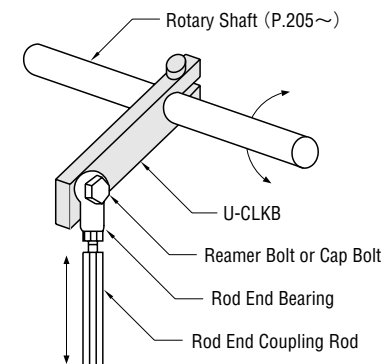

Express Options P.30

MISUMI
www.misumiusa.com E-mail: inquire@misumiusa.com

TEL.1-847-843-9105 FAX.1-847-843-9107 TOLL FREE TEL.1-800-681-7475 TOLL FREE FAX.1-800-681-7402

Contents

How to Use the Catalog

Linear Motion

Linear Shafts

Bushings

Shaft Supports
Shaft Collars

Linear Guides

Rotary Motion

Rotary Shafts

Bearings w/
Housings

Pulleys
Belts
Couplings

Locating Components

Locating Pins & Bushings

Locating Components

General Components

Pivot Pins
Floating Joints

Posts
Device Stands
Strut Clamps

Angle Plates
Gussets
Welded Stands

Washers
Collars

Manifolds

Urethanes
Rubbers

Plates

Misc.

Technical Data

Business Information

Index