

Flanged Bushings (DryLin® R Liner) –Center Flange–



The Flanged Bushings are available in 6061-T6 aluminum and lined with Ibus DryLin® liner. They are designed to work with all MISUMI linear shafts including chrome plated shafts. The extended profile allows better system rigidity. Please refer to P.649 for more information on DryLin® R Liners. The plain bearings can be used in linear and oscillating applications.



Housing		Liner	Flange	Type
Material	Surface Treatment			
6061 - T6 Aluminum	Clear Anodizing	DryLin® R (see P.649)	Round	U-JUCR
			Square	U-JUCS

Material Characteristics P.629

For linear motion only.

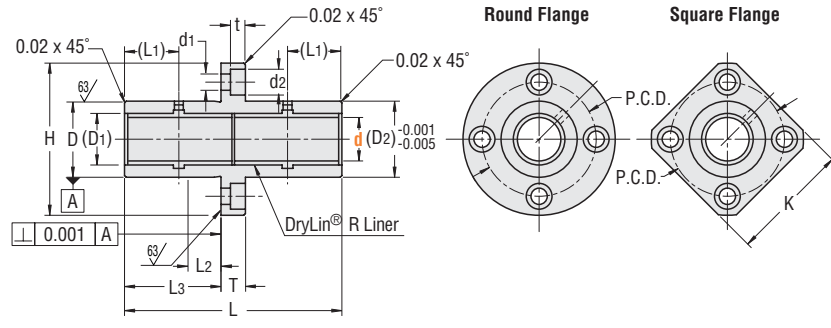

General Tolerance
Unless otherwise specified use the table below.

From	To	Tolerance
0.000	5.000	+0.01
5.001	16.000	+0.02
16.001	60.000	+0.05

Thread or hole location tolerance: +0.005* non-cumulative.

Surface Roughness: Unless otherwise specified

Type	Part No.			D		L2 (Precise D Section *)	L		\$ Unit Price (Qty. 1-9)	
	Callout	Nominal	Tolerance	Nominal	Tolerance		Length	Tol.	U-JUCR	U-JUCS
U-JUCR U-JUCS	0.38	3/8	0.3766 0.3774	5/8	0.6250 0.6243	0.250	1.781	±0.005	31.40	34.90
	0.50	1/2	0.5016 0.5024	7/8	0.8750 0.8742	0.250	2.500	±0.010	34.00	38.40
	0.63	5/8	0.6266 0.6274	1-1/8	1.1250 1.1242	0.250	3.000	±0.010	40.30	46.20
	0.75	3/4	0.7516 0.7524	1-1/4	1.2500 1.2490	0.313	3.250	±0.012	53.60	57.50
	1.00	1"	1.0016 1.0024	1-9/16	1.5625 1.5615	0.375	4.500	±0.012	68.40	72.60

Order Example

The part number consists only of the fields with blue characters.

Please refer to the table below for technical information.
* The rest of D area is undersized.

Part No.

Type d

U-JUCR 0.63

Technical Information

d	L3	H	T	d1	d2	t	Compatible Bolt	P.C.D.	K	(D1)	(D2)	(L1)	Part No. of Liner (P.111)
0.38	0.750	1.50	0.281	0.188	0.297	0.172	#8	1.063	1.250	0.4684	0.625	0.438	U-MJUI06
0.50	1.109	1.75	0.281	0.188	0.297	0.172	#8	1.313	1.375	0.5934	0.875	0.625	U-MJUI08
0.63	1.359	2.00	0.281	0.188	0.297	0.172	#8	1.563	1.500	0.7184	1.125	0.750	U-MJUI10
0.75	1.453	2.19	0.344	0.219	0.344	0.203	#10	1.719	1.688	0.8747	1.250	0.813	U-MJUI12
1.00	2.078	2.50	0.344	0.219	0.344	0.203	#10	2.031	2.000	1.1247	1.563	1.125	U-MJUI16

Days to Ship **1** Day

Quantity Discount Rate

Quantity	1-9	10-19	20-49	50~
Rate	—	2%	3%	5%

For larger quantity orders "Days to Ship" may differ from published catalog term. P.29

Related Components

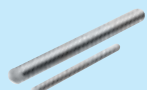

Linear Shafts P.39



Housing		Liner	Flange	Type
Material	Surface Treatment			
6061 - T6 Aluminum	Clear Anodizing	DryLin® R (see P.649)	Compact	U-JUCC

Material Characteristics P.629

For linear motion only.

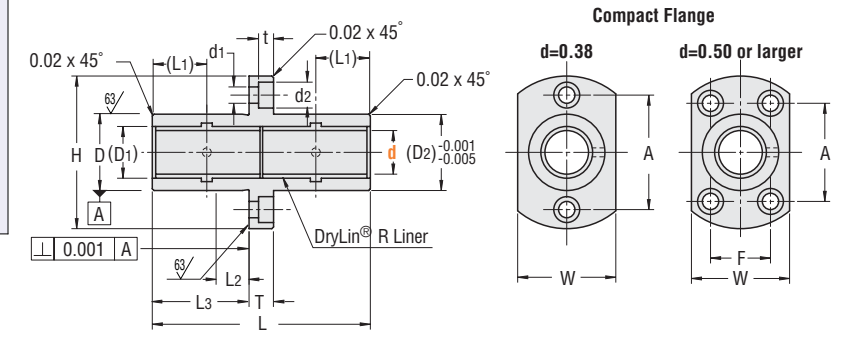

General Tolerance
Unless otherwise specified use the table below.

From	To	Tolerance
0.000	5.000	+0.01
5.001	16.000	+0.02
16.001	60.000	+0.05

Thread or hole location tolerance: +0.005* non-cumulative.

Surface Roughness: Unless otherwise specified

Type	Part No.			D		L2 (Precise D Section *)	L		\$ Unit Price (Qty. 1-9)	
	Callout	Nominal	Tolerance	Nominal	Tolerance		Length	Tol.	U-JUCC	
U-JUCC	0.38	3/8	0.3766 0.3774	5/8	0.6250 0.6243	0.250	1.781	±0.005	33.40	
	0.50	1/2	0.5016 0.5024	7/8	0.8750 0.8742	0.250	2.500	±0.010	36.60	
	0.63	5/8	0.6266 0.6274	1-1/8	1.1250 1.1242	0.250	3.000	±0.010	44.80	
	0.75	3/4	0.7516 0.7524	1-1/4	1.2500 1.2490	0.313	3.250	±0.012	55.80	
	1.00	1"	1.0016 1.0024	1-9/16	1.5625 1.5615	0.375	4.500	±0.012	71.20	

Order Example

The part number consists only of the fields with blue characters.

Please refer to the table below for technical information.
* The rest of D area is undersized.

Part No.

Type d

U-JUCC 0.38

Technical Information

d	L3	H	T	d1	d2	t	Compatible Bolt	P.C.D.	W	F	A	(D1)	(D2)	(L1)	Part No. of Liner (P.111)
0.38	0.750	1.50	0.281	0.188	0.297	0.172	#8	1.063	0.875	-	1.063	0.4684	0.625	0.438	U-MJUI06
0.50	1.109	1.75	0.281	0.188	0.297	0.172	#8	1.313	1.125	0.688	1.125	0.5934	0.875	0.625	U-MJUI08
0.63	1.359	2.00	0.281	0.188	0.297	0.172	#8	1.563	1.375	0.938	1.250	0.7184	1.125	0.750	U-MJUI10
0.75	1.453	2.19	0.344	0.219	0.344	0.203	#10	1.719	1.500	1.000	1.375	0.8747	1.250	0.813	U-MJUI12
1.00	2.078	2.50	0.344	0.219	0.344	0.203	#10	2.031	1.875	1.313	1.563	1.1247	1.563	1.125	U-MJUI16

Days to Ship **1** Day

Quantity Discount Rate

Quantity	1-9	10-19	20-49	50~
Rate	—	2%	3%	5%

For larger quantity orders "Days to Ship" may differ from published catalog term. P.29

Express Options P.30

MISUMI
www.misumiusa.com E-mail: inquire@misumiusa.com

TEL.1-847-843-9105 FAX.1-847-843-9107 TOLL FREE TEL.1-800-681-7475 TOLL FREE FAX.1-800-681-7402

Contents

How to Use the Catalog

Linear Motion

Linear Shafts

Bushings

Shaft Supports

Shaft Collars

Linear Guides

Rotary Motion

Rotary Shafts

Bearings w/ Housings

Pulleys Belts Couplings

Locating Components

Locating Pins & Bushings

Locating Components

General Components

Pivot Pins Floating Joints

Posts Device Stands Strut Clamps

Angle Plates Gaskets Welded Stands

Washers Collars

Manifolds

Urethanes Rubbers

Plates

Misc.

Technical Data

Business Information

Index