

# MIL Socket Connector Cable

## ▼ MHJK, ZHHIFS, BLHIFS Series Product Page 704

Common for all core numbers

CN1 Pin No.	Wire Identification						CN2 Pin No.	CN1 Pin No.	Electric Wire Identification						CN2 Pin No.
	MHJK			ZHHIFS / BLHIFS					MHJK			ZHHIFS			
	Example: Pin No.4 White / Red 2			Example: Pin No.17 Gray / Black 2					Example: Pin No.4 White / Red 2			Example: Pin No.17 Gray / Black 2			
	<b>Pair No.</b>	<b>Cable Color</b>	<b>Line Color</b>	<b>Pair No.</b>	<b>Cable Color</b>	<b>Line Color</b>		<b>Pair No.</b>	<b>Cable Color</b>	<b>Line Color</b>	<b>Pair No.</b>	<b>Cable Color</b>	<b>Line Color</b>		
1	1 Pair	White	Black 1	1 Pair	Orange	Black 1	1	14 Pairs	Pink	Black 4	14 Pairs	Gray	Black 3	27	
2		White	Red 1		Orange	Red 1	2		Pink	Red 4		Gray	Red 3	28	
3	2 Pairs	White	Black 2	2 Pairs	Yellow	Black 1	3	15 Pairs	Black continuous	Black 2	15 Pairs	White	Black 3	29	
4		White	Red 2		Yellow	Red 1	4		Red continuous	Red 1		White	Red 3	30	
5	3 Pairs	White	Black 3	3 Pairs	Light Green	Black 1	5	16 Pairs	Gray	Black 1	16 Pairs	Orange	Black 4	31	
6		White	Red 3		Light Green	Red 1	6		Red 1	Red 1		Yellow	Red 4	32	
7	4 Pairs	White	Black 4	4 Pairs	Gray	Black 1	7	17 Pairs	Gray	Black 2	17 Pairs	Yellow	Black 4	33	
8		White	Red 4		Gray	Red 1	8		Red 2	Red 2		Light Green	Red 4	34	
9	5 Pairs	White	Black continuous	5 Pairs	White	Black 1	9	18 Pairs	Gray	Black 3	18 Pairs	Light Green	Black 4	35	
10		White	Red continuous		White	Red 1	10		Red 3	Red 3		Gray	Red 4	36	
11	6 Pairs	Yellow	Black 1	6 Pairs	Orange	Black 2	11	19 Pairs	Gray	Black 4	19 Pairs	Gray	Black 4	37	
12		Yellow	Red 1		Orange	Red 2	12		Red 4	Red 4		White	Black 4	38	
13	7 Pairs	Yellow	Black 2	7 Pairs	Yellow	Black 2	13	20 Pairs	Gray	Black continuous	20 Pairs	White	Black 4	39	
14		Yellow	Red 2		Yellow	Red 2	14		Red continuous	Red continuous		Orange	Black 4	40	
15	8 Pairs	Yellow	Black 3	8 Pairs	Light Green	Black 2	15	21 Pairs	Yellow	Black continuous	21 Pairs	Orange	Black continuous	41	
16		Yellow	Red 3		Light Green	Red 2	16		Red 3	Red continuous		Yellow	Black continuous	42	
17	9 Pairs	Yellow	Black 4	9 Pairs	Gray	Black 2	17	22 Pairs	Gray	Black 2	22 Pairs	Yellow	Black continuous	43	
18		Yellow	Red 4		Gray	Red 2	18		Red 2	Red continuous		Light Green	Black continuous	44	
19	10 Pairs	Yellow	Black continuous	10 Pairs	White	Black 2	19	23 Pairs	Gray	Black continuous	23 Pairs	Light Green	Black continuous	45	
20		Yellow	Red continuous		White	Red 2	20		Red 2	Red continuous		Gray	Black continuous	46	
21	11 Pairs	Pink	Black 1	11 Pairs	Orange	Black 3	21	24 Pairs	Gray	Black continuous	24 Pairs	White	Black continuous	47	
22		Pink	Red 1		Orange	Red 3	22		Red 2	Red continuous		Gray	Black continuous	48	
23	12 Pairs	Pink	Black 2	12 Pairs	Yellow	Black 3	23	25 Pairs	White	Black continuous	25 Pairs	White	Black continuous	49	
24		Pink	Red 2		Yellow	Red 3	24		Red 3	Red continuous		White	Black continuous	50	
25	13 Pairs	Pink	Black 3	13 Pairs	Light Green	Black 3	25		Light Green	Black 3		Shield	Shield	Terminal	
26		Pink	Red 3		Light Green	Red 3	26		Light Green	Red 3				Terminal	

MIL Female Connector Contact Arrangement Diagram

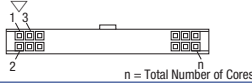

# FCN Connector Cable

## ▼ FCHSK, ZFCNA, BLFCN Series Product Page 725

40-core

CN1 Pin No.	Electric Wire Identification						CN2 Pin No.	CN1 Pin No.	Electric Wire Identification						CN2 Pin No.
	FCHSK			ZFCNA / BLFCN					FCHSK			ZFCNA / BLFCN			
	Example: Pin No.B7 Yellow / Red 2			Example: Pin No.B6 Orange / Red 2					Example: Pin No.B7 Yellow / Red 2			Example: Pin No.B6 Orange / Red 2			
	<b>Pair No.</b>	<b>Cable Color</b>	<b>Line Color</b>	<b>Pair No.</b>	<b>Cable Color</b>	<b>Line Color</b>		<b>Pair No.</b>	<b>Cable Color</b>	<b>Line Color</b>	<b>Pair No.</b>	<b>Cable Color</b>	<b>Line Color</b>		
A1	1 Pair	White	Black 1	1 Pair	Orange	Black 1	A1	11 Pairs	Pink	Black 1	11 Pairs	Orange	Black 3	A11	
B1		White	Red 1		Orange	Red 1	B1		Pink	Red 1		Orange	Red 3	B11	
A2	2 Pairs	White	Black 2	2 Pairs	Yellow	Black 1	A2	12 Pairs	Pink	Black 2	12 Pairs	Yellow	Black 3	A12	
B2		White	Red 2		Yellow	Red 1	B2		Pink	Red 2		Yellow	Red 3	B12	
A3	3 Pairs	White	Black 3	3 Pairs	Light Green	Black 1	A3	13 Pairs	Pink	Black 3	13 Pairs	Light Green	Black 3	A13	
B3		White	Red 3		Light Green	Red 1	B3		Pink	Red 3		Gray	Black 3	B13	
A4	4 Pairs	White	Black 4	4 Pairs	Gray	Black 1	A4	14 Pairs	Pink	Black 4	14 Pairs	Gray	Black 3	A14	
B4		White	Red 4		Gray	Red 1	B4		Pink	Red 4		Gray	Red 3	B14	
A5	5 Pairs	White	Black continuous	5 Pairs	White	Black 1	A5	15 Pairs	Pink	Black continuous	15 Pairs	White	Black 3	A15	
B5		White	Red continuous		White	Red 1	B5		Pink	Red continuous		White	Red 3	B15	
A6	6 Pairs	Yellow	Black 1	6 Pairs	Orange	Black 2	A6	16 Pairs	Gray	Black 1	16 Pairs	Orange	Black 4	A16	
B6		Yellow	Red 1		Orange	Red 2	B6		Gray	Red 1		Orange	Red 4	B16	
A7	7 Pairs	Yellow	Black 2	7 Pairs	Yellow	Black 2	A7	17 Pairs	Gray	Black 2	17 Pairs	Yellow	Black 4	A17	
B7		Yellow	Red 2		Yellow	Red 2	B7		Gray	Red 2		Yellow	Red 4	B17	
A8	8 Pairs	Yellow	Black 3	8 Pairs	Light Green	Black 2	A8	18 Pairs	Gray	Black 3	18 Pairs	Light Green	Black 4	A18	
B8		Yellow	Red 3		Light Green	Red 2	B8		Gray	Red 3		Light Green	Red 4	B18	
A9	9 Pairs	Yellow	Black 4	9 Pairs	Gray	Black 2	A9	19 Pairs	Gray	Black 4	19 Pairs	Gray	Black 4	A19	
B9		Yellow	Red 4		Gray	Red 2	B9		Gray	Red 4		Gray	Red 4	B19	
A10	10 Pairs	Yellow	Black continuous	10 Pairs	White	Black 2	A10	20 Pairs	Gray	Black continuous	20 Pairs	White	Black 4	A20	
B10		Yellow	Red continuous		White	Red 2	B10		Gray	Red continuous		White	Red 4	B20	

### Connector Specifications

Drawings (Unit: mm)

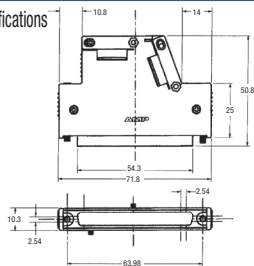

The hood of this product is found in the e-Catalog.

### Electrical Properties

Rated Voltage	250 VAC or less
Rated Current	3A or less / 1 Pole
Insulation Resistance	1,000 Ω or more
Withstand Voltage	500 VAC / 1 min
Operating Temperature Range	-25 °C ~ +85°C

### Mechanical Properties

Insertion Force Per Single Pole	12.5 kg or less
Extraction Force Per Single Pole	2.0kg or less
Vibration Resistance	No Instantaneous Interruption of 1 ms or more
Number of Insertions and Extractions	500 times

### Contact Arrangement Diagram

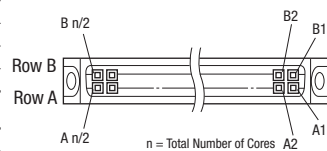

View of the socket (female) connector from the mating surface.